



**Chicago
Pneumatic**

IDEMCO

Mining & Construction



www.cp.com

Heavy Machinery Maintenance

Our History

Decades of innovation

- 1901** First single-valve pneumatic hammer
- 1904** First electric tools and railway speed recorder
- 1910** Quarry drills
- 1911** Engines for cars and trucks
- 1912** Simplate valve
- 1912** Two-cycle semi-diesel engine for compressors
- 1925** Rotary oil-well drilling equipment
- 1925** Engine manufacturing
- 1939** First impact wrench
- 1943** "Rosie the Riveter" appears in this "We Can Do It" image and on Norman Rockwell's famous Saturday Evening Post cover, holding a Chicago Pneumatic riveting hammer on her lap
- 1957** Portable broach puller, construction impact wrenches
- 1960's** Tools customized for Boeing 737 and 747, Lockheed L1011 and C5A, Douglas DC-10, new Concorde
- 1971** Crimpnut tool - a breakthrough in critical joints for vehicle assembly
- 1970's** Patented two-jaw clutch for impact wrenches
- 1981** CP341 pneudraulic riveter
- 1990** CP789H reversible drill, CP828H ratchet, CP854 angle grinders
- 90's** Hundreds of application specific products for construction, demolition, vehicle maintenance, heavy equipment maintenance, manufacturing and other industries
- 2000** Governed, oil-free grinders
- 2007** Magnesium & composite impact wrenches
- 2010** New Chicago Pneumatic "Red & Black" product design
- 2011** Patented ergonomic handle-design for impact wrenches
- 2012** New Brand Promise: People. Passion. Performance.

Founded over 110 years ago, Chicago Pneumatic has a strong history of constantly looking for new ways to meet your needs, today and tomorrow.

Way back in 1889 John W. Duntley realized that construction workers in particular had a need for many tools that weren't yet available. He founded Chicago Pneumatic Tool Company and set out on a lifelong mission to provide all types of industries and companies the tools necessary for their success.

Over the years Duntley grew the company through product innovation, always insisting on **product quality and reliability**. The name Chicago Pneumatic became known and appreciated by workers around the world for durable, reliable tools that made tough jobs easier and were designed to meet specific needs.

Today, Chicago Pneumatic is a global brand that offers products for almost every industry and countless applications. We're proud to say Chicago Pneumatic still stands for reliability, durability and customer value.

Building on success

From production to maintenance or repair work, your experience of our tools, compressors, and construction equipment is key to our product development and continued success. **It is our mission to keep you productive at all times.**



CP Classic Impact Wrench



New CP7748

Our Mission

Our focus on your industry

Chicago Pneumatic Tools offers hundreds of quality air tools designed for a wide range of maintenance and production applications: impact wrenches, ratchet wrenches, screwdrivers, drills, grinders, sanders and polishers, cutting tools, and a whole lot more.

Based on decades of expertise in providing the right tools, compressors or construction equipment for the toughest demands, we understand the needs of the professionals for maintaining and repairing heavy equipment and machinery on-site or off-site.

A clear and ambitious strategy

Chicago Pneumatic is aiming at delivering best-in class global and local support to customers through large product portfolio availability and a strong network of authorized distributors.

CP Tools offer:

- Large range of tools and accessories
- Stock availability
- Constant products and services development
- Certified quality testing for enhanced performance and durability
- Competitive pricing strategy

People. Passion. Performance.

- Tools and technology training
- Fast support for sales, maintenance and servicing
- Air solution expertise for superior quality, ergonomics and productivity
- Committed to the customers

Proud of our people and values

Chicago Pneumatic Tools is 100% partnering with distributors to ensure local and fast support to the end-users. Our people and partners are trained on the latest air tools technology in order to be the best tool-adviser for the end-user. We bring added value in always targeting to deliver the best choice for each application.

Chicago Pneumatic Tools is part of a large organization that encompasses several other product lines dedicated to professionals. CP can be also a partner of choice for **your compressor needs** and for **construction/ demolition tools**. All are built to withstand tough conditions.



www.youtube.com/CPCHANNELS



www.linkedin.com/company/chicago-pneumatic



Check out your nearest contact at **www.cp.com**

Mining & Construction

Chicago Pneumatic focuses on all the **maintenance, repairs and refurbishing operations** of the mining and construction heavy machinery.

This **Mining & Construction** catalogue refers to **heavy-duty** vehicles, machineries, equipments, attachments and accessories, specially designed for **earthmoving operations**.

MINING

- ▶ Open pit
- ▶ Underground
- ▶ Quarry

CONSTRUCTION

- ▶ Road & bridge
- ▶ Infrastructure
- ▶ Waste & recycling

Infrastructure

- Conveyors & tripper cars
- Elevators & lifting
- Hopper, feeders & vibrating screen
- Grinding mills & crusher
- Washing plant
- Long-wall
- Sheaves, cables, cages
- Hoist & chains

Heavy Vehicles

- Dumpers & articulated trucks
- Haul trains
- Wheel & track loaders,
- Bull & wheel dozers
- Scrappers & coal bowl
- Motor graders
- Backhoe & skid steer loader

Heavy Mobile Equipment

- Hydraulic & rope shovels
- Draglines
- Hydraulic excavators
- Drills & long wall
- Bucket wheel excavators
- Cross-pit spreader
- Transport crawler

Your Expectations

As manager, engineer, supervisor, or as mechanic, tire specialist, foreman, contractor and rental company, you need to **maintain and refurbish** your **mining** or **construction** machineries respecting your budget and reducing the downtime for better productivity of your operations.

Chicago Pneumatic understand your needs, and offers the best air tools selection that can meet your thoughtest demands.

INCREASE YOUR
PRODUCTIVITY



MINING & CONSTRUCTION



Fastening
Drilling

Bolting

Chipping
Grinding

Grinding
Cutting

- ▶ Wheels & tires
- ▶ Tracks, idler & caterpillar
- ▶ Gearbox & braking systems
- ▶ Cylinder & hydraulic attachments
- ▶ Bucket, ripper, tooth & blade
- ▶ Transmission & axle
- ▶ Engine & steering
- ▶ Cabin & housing



Chipping
Grinding

Fastening
Finishing

Bolting
Chipping

Bolting
Fastening

Your Applications

Equipment Maintenance



Our Expertise

Engineered for demanding applications

Chicago Pneumatic provides tools designed and constructed to meet the rugged demands of your industry!



Skidmore Bench test



Sound test



Strict testing and quality inspections

To ensure and guarantee long life performance, many strict testing and quality inspections are conducted throughout the design, production, and assembly stages.

Assembly control



Customer satisfaction

At Chicago Pneumatic, quality is priority! We are constantly optimizing our products to offer you the right tool for your toughest applications. All products are thoroughly tested in the CP Technocenter to pass EC certification according to ISO Standards.



Contents

Bolting



11

Fastening



19

Grinding



23

Finishing



31

Drilling



35

Chipping



39

Speciality Tools



45

Air Line Accessories



49

Index - Safety Instructions - Conversion Table

53

Catalog Guide

Features & benefits
Main product features, & how they help the operator

CP parts and genuine Accessories
found on last page of each section

Table of characteristics
find part number for ordering

Similar product(s) in the range
Part number here if line not in table of characteristics

Product focus

QR CODES



CP now enhances additional user interaction in their catalogs. On most pages, QR codes let you extend your reading and get more information about our products in seconds. Flash them with your smartphone and enjoy!

Actual products may differ from photographs throughout this catalog.



www.youtube.com/cpchannels

The Classic Range

For decades, these Classic Chicago Pneumatic products have been getting the job done. Featuring authentic styling you have come to love.

Limited 2-year warranty extension **REQUIRES** registration of each tool on the CP website within 4 weeks of the original purchase date. Visit www.cp.com/classic for more info.

Accessories & Spares



AIR LINE ACCESSORIES



ERGONOMICS



CONSUMABLES

Original CP Spares and genuine Tune-up kits are available for your CP tools



Follow these logos to find the dedicated spare-kit and accessories selection listed at the end of each product section.

Bolting



Impact Wrenches

An impact wrench delivers a series of rotary blows to a fastener, producing torque. The advantages of impact wrenches are the **high power-to-weight ratio**, **fast rundown**, and **limited torque reaction** to the operator.

Ratchet Wrenches

For bolting applications in tight and difficult to access areas, CP offers you a range of ratchet wrenches with various square drive sizes up to 90 ft-lbs (122Nm).

How to select your bolting tool?

Choose your Handle



Pistol (P)



D Handle Inside Trigger (D I T)



D Handle Outside Trigger (D O T)

Step 1

Applications

- ▶ Materials
- ▶ Joint types
- ▶ Fasteners
- ▶ Torque
- ▶ Duty

Step 2

Sockets

- ▶ Type
- ▶ Size
- ▶ Access

Step 3

Tools

- ▶ Clutch type
- ▶ Handle type
- ▶ Square drive & socket retainer
- ▶ Torque

Choose your clutch

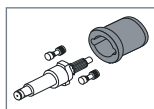

DYNA-PACT
(Pin clutch):
Excellent on hard joints with a good power/weight ratio.

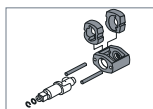

Double dog:
All around clutch with a high ultimate torque and high power/weight ratio.

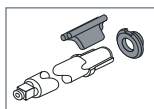

Rocking dog:
Good on very soft joints providing high speed rundown.

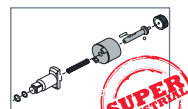

2-Jaw
Excellent on soft or hard joints with never-ending ultimate torques.

Under optimal conditions of the air line network and its connections, tightening and loosening should take place within **5 seconds** for increased durability of your tool. If this is not the case, a selection of a higher-performance product is recommended.

Choose your retainer

A wide selection of retainers provides from versatility to safety for every type of application - all with power, speed and comfort.

VERSATILITY



Quick Change for screwdriver bits or torsion bars



Friction Ring for rapid socket change



Dual (Hole + Friction) for versatility



Pin Retainer for dedicated applications



Hole for pin o-ring type retention



Integral Spline with integral push button retainer

SAFETY

Bolting

CP8242-P

1/2"



DURABLE, COMPACT & POWERFUL

FEATURES

- 1/2" compact impact with Pin retainer
- Powerful & durable double dog clutch
- Composite body and Aluminum clutch housing
- 3 power settings in forward & full power in reverse
- Protective cover & suspension bail

CP8242-R

Same features as CP8242-P with Ring Retainer

CP8222-P

CP8222-R

Same features as CP8242-P/R with 3/8" Square Drive

BENEFITS

- Durable and reliable for intensive use
- Light weight & low noise for operator comfort
- Compact for easy access

CP8252-P

1/2"



DURABLE, ERGONOMIC & VERSATILE

FEATURES

- 1/2" impact with Pin retainer
- Powerful & durable double dog clutch
- Composite body and Aluminum clutch housing
- 3 power settings in forward & full power in reverse
- Protective cover & suspension bail

CP8252-R

Same features as CP8252-P with Ring Retainer

BENEFITS

- Durable and reliable for intensive maintenance use
- Light weight, limited vibrations & noise for operator comfort
- Multi-purpose tool for versatile applications

CP7748

1/2"



EXTREME TORQUE & DURABILITY

FEATURES

- 1/2" composite impact wrench
- 922 ft.lbs - 1250 Nm of maximum torque in reverse
- Thermo-plastic rubber injected in housing for a durable and comfortable grip
- Universal & durable double dog mechanism

CP7748-2

Same features as CP7748 with 2" extended Square Drive

BENEFITS

- Maximize work efficiency with great power
- Insulated and comfortable grip with rubber injected composite housing



See accessories on page 18

CP8272-D

3/4"



ERGONOMIC, RELIABLE & VERSATILE

FEATURES

- 3/4" impact with Dual retainer (Hole + Ring)
- Powerful & durable Twin hammer clutch
- Composite body and Aluminum clutch housing
- 3 power settings in forward & full power in reverse
- Protective cover & reinforced structure

CP8272-P

Same features as CP8272-D with Pin Retainer

BENEFITS

- Light weight, limited vibrations & noise for operator comfort
- Durable and reliable for intensive maintenance use
- Multi-purpose tool for versatile applications

MODEL	PART NUMBER	DRIVE	BLOWS PER MIN	FREE SPEED	WORKING TORQUE (FW)		MAX TORQUE (REV)		NET WEIGHT		LENGTH		AIR CONS. @LOAD		VIBRATION LEVEL ISO 28927 (m/s ²)		SOUND PRESS.	SOUND POWER	AIR INLET
					ft.lb	Nm	ft.lb	Nm	lb	kg	in.	mm	cfm	l/s	a	K			
CP8222-P	615 159 0180	3/8	1250	11500	59-395	80-400	332	450	2.6	1.2	7.0	177	32	10	5.80	2.4	89	100	1/4
CP8222-R	615 159 0230	3/8	1250	11500	59-395	80-400	332	450	2.6	1.2	7.0	177	32	10	5.80	2.4	89	100	1/4
CP8242-P	615 159 0200	1/2	1250	11500	59-395	80-400	406	550	2.6	1.2	7.0	177	32	10	6.60	3.2	89	100	1/4
CP8242-R	615 159 0240	1/2	1250	11500	59-395	80-400	406	550	2.6	1.2	7.0	177	32	10	6.60	3.2	89	100	1/4
CP8252-P	615 159 0210	1/2	1400	9000	111-553	150-750	701	950	4.4	2.0	7.9	200	29	12	8.80	3.6	94	105	1/4
CP8252-R	615 159 0250	1/2	1400	9000	111-553	150-750	701	950	4.4	2.0	7.9	200	29	12	8.80	3.6	94	105	1/4
CP7748	894 107 7480	1/2	1200	8200	75-580	102-786	920	1250	4.4	2.0	7.6	195	21	10	7.40	2.2	93	104	1/4
CP7748-2	894 107 7482	1/2	1200	8200	75-580	102-786	922	1250	4.9	2.2	9.6	245	21	10	7.40	2.2	93	104	1/4
CP8272-D	615 159 0260	3/4	1000	6500	184-922	250-1250	1217	1650	7.3	3.3	9.1	230	48	18	15.5	6.8	96	107	3/8
CP8272-P	615 159 0220	3/4	1000	6500	184-922	250-1250	1217	1650	7.3	3.3	9.1	230	48	18	15.5	6.8	96	107	3/8

All models: Hose int. 3/8" (10mm) - @90 PSI (@6.3 Bar)

Listed specifications are for reference only. Please check documents in each tool.

3/8" - 1/2" - 3/4" Impact Wrenches

CP734H



1/2"



DURABILITY & PERFORMANCE

FEATURES

- 1/2" impact wrench
- DYNA-PACT oil bath clutch
- One-handed push button forward/reverse with 4 positive power settings
- Through handle air exhaust and 360° air inlet swivel

CP724H

Same features as CP734H with 3/8" Square Drive

CP734H KIT CP734H KIT M

See details on page 16

BENEFITS

- Clutch delivers smooth operation and extreme durability
- Operator comfort
- Versatile and powerful tool ideal for all general repairs and maintenance applications

CP6500-RSR

1/2"



THE BEST 1/2" HEAVY-DUTY FOR HARSH ENVIRONMENT

FEATURES

- 1/2" heavy-duty impact wrench
- Double dog clutch oil bath
- Aluminum body & steel clutch housing
- Regulator 4 positions

CP6500-RS

Same features as CP6500-RSR with Pin Retainer

BENEFITS

- Best performer for heavy Duty applications
- Operator comfort and control
- Reliable double-dog clutch in oil bath & durable housing
- Compact 3-part construction & easy to maintain

CP772H



3/4"



DURABILITY & PERFORMANCE

FEATURES

- 3/4" impact wrench
- DYNA-PACT oil bath clutch
- One-handed push button forward/reverse with 4 positive power settings
- 360° air inlet swivel

CP772H KIT CP772H KIT M

See details on page 16

BENEFITS

- Smoothest operating tool with unmatched durability
- Operator comfort
- Ideal for spring work, maintenance, farm machinery, and Mining & Construction equipment

CP6060 SASAB

3/4"



SUPER-DUTY, POWERFUL & SMOOTH COMFORT IN 3/4"

FEATURES

- 3/4" super-duty impact with 2-Jaw clutch
- Aluminum body & steel clutch housing
- Hole type socket retainer

CP6060 SASAR

Same features as CP6060 SASAB with Ring Retainer

BENEFITS

- Best 3/4" to loosen big bolts on very demanding applications
- Operator comfort and control thanks to perfect ergonomic design even at high torque levels
- Reliable clutch & durable housing
- Compact 3-part construction & easy to maintain

CP6060 ZASAB

Same features as CP6060 SASAB with Zinc Alloy Housing for explosive environment



See accessories on page 18

MODEL	PART NUMBER	DRIVE	BLOWS PER MIN	FREE SPEED	WORKING TORQUE (FW)		MAX TORQUE (REV)		NET WEIGHT		LENGTH		AIR CONS. @LOAD		VIBRATION LEVEL ISO 28927 (m/s ²)		SOUND PRESS.	SOUND POWER	AIR INLET
					ft.lb	Nm	ft.lb	Nm	lb	kg	lb	mm	cfm	l/s	a	K			
CP724H	894 100 7240	3/8	1680	8500	40-170	54-230	200	271	3.1	1.4	6.00	152	12	5.7	3.4	1.7	93	104	1/4
CP734H	T024351	1/2	1020	8400	25-310	34-420	425	576	7.8	3.5	7.50	191	15	7.1	7.2	3.3	93	104	1/4
CP6500 RSR	T025216	1/2	1320	6400	103-354	140-480	525	710	5.8	2.6	7.40	188	25	11.8	8.0	2.5	96	107	1/4
CP6500 RS	T025214	1/2	1320	6400	103-354	140-480	525	710	5.8	2.6	7.01	178	25	11.8	8.0	2.5	96	107	1/4
CP772H	T024598	3/4	900	4200	150-700	203-949	1000	1356	10.5	4.7	9.60	245	24	11.3	5.8	2.0	96	107	3/8
CP6060 SASAB	T024059	3/4	1000	3500	195-650	265-880	995	1350	11.7	5.3	7.64	194	42	19.8	14.2	4.1	95	106	3/8
CP6060 ZASAB	T024064	3/4	1000	3500	195-650	265-880	995	1350	11.7	5.3	7.64	194	42	19.8	14.2	4.1	95	106	3/8
CP6060 SASAR	T024058	3/4	1000	3500	195-650	265-880	995	1350	11.9	5.4	7.64	194	42	19.8	14.2	4.1	95	106	3/8

All models (except CP6060 models): Hose int. 3/8" (10mm) - @90 PSI (@6.3 Bar)
CP6060 models: Hose int. 1/2" (13 mm) - @90PSI (@6.3 Bar)

Listed specifications are for reference only. Please check documents in each tool.

Bolting

CP6060 SASAK

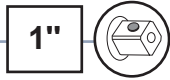

SUPER-DUTY, COMPACT & SMOOTH COMFORT IN 1"

FEATURES

- 1" super-duty impact with 2-jaw clutch
- Reliable 2-jaw clutch
- Aluminum body & steel clutch housing
- Hole type socket retainer

BENEFITS

- Best compact 1" to loosen big bolts on very demanding applications
- Operator comfort and control thanks to perfect ergonomic design even at high torque levels
- Reliable clutch & durable housing
- Compact 3-part construction & easy to maintain

CP6060 ZASAK



Same features as CP6060-SASAK with Zinc Alloy Housing for explosive environment

CP7774



ECONOMIC CHOICE

FEATURES

- 1" impact wrench
- Rocking dog clutch
- High torque: 1750 ft.lbs (2373 Nm)
- 3-position power settings in forward and reverse

BENEFITS

- Operator comfort
- Value for money

CP7774-6

Same features as CP7774 with 6" Extended Anvil

CP0611P RS



SUPER DUTY & EXTREME POWER IN 1"

FEATURES

- 1" super-duty impact with 2-jaw clutch
- Reliable 2-jaw clutch
- Aluminum body & steel clutch housing
- 360° D-type side handle
- Hole type socket retainer

BENEFITS

- Best performer to loosen big bolts quickly and easily
- Operator comfort and control with adjustable side handle even at high torque levels
- Reliable clutch & durable housing
- Compact 3-part construction & easy to maintain

CP0611P RLS

Same features as CP0611-RS with #5 Spline Drive



CP6060 SASAK

See accessories on page 18



MODEL	PART NUMBER	DRIVE	BLOWS PER MIN	FREE SPEED	WORKING TORQUE (FW)		MAX TORQUE (REV)		NET WEIGHT		LENGTH		AIR CONS. @LOAD		VIBRATION LEVEL ISO 28927 (m/s ²)		SOUND PRESS. ISO 15744 - dB(A)	SOUND POWER	AIR INLET
					ft.lb	Nm	ft.lb	Nm	lb	kg	in.	mm	cfm	l/s	a	K			
CP6060 SASAK	T024060	1	1000	3500	195-650	265-880	995	1350	11.9	5.4	7.6	194	42	19.8	14.2	4.1	95	106	3/8
CP6060 ZASAK	T024063	1	1000	3500	195-650	265-880	995	1350	11.9	5.4	7.6	194	42	19.8	14.2	4.1	95	106	3/8
CP7774	894 107 7740	1	750	5000	100-1300	136-1763	1750	2373	22.2	10.1	10.5	267	33	15.6	13.7	4.9	105	116	1/2
CP7774-6	894 107 77746	1	750	5000	100-1100	136-1491	1550	2102	25.5	11.6	17.0	432	33	15.6	13.7	4.9	105	116	1/2
CP0611P RS	T025413	1	1020	3500	900-1800	1220-2440	2800	3790	23.1	10.5	10.7	272	48	22.6	16.8	4.7	102	113	1/2
CP0611P RLS	T025414	#5 spline	1020	3500	900-1800	1220-2440	2800	3790	23.1	10.5	10.7	272	48	22.6	16.8	4.7	102	113	1/2

All models: Hose int. 1/2" (13mm) - @90 PSI (@6.3 Bar)

Listed specifications are for reference only. Please check documents in each tool.

CP7782

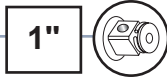

HIGH TORQUE & DURABILITY

FEATURES

- 1" straight impact wrench with dual retainer
- 2140 ft.lbs - 2900 Nm of maximum torque in reverse
- Pinless closed reinforced rocking dog impact mechanism
- Socket retainer ring combined with hole retainer
- Full teasing trigger
- Regulator with integrated forward/reverse with 3-position power settings in both directions

BENEFITS

- High efficiency motor, economical with durable reinforced clutch mechanism
- Highly durable impact wrench with great power for the toughest jobs on heavy vehicles

CP7782-6

Same features as CP7782 with 6" Extended Anvil

CP5000



MOST POWERFUL EXTENDED 1"

FEATURES

- 1" impact wrench
- Rocking dog clutch
- 4-position power settings throttle for ease of use
- 7" extended anvil

BENEFITS

- Our strongest and most powerful 1" with extended anvil
- Operator productivity
- Ideal for high volume tire work

CP6920 PALED



POWERFUL, FAST & ERGONOMIC

FEATURES

- 1" impact with pinless rocking dog clutch
- Aluminum body clutch housing
- Dual (hole & ring) type socket retainer
- Bail for balancer

BENEFITS

- Excellent medium-duty 1" for versatile industrial applications
- Operator comfort with adjustable side handle and control with 4-position regulator
- Reliable clutch & durable housing
- 3-part construction for easy maintenance

CP6910 RS

Same features as CP6920 PALED in Pistol Shape



CP7782-6

See accessories on page 18



MODEL	PART NUMBER	DRIVE	BLOWS PER MIN	FREE SPEED	WORKING TORQUE (FW)		MAX TORQUE (REV)		NET WEIGHT		LENGTH	AIR CONS. @LOAD		VIBRATION LEVEL ISO 28927 (m/s ²)		SOUND PRESS.	SOUND POWER	AIR INLET	
					ft.lb	Nm	ft.lb	Nm	lb	kg		in.	mm	cfm	l/s				a
CP7782	894 117 7780	1	500	5200	440-1850	600-2500	2140	2900	22.2	10.1	14.7	370	40.7	19.2	6.5	1.6	100	111	1/2
CP7782-6	894 117 7786	1	500	5200	440-1850	600-2500	2140	2900	25.5	11.6	20.4	520	40.7	19.2	6.5	1.6	100	111	1/2
CP5000	T024585	1	540	3700	185-2065	240-2800	2500	3390	30.5	13.8	22.5	572	52.0	25.0	8.5	2.6	103	114	1/2
CP6920 PALED	615 190 6920	1	630	5500	970-1785	1300-2400	2083	2800	23.0	10.5	11.3	354	35.0	16.7	14.9	8.2	103	114	1/2
CP6910 RS	615 190 6910	1	600	5000	970-1785	1300-2400	2083	2800	23.0	10.5	11.3	288	36.0	16.8	13.7	4.9	96	107	1/2

All models: Hose int. 1/2" (13mm) - @90 PSI (@6.3 Bar)

Listed specifications are for reference only. Please check documents in each tool.

Bolting

1" & 1-1/2" Impact Wrenches

CP0611 PASED



CP0611 GASED

Same features as CP0611 PASED with external trigger

CP0611 HAZED

Same features as CP0611 PASED with Zinc alloy housing



CP0611 GASEL

CP0611 PASEL

Same features as CP0611 G / PASED with #5 Spline Drive



SUPER DUTY, COMPACT & EXTREME POWER IN 1"

FEATURES

- 1" super-duty impact 2-jaw clutch
- Aluminum body & steel clutch housing
- 360° adjustable D-type side handle
- Internal trigger

BENEFITS

- Best performer of industry to loosen big bolts quickly and smoothly
- Operator comfort and control with adjustable side handle even at high torque levels
- Reliable impact mechanism & durable housing
- Compact 3-part construction & easy to maintain

CP6120 PASED



CP6120 GASED

Same features as CP6120 PASED with external trigger

SUPER-DUTY, COMPACT & NEVER ENDING 1-1/2"

FEATURES

- 1-1/2" super-duty impact with 2-jaw clutch
- Durable aluminum body & steel clutch housing
- 360° adjustable D-type side handle
- Internal trigger

BENEFITS

- Best gun to loose very big bolts quickly and smoothly
- Operator comfort and control with adjustable side handle even at high torque levels
- Reliable impact mechanism & durable housing
- Compact 3-part construction for easy maintenance



See accessories on page 18

MODEL	PART NUMBER	DRIVE	BLOWS PER MIN	FREE SPEED	WORKING TORQUE (FW)		MAX TORQUE (REV)		NET WEIGHT		LENGTH		AIR CONS. @LOAD		VIBRATION LEVEL ISO 28927 (m/s ²)		SOUND PRESS. ISO 15744 - dB(A)	SOUND POWER NPT	AIR INLET
					ft.lb	Nm	ft.lb	Nm	lb	kg	in.	mm	cfm	l/s	a	K			
CP0611 PASED	T022578	1	1020	3500	900-1800	1220-2440	2800	3790	22.5	10.2	12.5	318	48	22.6	16.1	4.5	97	108	1/2
CP0611 GASED	T022580	1	1020	3500	900-1800	1220-2440	2800	3790	22.5	10.2	12.5	318	48	22.6	16.1	4.5	97	108	1/2
CP0611 HAZED	T022582	1	1020	3500	900-1800	1220-2440	2800	3790	22.5	10.2	12.5	318	48	22.6	16.1	4.5	97	108	1/2
CP0611 GASEL	T022581	#5 spline	1020	3500	900-1800	1220-2440	2800	3790	22.5	10.2	12.5	318	48	22.6	16.1	4.5	97	108	1/2
CP0611 PASEL	T022579	#5 spline	1020	3500	900-1800	1220-2440	2800	3790	22.5	10.2	12.5	318	48	22.6	16.1	4.5	97	108	1/2
CP6120 PASED	T018841	1-1/2	960	3000	600-2000	815-2710	3500	4740	33.9	15.4	14.7	375	60	28.3	21	6.6	102	113	1/2
CP6120 GASED	T018237	1-1/2	960	3000	600-2000	815-2710	3500	4740	33.9	15.4	14.7	375	60	28.3	21	6.6	102	113	1/2

All 1" models: Hose int. 1/2" (13mm) - @90 PSI (@6.3 Bar)

All 1-1/2" models: Hose int. 3/4" (19mm) - @90 PSI (@6.3 Bar)

Listed specifications are for reference only. Please check documents in each tool.

IMPACT KITS

CP734H Kit / CP734H Metric Kit

Part No. T025163 / T025164

Kits include:

- (1) CP734H - 1/2" Impact
- (5) Imperial Sockets 1/2", 5/8", 3/4", 7/8" & 15/16" or
- (5) Metric Sockets (14, 16, 17, 19 & 22mm)



CP772H Kit / CP772H Metric Kit

Part No. T025171 / T025162

Kits include:

- (1) CP772H - 3/4" Impact
- (4) Imperial Sockets 15/16", 1", 1-1/16" & 1-1/8" or
- (4) Metric Sockets (24, 27, 30 & 32mm)



TUNE-UP KITS & REPAIR KITS

MODEL	TUNE-UP KIT	REPAIR KIT	MODEL	TUNE-UP KIT	REPAIR KIT
CP0611 GASED	C115811	-	CP734H	CA147716	CA147717
CP0611 GASEL	C115811	-	CP734H Kit	CA147716	CA147717
CP0611 HAZED	C115811	-	CP734H Kit Metric	CA147716	CA147717
CP0611 PASED	C115811	-	CP772H	CA149746	CA149747
CP0611 PASEL	C115811	-	CP772HK-Metric	CA149746	CA149747
CP0611P RLS	C115811	-	CP772HK	CA149746	CA149747
CP0611P RS	C115811	-	CP7748	8940169810	-
CP5000	CA148687	-	CP7748-2	8940169810	-
CP6060 SASAB	C137568	C148005	CP7774	8940162697	-
CP6060 SASAK	C137568	C148005	CP7774-6	8940162697	-
CP6060 SASAR	C137568	C148005	CP7782	8940169847	-
CP6060 ZASAB	C137568	C148005	CP7782-6	8940169847	-
CP6060 ZASAK	C137568	C148005	CP8222-PJ-R	2050557013	2050521393
CP6500 RS	8940158638	8940158639	CP8242-PJ-R	2050557013	2050521403
CP6500 RSR	8940158638	8940158640	CP8252-PJ-R	2050557163	2050521423
CP724H	CA155218	CA155310	CP8272-PJ-D	2050524703	2050524713

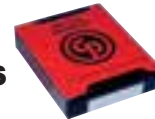

1/4" - 3/8" - 1/2" Ratchet Wrenches

CP9426



HIGH POWER & COMPACT

CP9427

Same features as CP9426 with 3/8" Square Drive

FEATURES

- 1/4" mini ratchet
- One of the smallest ratchets only 5.1" (130mm) long
- Rubber grip

BENEFITS

- Most powerful of its class
- Operator comfort
- Compact and lightweight

CP825



SMALL & HANDY

CP825T

Same features as CP825 with 3/8" Square Drive

FEATURES

- 1/4" ratchet
- Progressive tease throttle
- Small ratchet, only 6.5" (165 mm) long
- Convenient forward and reverse button

BENEFITS

- Ideal for tight access applications
- One-finger directional changes
- Compact and lightweight

CP828



CP828H

Same features as CP828 with 1/2" Square Drive

HEAVY DUTY & DURABLE

FEATURES

- 3/8" ratchet
- Features CP's patented TriSpring anti-slip head design
- Compact, yet packed with power and speed
- Hardened gears

BENEFITS

- Easy access in restricted area
- Greater durability
- Easy grip reverse for simple directional changes

CP7830HQ



CP7830Q

Same features as CP7830 with 3/8" Square Drive

POWERFUL & QUIET

FEATURES

- 3/8" quiet ratchet
- Adjustable exhaust, sound level as low as 79 dB(A)
- Highest torque on the market: 90 ft.lbs (122 Nm)
- Rubber handle grip
- Features CP's patented TriSpring

BENEFITS

- Lightweight and well balanced tool
- Durability and comfort
- Ratchet head protection

CP7830HQA KIT Metric



Part No. 894 377 8308

Kit includes:

- (1) 1/2" Ratchet CP7830HQ
- (5) Sockets - 10, 13, 14, 16 & 17mm

See accessories on page 18



MODEL	PART NUMBER	DRIVE	FREE SPEED	WORKING TORQUE (FW)		MAX TORQUE (REV)		NET WEIGHT		LENGTH		AIR CONS. @LOAD		VIBRATION LEVEL ISO 28927 (m/s ²)		SOUND PRESS. ISO 15744 - dB(A)	SOUND POWER	AIR INLET
				ft.lb	Nm	ft.lb	Nm	lb	kg	in.	mm	cfm	l/s	a	K			
CP9426	615 191 9426	1/4	270	5-27	7-35	27	35	1.1	0.5	5.1	128	12	5.7	5.0	1.5	82	93	1/4
CP9427	615 191 9427	3/8	270	5-27	7-35	27	35	1.1	0.5	5.1	128	12	5.7	5.0	1.5	82	93	1/4
CP825	T023145	1/4	200	5-15	6-21	15	21	1.9	0.8	6.5	165	11	5.2	3.0	1.2	87	98	1/4
CP825T	T023190	3/8	200	5-15	6-21	15	21	1.9	0.8	6.5	165	11	312	3	1.2	87	98	1/4
CP828	T022708	3/8	150	10-50	13-70	50	70	2.4	1.0	10.0	254	15	7.1	3.2	1.3	96	108	1/4
CP828H	T022970	1/2	150	10-50	13-70	50	70	2.4	1.0	10.0	254	15	7.1	3.2	1.3	96	108	1/4
CP7830HQ	894 107 8308	1/2	190	10-90	13-122	90	122	2.7	1.2	12.0	305	21	9.9	4.1	1.4	85	96	1/4
CP7830Q	894 107 8306	3/8	190	10-90	13-122	90	122	2.7	1.2	12.0	305	21	9.9	4.1	1.4	85	96	1/4

All models: Hose int. 3/8" (10mm) - @90 PSI (@6.3 Bar)

Listed specifications are for reference only. Please check documents in each tool.

Bolting

Accessories



MAGNETIC TOOL HOLDER

TOOL	PART NUMBER
CP9841	894 016 6664



GLOVES

DESCRIPTION	PART NUMBER
Impact Gloves: Large	894 015 8618
Impact Gloves Extra Large	894 015 8619



Certified EN 388 (Protection against mechanical risks), the CP gloves are the ideal option to protect the operator's hands in harsh environments, such as mining and construction applications.



SOCKETS



SET - 3/8" SQUARE DRIVE IMPACT SOCKETS

MODEL	PART NUMBER	TYPE	NO. OF PIECES	DIMENSIONS
METRIC (mm)				
SS3113	894 016 4446	STANDARD	13	7, 8, 9, 10, 11, 12, 13, 14, 15, 16, 17, 18 & 19mm
SS3113D	894 016 4447	DEEP	13	7, 8, 9, 10, 11, 12, 13, 14, 15, 16, 17, 18 & 19mm
SAE (in)				
SS3112	894 016 4452	STANDARD	12	5/16", 3/8", 7/16", 1/2", 9/16", 5/8", 11/16", 3/4", 13/16", 7/8", 15/16" & 1"
SS3112D	894 016 4453	DEEP	12	5/16", 3/8", 7/16", 1/2", 9/16", 5/8", 11/16", 3/4", 13/16", 7/8", 15/16" & 1"



SET - 1/2" SQUARE DRIVE IMPACT SOCKETS

MODEL	PART NUMBER	TYPE	NO. OF PIECES	DIMENSIONS
METRIC (mm)				
SS4114	894 016 4458	STANDARD	14	10, 11, 12, 13, 14, 15, 16, 17, 18, 19, 21, 22, 26 & 27mm
SS4114D	894 016 4459	DEEP	14	10, 11, 12, 13, 14, 15, 16, 17, 18, 19, 21, 22, 26 & 27mm
SS413DTW	894 016 6760	THIN WALL	3	17, 19 & 21mm
SAE (in)				
SS4013D	894 016 4466	DEEP	13	7/16", 1/2", 9/16", 5/8", 11/16", 3/4", 13/16", 7/8", 15/16", 1", 1-1/16", 1-1/8" & 1-1/4"



SET - 3/4" SQUARE DRIVE IMPACT SOCKETS

MODEL	PART NUMBER	TYPE	NO. OF PIECES	DIMENSIONS
METRIC (mm)				
SS618	894 016 4472	STANDARD	8	26, 27, 29, 30, 32, 35, 36 & 38mm
SS618D	894 016 4473	DEEP	8	26, 27, 29, 30, 32, 35, 36 & 38mm
SS611DWS	894 016 7072	WHEEL SERVICE	11	Square: 17, 19, 21mm - Deep: 27, 30, 32, 33, 35, 36, 38 & 41mm
SAE (in)				
SS6008D	894 016 7073	DEEP	8	1", 1-1/16", 1-1/8", 1-1/4", 1-5/16", 1-3/8", 1-7/16" & 1-1/2"



SET - 1" SQUARE DRIVE IMPACT SOCKETS

MODEL	PART NUMBER	TYPE	NO. OF PIECES	DIMENSIONS
METRIC (mm)				
SS818	894 016 4476	STANDARD	8	27, 30, 32, 33, 35, 36, 38 & 41mm
SS814D	894 016 6016	DEEP	4	27, 32, 33 & 36mm
SS818D	894 016 4477	DEEP	8	27, 30, 32, 33, 35, 36, 38 & 41mm
SAE (in)				
SS808D	894 016 4479	DEEP	8	7/8", 15/16", 1", 1-1/16", 1-1/8", 1-3/16", 1-1/4" & 1-1/2"



1-1/2" SQUARE DRIVE IMPACT SOCKETS

MODEL	PART NUMBER	TYPE	NO. OF PIECES	DIMENSIONS
METRIC (mm)				
S1070M	894 016 9354	STANDARD	1	70 mm
S1080MD	894 016 9359	DEEP	1	80 mm
S1090M	894 016 9358	STANDARD	1	90 mm



Fastening



Pistol shape for horizontal applications or for forcing fastening



Straight shape for vertical applications

How to select your fastening tool?

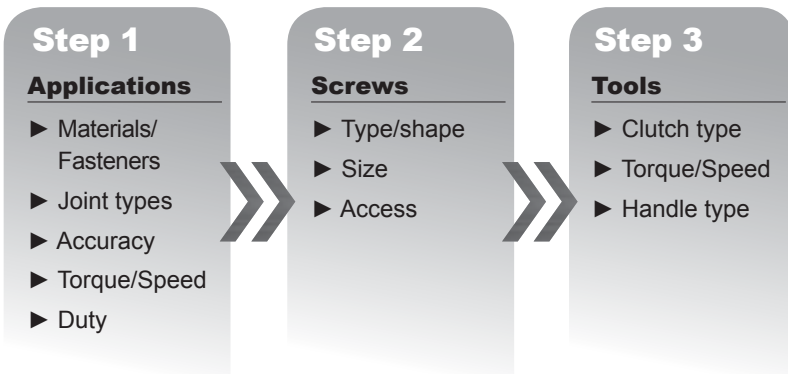

Clutch Type

Direct drive

- No clutch, directly driven bit
- Stall torque regulated to air pressure
- Easy to use and maintain
- Ergonomic handling (light weight, size...)

Positive clutch

- Good for varying torque applications
- Operator can force clutch engagement for higher torque
- Excellent for wood applications

Cushion clutch

- High speed rundown
- Torque output adjusted by the spring tension
- Clutch ratchets at preset torque
- Easy to use, to adjust and to maintain

Voluntary, CP Screwdrivers with auto shut-off have not been selected for mining and construction applications. If you need, please look at www.cp.com

Joint/Screws Combinations

The chart beside correlates different joint and screws combinations. This chart is helpful for initially determining the most likely combination, however on-site testing is recommended to ensure that proper tooling is used for the application.

Soft joint (A) and hard joint (B) / metal screw (class 8,8)	
The initial torque required is very low and grows gradually (soft joint A) or rapidly (hard joint B) when the screw head begins to slip on the joint.	
Sheet metal joint / self -threading screw	
The initial torque for forming the thread is lower than the final tightening torque.	
Enamelled sheet metal joint / self -threading screw	
The initial torque for forming the thread is higher than the final tightening torque.	
Sheet metal joint / self -drilling screw	
The initial torque for making the hole and forming the thread tends to increase rapidly when the screw head slips on the joint.	
Joint with self -locking nut	
The initial torque required to overcome the friction generated by the plastic insert in the nut tends to increase rapidly when the screw head slips on the joint.	

Fastening

CP2780

2,100 rpm



POSITIVE ACTION CLUTCH

FEATURES

- Positive clutch with 1/4" hex. quick-change
- Quick-change chuck
- Reverse control at the trigger
- Progressive trigger

BENEFITS

- Tool designed for soft or prevailing torque applications
- Convenient one-handed operation (side handle available as accessory)
- Operator can force clutch engagement for higher torque

CP2765

900 rpm



VERY HIGH-TORQUE DIRECT DRIVE

FEATURES

- Direct drive screwdriver with 1/4" hex. quick-change
- Quick change chuck
- Reverse control at the trigger
- Progressive trigger

CP2755

Similar features as CP2765 with 2200 rpm and 124 in.lb (14 Nm) max torque



BENEFITS

- Good for soft draw applications
- Simple maintenance
- Convenient one-handed operation

CP2612

1,700 rpm

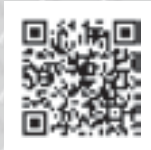

3 AIR INLETS FOR VARIOUS APPLICATIONS

FEATURES

- Cushion clutch
- 1700 rpm
- Included accessories
- Keyless torque adjustment
- One-hand reverse

BENEFITS

- Ideal for multiple applications
- Operator comfort
- Durability & quality

CP2623

Close features as CP2612 with straight shape



See accessories on page 21



MODEL	PART NUMBER	OUTPUT DRIVE	FREE SPEED	TORQUE RANGE				NET WEIGHT		LENGHT		AIR CONS. @LOAD		VIBRATION LEVEL ISO 28927 (m/s ²)		SOUND PRESS. ISO 15744 - dB(A)	SOUND POWER	AIR INLET
				MIN.		MAX.		lb	kg	in.	mm	cfm	l/s	a	k			
		in.	rpm	in.lb	Nm	in.lb	Nm	lb	kg	in.	mm	cfm	l/s	a	k			NPT
CP2755	615 192 2755	1/4" Fem.Hex QC	2200	-	-	124	14.0	2.2	1.0	6.3	160	10	21.7	<2,5	-	90	110	1/4
CP2765	615 192 2765	1/4" Fem.Hex QC	900	-	-	230	26.0	2.6	1.2	7.0	178	10	21.7	<2,5	-	99	110	1/4
CP2780	615 192 2780	1/4" Fem.Hex QC	2100	-	-	133	15.0	2.3	1.1	6.4	164	10	21.7	<2,5	-	89	100	1/4
CP2623	615 192 2623	1/4" Fem.Hex QC	1800	13.2	1.5	48.6	5.5	1.7	0.8	8.2	207	21	20.0	<2,5	-	78	89	1/4
CP2612	615 192 2612	1/4" Fem.Hex QC	1700	8.8	1.0	53	6.0	2.0	0.9	7.5	190	17	8.0	<2,5	-	77	88	1/4

Continuously ratcheting the clutch may produce higher vibration emissions. Please, check operator manual for each tool.

All models: Hose int. 3/8" (10mm) - @90 PSI (@6.3 Bar)

Listed specifications are for reference only. Please check documents in each tool.

Kits, Spares & Accessories



REAR EXHAUST HOSE ASSEMBLY - NOISE REDUCER

MODEL	DESCRIPTION	PART NUMBER
CP2755, CP2765, CP2780	Noise reducer	205 051 6493



SIDE HANDLE

MODEL	DESCRIPTION	PART NUMBER
CP2755, CP2765, CP2780	Side handle	205 049 8553



ACCESSORIES INCLUDED

MODEL	MODEL	PART NUMBER
CP2623, CP2612	Suspension bail	894 016 8729
	Bits (2 Phillips E6.3)	894 020 0791
	Color ring (4)	894 016 8074
	Nipple Male 1/4"NPT	-



Did you know that rusted bolts have a bad impact on the clamping force? Keeping bolts clean is key to have good tightening and the stud cleaners are the ideal solution for that.

STUD CLEANER (Recommended with CP2755)

PART NUMBER	DESCRIPTION	DIAMETER		LENGTH		REPLACEMENT BRUSHES (Sets of 5)
		in.	mm	in.	mm	
894 016 8858	Stud Cleaner M20x37L	0.78	20	1.45	37	8940169930
894 016 9793	Stud Cleaner M22x37L	0.86	22	1.45	37	8940169931
894 016 9794	Stud Cleaner M24x37L	0.94	24	1.45	37	8940169932
894 016 9795	Stud Cleaner M20x60L	0.78	20	2.36	60	8940169933
894 016 9927	Stud Cleaner M22x60L	0.86	22	2.36	60	8940169934
894 016 9928	Stud Cleaner M24x60L	0.94	24	2.36	60	8940169935
894 016 9929	Stud Cleaner M30x60L	1.18	30	2.36	60	8940169936

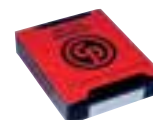

TUNE-UP KITS

MODEL	TUNE-UP KIT
CP2755	205 050 7773
CP2765	205 050 7803
CP2780	205 051 6763
CP2612	894 016 8416
CP2623	894 016 8330

Select your Grinders

ERGONOMIC FEATURES

Chicago Pneumatic Abrasive Tools have all the benefits of advanced ergonomics... with the features required to enhance the physical and mental well-being operators need to achieve increased productivity levels:

- . Significant sound and vibration reduction - helps reduce operator fatigue and improve performance.
- . Complete line - designed for maximum productivity under rugged conditions.
- . Wide choice of tools - die grinders, small wheel grinders, horizontal grinders, and vertical grinders.
- . Powerful, yet complete and lightweight - produce more power per pound than comparable electric models.

- . Air powered - Minimal risk of electrical shock or overheating - even with continuous use.

Other Features:

- . Rugged construction - to withstand tough use.
- . Head treated internal parts - keep tool operating, minimize repairs.
- . Easy to service - simple replacement of rotor blades usually restores original power.
- . Wide variety of accessories - extended versatility of the tool.

COLLET GRINDERS

Recommended speeds depending on the machined and the diameter of the head of the carbide burrs.

The choice of burr depends on the size of your application. A larger volume of material to be removed will require a bigger size of abrasive.

Select the tool rpm depending on the diameter of the burr head, the material to be ground and the material in the rotary burr. Use tungsten carbide burrs for hard and tough materials. High speed steel burrs are recommended for unhardened and medium hard materials. See table.

Material Type	Diameter of the head of the carbide burrs				
	1/8" (3 mm)	1/4" (6 mm)	3/8" (10 mm)	1/2" (12 mm)	5/8" (16 mm)
Steel	60,000 - 90,000	45,000 - 60,000	30,000 - 40,000	22,500 - 30,000	18,000 - 24,000
Tempered steel	60,000 - 90,000	30,000 - 45,000	19,000 - 30,000	15,000 - 22,500	12,000 - 18,000
Stainless steel	60,000 - 90,000	30,000 - 45,000	19,000 - 30,000	15,000 - 22,500	12,000 - 18,000
Casting	45,000 - 90,000	22,500 - 60,000	15,000 - 40,000	11,000 - 30,000	9,000 - 24,000
Titanium	60,000 - 90,000	30,000 - 45,000	19,000 - 30,000	15,000 - 22,500	12,000 - 18,000
Nickel	60,000 - 90,000	30,000 - 45,000	19,000 - 30,000	15,000 - 22,500	12,000 - 18,000
Copper & copper alloys	45,000 - 90,000	22,500 - 60,000	15,000 - 40,000	11,000 - 30,000	9,000 - 24,000
Aluminium	30,000 - 90,000	15,000 - 70,000	10,000 - 50,000	7,000 - 3,800	6,000 - 30,000
Plastics	30,000 - 90,000	15,000 - 70,000	10,000 - 50,000	7,000 - 3,800	6,000 - 30,000
Cermet	60,000 - 90,000	30,000 - 45,000	19,000 - 30,000	15,000 - 22,500	12,000 - 18,000

Small precision deburring: die grinding is performed with either tungsten carbide, high speed steel burrs or mounted points.

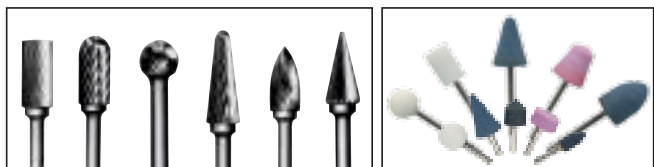

Carbide Burrs

Mounted Points

WHEEL GRINDERS

Pure material removal, regardless of whether it is removed from a cramped or an open space, is determined by the power generated at the grinding process.

The applied feed force and the rotation of the wheel generates a cutting force which multiplied by the peripheral speed of the wheel represents the power removing material (power = peripheral speed x cutting force).

Chicago Pneumatic grinders features a high degree of safety. Safety throttles, over-speed shut-off and wheel guards are good examples of product safety features carried by your grinders.

The table below will help you to translate the peripheral speed of the grinding wheel to the correct rotational speed of the grinder when using a specific diameter of grinding wheel.

Diameter in. (mm)	Maximum work speed in m/s or Feet/Min							
	32	35	40	50	63	80	100	125
1 (25)	24,450	26,740	30,560	38,200	48,130	61,120	76,390	95,490
1-1/4 (32)	19,100	20,890	23,870	29,840	37,600	47,750	59,680	74,600
1-9/16 (40)	15,280	16,710	19,100	23,870	30,080	38,200	47,750	59,680
2 (50)	1,220	1,3370	15,280	19,100	24,060	30,560	38,200	47,750
2-1/2 (63)	9,700	10,610	12,130	15,160	19,100	24,250	30,320	37,890
3 (80)	7,640	8,360	9,550	11,940	15,040	19,100	23,870	29,840
4 (100)	6,110	6,680	7,640	9,550	12,030	15,280	19,100	23,870
5 (125)	4,890	5,350	6,110	7,640	9,630	12,220	15,280	19,100
6 (150)	4,070	4,460	5,090	6,370	8,020	1,190	12,730	15,920
7 (180)	3,400	3,710	4,240	5,310	6,680	8,490	10,610	13,260
7-7/8 (200)	3,060	3,340	3,820	4,780	6,020	7,640	9,550	11,940
9 (230)	2,660	2,910	3,320	4,150	5,230	6,640	8,300	10,380
9-27/32 (250)	2,440	2,670	3,060	3,820	4,810	6,110	7,640	9,550
11-13/16 (300)	2,040	2,230	2,550	3,180	4,010	5,090	6,370	7,960

How ensure operator safety:

- . Check the tool free speed
- . Match the maximum speed of the abrasive to the grinder
- . Inspect the grinding wheel
- . Inspect the flange
- . Inspect the wheel guard

- . Wear protection goggles, gloves & hearing protection
- . Test run your grinder in a protected area after assembling the wheel
- . Make sure that the tools receive proper maintenance, see service sheet

DIFFERENT TYPES OF WHEEL

DEPRESSED CENTER WHEELS



Type 27-42 wheel

FLAP WHEELS



FLAT



CURVED

CUP WHEELS



Type 6 wheel



Type 11 wheel

CUT OFF WHEELS



Type 41 wheel

CUT OFF WHEEL WITH HUB

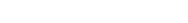

Type 27-42: wheel

CONE WHEELS



Type 16 - 18 - 18R and 19

Grinding



Wheel grinders

For large and medium surfaces, wheel grinders are designed for grinding, cutting, countouring at a high material removal rate.

Collet grinders

For applications with narrow access, collet type grinders are preferred for deburring, die countouring, light chamfering with precision.



Straight Die Grinder



Straight extended Die Grinder

For maximum material removal with minimum effort, choose the best tool.

Step 1

Applications

- ▶ Materials
- ▶ Access
- ▶ Duty
- ▶ Vibrations



Step 2

Abrasives

- ▶ Carbide burrs
- ▶ Mounted points
- ▶ Grinding wheels
- ▶ Cutting wheels
- ▶ Flap wheels



Step 3

Tools

- ▶ Die grinders
- ▶ Angle grinders
- ▶ Vertical grinders
- ▶ Extended shaft grinders



Angle 90° Die Grinder

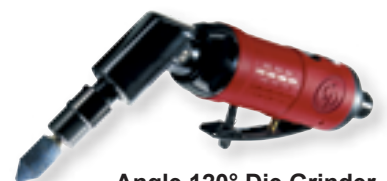

Angle 120° Die Grinder

Caution: CP grinder should comply with the Maximum Operating Speed recommended by component and abrasive manufacturers

Grinding

CP3000-600CR

60,000 rpm 



CP3000-600CR

CP3000-600CR 1/8"

Same features as CP3000-600CR with 1/8" collet



COMPACT & DURABLE BODY

FEATURES

- 3 mm
- Steel but lightweight body
- Grooved housing
- Rotary valve

BENEFITS

- Operator comfort
- High precision
- Industrial grade durability



CP9106Q-B

22,000 rpm 



CP9110Q-B

25,000 rpm 



CP9108Q-B

Similar features as CP9106Q-B with 22000 rpm and 120° angle



QUIET & ANGLE HEAD

FEATURES

- Mini angle die grinder 90°
- High efficient and powerful 0.28 hp (210 W) motor
- High free speed: 22000 rpm
- Low noise level: only 81 dB(A)
- Variable top speed regulator
- Composite overmould grip
- Rear exhaust
- Includes 1/4" and 6 mm collets

BENEFITS

- Maximize operator comfort
- Power and performance
- Precise power and control
- Easy accessibility

CP9105Q-B

Similar features as CP9110 with 28000 rpm and straight shape



HEAVY-DUTY & QUIET

FEATURES

- Heavy-duty die grinder
- Composite overmould grip
- Powerful 0.47 hp (350 W) motor
- Low noise level: only 80 dB(A)
- Variable top speed regulator
- Rear exhaust
- Includes 1/4" and 6 mm collets

BENEFITS

- Maximize operator comfort
- Power and performance
- Precise power and control
- Excellent for general high-speed polishing and grinding



See accessories on page 30

MODEL	PART NUMBER	FREE SPEED		POWER		COLLET CAPACITY		AIR CONS. @LOAD		NET WEIGHT		LENGTH		VIBRATION LEVEL ISO 28927 (m/s ²)		SOUND PRESS.	SOUND POWER	AIR INLET
		rpm	hp	W	in.	mm	cfm	l/s	lb	kg	in.	mm	a	k	ISO 15744 - dB(A)	NPT		
CP3000-600CR	615 160 0330	60000	0.1	90	-	3	5.5	2.6	0.3	0.1	6.0	153	<2.5	-	71	82	1/4	
CP3000-600CR	615 160 0140	60000	0.1	90	1/8	-	5.5	2.6	0.3	0.1	6.0	153	<2.5	-	71	82	1/4	
CP9106Q-B	615 195 2106	22000	0.3	210	1/4	6.35	8.6	4.1	1.5	0.7	4.7	120	5.1	2.6	80	91	1/4	
CP9105Q-B	615 195 2105	28000	0.3	210	1/4	6.35	8.6	4.1	0.8	0.4	6.4	163	3.6	2.0	80	91	1/4	
CP9108Q-B	615 195 2108	22000	0.3	210	1/4	6.35	8.6	4.1	1.1	0.5	7.9	200	5.1	1.6	80	91	1/4	
CP9110Q-B	615 195 2110	25000	0.3	210	1/4	6.35	8.6	4.1	1.5	0.7	10	256	4.9	2.5	80	91	1/4	

All models: Hose int. 1/2" (13mm) - @90 PSI (@6.3 Bar)

Listed specifications are for reference only. Please check documents in each tool.

Compact Die-Grinders

CP860

24,000 rpm 



CP860E

Same features as CP860 with 6 mm collet

CP860ES

Same features as CP860 with 6" extended shank

GREAT DURABILITY

FEATURES

- Heavy-duty die grinder
- 1/4" collet
- Rugged and energy efficient 0.5 hp (370 W) motor
- Adjustable speed regulator
- Lock-off throttle
- Square handle design for greater comfort

BENEFITS

- Powerful, durable and efficient tool
- Precise control and operator comfort
- Excellent for cleaning tires, moldings, porting, relieving engines, and general high-speed polishing and grinding

CP9113G

25,000 rpm 



CP9113G GES

Same features as CP9113G with 6" extended shaft

ROBUST CONSTRUCTION

FEATURES

- 1/4" (6.35 mm) collet holder
- Short body
- 1 hp (750 W) governed motor
- 25000 rpm free speed
- Robust machined steel housing
- Robust safety lever
- Front exhaust

BENEFITS

- High body durability
- Withstands rough usage
- Withstands extreme temperatures

CP3000-520R

20,000 rpm 



CP3000-515R

Same features as CP3000 520R with 15000 rpm

LIGHTWEIGHT & HIGH ERGONOMICS

FEATURES

- 1/4" (6.35 mm) collet holder
- 0.7 hp (500 W) industrial grade motor
- 20000 rpm free speed
- Compact composite housing
- Streamlined safety lever
- Rear Exhaust

BENEFITS

- Operator comfort
- High precision
- Industrial grade durability
- Easy maintenance

CP3000 518R

Same features as CP3000 520R with 18000 rpm



See accessories on page 30

CP3030-520R

20,000 rpm 



CP3030-518R

Same features as CP3030 520R with 18000 rpm

LIGHTWEIGHT & HIGH ERGONOMICS

FEATURES

- 1/4" (6.35 mm) collet holder
- 0.7 hp (500 W) industrial grade motor
- 20000 rpm free speed
- Compact composite housing
- Streamlined safety lever
- Gearless durable construction
- 7" angle to allow working in tight angles
- Rear Exhaust

BENEFITS

- Operator comfort
- High precision
- Industrial grade durability
- Easy maintenance

MODEL	PART NUMBER	FREE SPEED rpm	POWER		COLLET CAPACITY		AIR CONS. @LOAD		NET WEIGHT		LENGTH		VIBRATION LEVEL ISO 28927 (m/s ²)		SOUND PRESS. ISO 15744 - dB(A)	SOUND POWER	AIR INLET
			hp	W	in.	mm	cfm	l/s	lb	kg	in.	mm	a	k			
CP860	T019704	24000	0.5	370	1/4	-	20.9	10	1.2	0.5	5.7	146	3.7	1.6	93	102	1/4
CP860E	T021136	24000	0.5	370	-	6	20.9	10	1.2	0.5	5.7	146	3.7	1.6	93	104	1/4
CP860ES	T023193	24000	0.5	370	1/4	-	23.1	11	1.2	0.5	11.7	294	3.7	1.5	93	104	1/4
CP9113G	615 160 0010	25000	1.0	750	1/4	6.35	31.8	15	2.5	1.1	6.7	170	3.6	1.8	93	104	1/4
CP9113GES	615 160 2070	25000	1.0	750	1/4	6.35	31.8	15	3.5	1.6	12.6	320	2.7	1.1	82	94	1/4
CP3000-515R	615 160 0270	15000	0.7	500	1/4	6.35	25.4	12	1.8	0.8	7.6	195	<2.5	-	81	92	1/4
CP3000-518R	615 160 0280	18000	0.7	500	1/4	6.35	27.5	13	1.8	0.8	7.6	195	<2.5	-	80	91	1/4
CP3000-520R	615 160 0290	20000	0.7	500	1/4	6.35	27.5	13	1.8	0.8	7.6	195	<2.5	-	81	92	1/4
CP3030-518R	615 160 4190	18000	0.7	500	1/4	6.35	27.5	13	1.8	0.8	6.8	174	<2.5	-	81	92	1/4
CP3030-520R	615 160 4200	20000	0.7	500	1/4	6.35	29.6	14	1.8	0.8	6.8	174	<2.5	-	80	91	1/4

All models: Hose int. 1/2" (13mm) - @90 PSI (@6.3 Bar)

Listed specifications are for reference only. Please check documents in each tool.

Grinding

Straight & Wheel grinders

CP3451-18SEC

18,000 rpm



HIGH PERFORMANCE

CP3451-16SE25

Similar features as CP3451-18SEC with 2.5" wheel capacity and 16000 rpm

FEATURES

- 1/4" (6.35 mm) collet holder
- 1 hp (750 W) high torque motor
- 18000 rpm free speed
- Aluminium body
- Insulating composite cover
- Rear exhaust

CP3451-18SE3

Same features as CP3451-18 SEC with 3" wheel capacity

BENEFITS

- Light body
- Powerful motor



See accessories on page 30

CP3119-22ES

22,000 rpm



CP3119-XXES HIGH PERFORMANCE

Same features as CP3119-22ES from 12000 to 18000 rpm

FEATURES

- 1/4" (6.35 mm) collet holder
- Extended body with rubber grip
- 1.2 hp (900 W) governed motor
- 22000 rpm free speed
- Steel housing
- Insulating composite over-housing
- Streamlined safety lever
- Rear exhaust

CP3119-12EL

Similar features as CP3119-18ES with 12000 rpm and 15" extended shaft

CP3119-12EXL

Same features as CP3119-18ES with 12000 rpm and 25" extended shaft

BENEFITS

- Superior productivity
- High ergonomics
- Maximal Industrial durability

CP3119-12ES4

12,000 rpm



CP3119-12ES3 HIGH PERFORMANCE

Same features as CP3119-12ES4 with 3" wheel capacity

FEATURES

- 4" / 100 mm wheel capacity
- Extended body with rubber grip
- 1.2 hp (900 W) governed motor
- 12000 rpm free speed
- Steel housing
- Insulating composite over-housing
- Streamlined safety lever
- Rear exhaust

BENEFITS

- Superior productivity
- High ergonomics
- Maximal Industrial durability

MODEL	PART NUMBER	FREE SPEED		POWER		COLLET CAPACITY		SPINDLE THREAD		MAX WHEEL CAPACITY		AIR CONS. @LOAD		NET WEIGHT		LENGTH		VIBRATION LEVEL (m/s ²)		SOUND PRESS.	SOUND POWER	AIR INLET
		rpm	hp	W	in.	mm	in.	mm	cfm	l/s	lb	kg	in.	mm	a	k	ISO 15744 - dB(A)	BSP				
CP3451-18SEC	615 160 2010	18000	1	750	1/4	6.35	-	-	-	36.8	17	3.1	1.4	13/13.5	330/343	2.7	1.8	83.8	95	3/8		
CP3451-16SE25	615 160 2020	16000	0.8	600	-	-	3/8x24	2.5	63	27.7	13	4.2	1.9	13.8	346	10.0	5.0	83	94	3/8		
CP3451-18SE3	615 160 2030	18000	1.0	750	-	-	3/8x24	3.0	80	36.8	17	4.2	1.9	14.0	351	3.1	1.2	84	95	3/8		
CP3119-12ES	615 160 2110	12000	1.2	900	1/4	6.35	-	-	-	33.9	16	3.1	1.4	14.2	361	2.5	-	76	87	3/8		
CP3119-15ES	615 160 2120	15000	1.2	900	1/4	6.35	-	-	-	36.0	17	3.1	1.4	14.2	361	2.5	-	81	92	3/8		
CP3119-18ES	615 160 2130	18000	1.2	900	1/4	6.35	-	-	-	38.1	18	3.1	1.4	14.5	363	2.5	-	80	91	3/8		
CP3119-22ES	615 160 2140	22000	1.2	900	1/4	6.35	-	-	-	38.1	18	3.1	1.4	14.2	361	2.6	0.7	81	92	3/8		
CP3119-12EL	615 160 2150	12000	1.2	900	1/4	6.35	-	-	-	33.9	16	4.6	2.1	24.1	603	2.9	1.3	74	85	3/8		
CP3119-12EXL	615 160 2160	12000	1.2	900	1/4	6.35	-	-	-	33.9	16	5.9	2.7	34.1	853	3.0	1.8	74	85	3/8		
CP3119-12ES4	615 160 6020	12000	1.2	900	-	-	3/8x24	4.0	100	33.9	16	4.0	1.8	13.3	338	2.5	-	78	89	3/8		
CP3119-12ES3	615 160 6010	12000	1.2	900	-	-	3/8x24	3.0	80	33.9	16	3.7	1.7	13.3	338	3.4	-	81	92	3/8		

All models: Hose int. 1/2" (13mm) - @90 PSI (@6.3 Bar)

Listed specifications are for reference only. Please check documents in each tool.

CP9120-CR

12,000 rpm



CP9121-BR

12,000 rpm



CP9122-BR

LIGHTWEIGHT & EASY HANDLING

Same features as CP9120-CR with 4.5" (115mm) wheel capacity and 3/8"-24 spindle thread

FEATURES

- 4" (100 mm) heavy-duty angle grinder
- Powerful 0.7 hp (700 W) high performance motor
- Adjustable protective guard
- Aluminum alloy housing
- Spiral bevel gears
- Ergonomic side handle

BENEFITS

- Lightweight but rugged housing
- Durability and performance
- Excellent for weld preparation and smoothing, rust removal, deburring and blending steel, cast iron and aluminum

CP9122-CR

Same features as CP9120-CR with 4.5" (115mm) wheel capacity and 3/8"-24 spindle thread

CP9121-CR

LIGHTWEIGHT & EASY HANDLING

Same features as CP9121-BR with 3/8"-24 spindle thread

FEATURES

- 5" (125 mm) heavy-duty angle grinder
- 5/8"-11 spindle thread
- Powerful 0.7 hp (700 W) high performance motor
- Adjustable protective guard
- Aluminum alloy housing
- Spiral bevel gears
- Ergonomic side handle

CP9121-AR

Same features as CP9121-BR with M14 spindle thread

BENEFITS

- Lightweight but rugged housing
- Durability and performance
- Excellent for weld preparation and smoothing, rust removal, deburring and blending steel, cast iron and aluminum

CP854

12,000 rpm



EFFICIENT & DURABLE

CP854 E

Same features as CP854 with 5" (125 mm) max wheel capacity and M10 spindle thread

FEATURES

- 4" (100 mm) heavy-duty angle grinder
- Powerful 0.6 hp (450 W) high performance motor
- Aluminum alloy housing, yet lightweight tool
- Spiral bevel gearing in angle

BENEFITS

- Efficient with fast material removal
- Extended life and smooth low vibrations
- Rugged but lightweight tool for maximum operator comfort
- Excellent for weld preparation and smoothing, rust removal, deburring and blending steel, cast iron and aluminum



CP9121-BR



See accessories on page 30

MODEL	PART NUMBER	FREE SPEED	POWER		MAX WHEEL CAPACITY		SPINDLE THREAD	AIR CONS. @LOAD		NET WEIGHT		LENGTH		VIBRATION LEVEL ISO 28927 (m/s ²)		SOUND PRESS.	SOUND POWER	AIR INLET
		rpm	hp	W	in.	mm		cfm	l/s	lb	kg	in.	mm	a	k			
CP9120CR	615 195 2120	12000	0.8	600	4.0	100	3/8-24	23.3	11	4.1	1.9	9.3	233	5.3	1.6	84	95	1/4
CP9122CR	615 195 2122	12000	0.8	600	4.5	115	3/8-24	29.6	14	4.1	1.9	9.3	233	5.4	1.0	84	95	1/4
CP9121BR	615 195 7221	12000	0.8	600	5.0	125	3/8-24	27.5	13	4.6	2.1	9.6	240	8.6	4.6	84	95	1/4
CP9121CR	615 195 2121	12000	0.8	600	5.0	125	-	25.4	12	4.6	2.1	9.6	240	11.2	3.4	84	95	1/4
CP9121AR	615 195 7321	12000	0.8	600	5.0	125	M14	27.5	13	4.6	2.1	9.6	240	6.7	2.2	84	95	1/4
CP854	T023186	12000	0.7	450	4.0	100	3/8-24	24.0	11.3	3.7	1.7	9.0	229	4.9	1.5	85	96	1/4
CP854E	T023187	12000	0.7	450	5.0	125	M10	16.0	7.5	3.7	1.7	9.0	229	4.9	1.5	85	96	1/4

All models: Hose int. 1/2" (13mm) - @90 PSI (@6.3 Bar)

Listed specifications are for reference only. Please check documents in each tool.

Grinding

Angle grinders

CP3040GABTIM

13,500 rpm



CP3040 GASTIM

Same features as CP3040 GABTIM with 2,3" extended shaft

ROBUST CONSTRUCTION

FEATURES

- 4" (100 mm) wheel capacity
- Short body
- 1 hp (750 W) governed motor
- 13500 rpm free speed
- Robust machined steel housing
- Robust safety lever
- Side exhaust

BENEFITS

- High durability

CP3450-12AB5

12,000 rpm



CP3450-12AA5

Same features as CP3450-12AB5 with M14 Spindle Thread

INDUSTRIAL GRADE ANGLE GRINDER

FEATURES

- 5" (125 mm) wheel capacity
- 1.1 hp (810 W) high torque motor
- 12000 rpm free speed
- 5/8" spindle
- Constant lubrication bevel gear design
- Aluminium body
- Insulating composite cover
- Orientable safety lever
- Optional low vibration side handle
- Rear exhaust

BENEFITS

- Industrial grade productivity
- Industrial bevel gear durability
- Light body



CP857

7,500 rpm



POWERFUL & DURABLE

FEATURES

- 7" (180 mm) Heavy-duty angle grinder
- Powerful 1.25 hp (932 W) high performance motor
- Aluminum alloy housing, yet lightweight tool
- Spiral bevel gearing in angle

BENEFITS

- Efficient with fast material removal
- Extended life and smooth low vibrations
- Rugged but lightweight tool for maximum operator comfort
- Excellent for weld preparation and smoothing, rust removal, deburring and blending steel, cast iron and aluminum



See accessories on page 30

MODEL	PART NUMBER	FREE SPEED			POWER		MAX WHEEL CAPACITY		SPINDLE THREAD	AIR CONS. @LOAD		NET WEIGHT		LENGTH		VIBRATION LEVEL ISO 28927 (m/s²)		SOUND PRESS.	SOUND POWER	AIR INLET
		rpm	hp	W	in.	mm	in.	cfm	l/s	lb	kg	in.	mm	a	k	ISO 15744 - dB(A)	NPT			
CP3040GABTIM	615 160 7010	13500	1.0	750	4	100	3/8-24	26.5	12.5	3.4	1.5	8.3	210	7.2	2.4	87	98	1/4		
CP3040GASTIM	615 160 7020	13500	1.0	750	4	100	3/8-24	26.5	12.5	3.7	1.7	10.6	270	9.6	3.3	91	102	1/4		
CP3450-12AB5	615 160 4050	12000	1.0	750	5	125	5/8-11	36.0	17.0	3.7	1.7	9.2	230	8.5	2.8	94	105	3/8 BSP		
CP3450-12AA5	615 160 4040	12000	1.0	750	5	125	M14x2	36.0	17.0	3.7	1.7	9.2	230	8.1	2.8	94	105	3/8 BSP		
CP857	T024387	7500	1.2	930	7	180	5/8-11	24.0	11.3	6.2	2.8	13.1	334	3.9	1.2	102	113	1/4		

All models: Hose int. 1/2" (13mm) - @90 PSI (@6.3 Bar)

Listed specifications are for reference only. Please check documents in each tool.

CP3850-85AB7VE

8,500 rpm



NOT FOR NORTH AMERICA
AND ANSI MARKET



CP3850-77 AB7V

FOR NORTH
AMERICA AND
ANSI MARKET

Same features as
CP3850-85AB7VE
with 7700 rpm

HIGHEST PERFORMANCE & ERGONOMICS

FEATURES

- 7" (180 mm) wheel capacity
- 2.8 hp (2100 W) high performance governed motor
- 8500 rpm free speed
- Superior durability bevel gear
- Double action safety lever
- Integrated silencer
- Orientable exhaust
- Auto balancer
- Vibration damping multi-position side handle

BENEFITS

- Highest durability in demanding applications
- Superior torque for maximal productivity
- Superior ergonomics

CP3850-65AB9VE

6,500 rpm



NOT FOR NORTH AMERICA
AND ANSI MARKET



HIGHEST PERFORMANCE & ERGONOMICS

FEATURES

- 9" (230 mm) wheel capacity
- 2.8 hp (2100 W) high performance governed motor
- 6500 rpm free speed
- Superior durability bevel gear
- Double action safety lever
- Integrated silencer
- Orientable exhaust
- Auto balancer
- Vibration damping multi-position side handle

BENEFITS

- Highest durability in demanding applications
- Superior torque for maximal productivity
- Superior ergonomics

CP3349 SALAVELE

6,500 rpm



NOT FOR NORTH AMERICA
AND ANSI MARKET



CP3349 SALAVADE

Same features as
CP3349 SALAVELE with
7" (180mm) wheel

PERFORMANCE IN HEAVY APPLICATIONS

FEATURES

- 9" (150 mm) cup wheel capacity
- 4 hp (3000 W) high performance governed motor
- 6500 rpm free speed
- Robust housing
- Built-in lubricant tank
- Double action safety lever

BENEFITS

- Highest durability in demanding applications
- Superior torque for maximal productivity

CP3349 SALAVETE

Same features as
CP3349 SALAVELE with
6" (150mm) cup wheel
capacity



CP3850-85AB7VE



See accessories on page 30

MODEL	PART NUMBER	FREE SPEED	POWER		MAX WHEEL CAPACITY DxExd		SPINDLE THREAD	AIR CONS. @LOAD		NET WEIGHT		LENGTH		VIBRATION LEVEL ISO 28927 (m/s ²)		SOUND PRESS.	SOUND POWER	AIR INLET
		rpm	hp	W	in.	mm	in.	cfm	l/s	lb	kg	in	mm	a	k	ISO 15744 - dB(A)		NPT
CP3850-85AB7VE	615 1704 920	8500	2.8	2100	7	180	5/8"-11	77	36	5.9	2.7	13.4	340	5.7	1.1	87	98	1/2 BSP
CP3850-77AB7V	615 1704 960	7700	2.8	2100	7	180	5/8"-11	69	32	6.6	3	13.4	340	5.3	1.1	84	96	1/2
CP3850-65AB9VE	615 1704 940	6500	2.8	2110	9	230	5/8"-11	80	38	6.4	2.9	13.4	340	5.7	1.1	93	104	1/2 BSP
CP3349-SALAVELE	615 1609 130	6500	4.0	3000	9	230	5/8"-11	93	44	4.4	9.7	11.0	280	4.6	1.4	87	98	1/2
CP3349-SALAVADE	615 1609 110	7700	4.0	3000	7	130	5/8"-11	97	46	4.2	9.2	11.0	280	5.1	1.5	88	99	1/2
CP3349-SALAVETE	615 1609 150	6000	4.0	3000	6	150	5/8"-11	91	43	4.4	9.7	11.0	280	<2.5	-	84	95	1/2





All models: Hose int. 1/2" (13mm) - @90 PSI (@6.3 Bar)

Listed specifications are for reference only. Please check documents in each tool.

Grinding

Accessories & Spares

ACCESSORIES INCLUDED



MODEL	DESCRIPTION	PART NO.
 CP3000-5..R/F	Series 200 collet, ø 1/4" (5.55 to 6.35mm)	205 054 8193
 CP3000-4..R/F	Flat wrench	205 054 8193
 CP3030-5..R/F	Wrench (2)	205 054 8193
 CP3000-600CR	Collet ø 3mm	205 054 8563
	Wrench	205 054 8083

MODEL	ITEM	DESCRIPTION	PART NO.
	1	ø 4" (100mm) Guard Disc	205 054 5213
	2	Rear flange 5/8"	205 055 2633
	2	Rear flange 3/8"	205 054 4263
	3	Flange nut 5/8"	205 055 2643
	3	Flange nut 3/8"	205 054 4273
	.	Spanner Wrench (for 3/8" flange)	205 054 4293
	.	Pin Wrench (for 3/8" flange)	205 054 4283
	.	Spanner Wrench (for 3/8" flange)	205 054 4303
	.	Spanner Wrench (for 5/8" flange)	205 055 2953
	.	Pin wrench (for 5/8" flange)	205 055 2943

MODEL	ITEM	DESCRIPTION	PART NO.
	1	Series 200 collet ø1/4" (5.55 to 6.35mm)	615 526 0630
	2	Exhaust hose	615 432 0110
	3	Cone wheel adaptor	615 542 1330
	4	Stem	615 801 0810
	.	Wrench (2)	205 049 6453

MODEL	DESCRIPTION	PART NO.
	Series 200 collet, ø1/4" (5.55 to 6.35mm)	615 526 0630
	Exhaust hose L= 31" (0.8m)	615 875 1130
	Flat wrench, (14mm)	615 801 0050
	Flat wrench, 3/4" (19mm)	615 801 0760

MODEL	DESCRIPTION	PART NO.
	Series 200 collet, ø 1/4" (5.55 to 6.35mm)	615 526 0630
	Flat wrench	205 054 4513
	Flat wrench	205 054 4523

MODEL	ITEM	DESCRIPTION	PART NO.
	1	7" (180mm) Disc Guard	615 504 1820
	2	Rear flange	615 503 1030
	3	Nut	615 542 1040
	4	Locknut	615 614 0340
	.	Pin Wrench	615 802 0100
	1	9" (230mm) Disc Guard	615 504 1830
	2	Rear flange	615 503 1030
	3	Nut	615 542 1040
	4	Locknut	615 614 0340
	.	Pin Wrench	615 802 0100
	1	6" (150mm) Disc Guard	615 504 1810
	2	Rear flange	615 503 1160
	3	Locknut	615 614 0340
FOR ALL CP3349		Flat wrench	615 801 0770
		Hex. key	615 802 0560

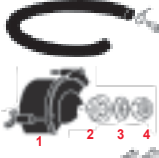
MODEL	ITEM	DESCRIPTION	PART NO.	
	All model	Exhaust hose L= 31" (0.8m)	615 875 1130	
	CP3119-12ES3 CP3119-12ES3X	1	3" (80mm) Disc Guard	615 504 1510
		2	Rear flange 3/8"	615 503 1250
3		Front flange 3/8"	615 502 0130	

MODEL	ITEM	DESCRIPTION	PART NO.	
	CP3119-12ES4	1	4" (100mm) Disc Guard	615 504 1520
		2	Rear flange 3/8"	615 503 1310
		3	Front flange 3/8"	615 502 0630
		4	Locknut	615 608 0440
FOR ALL CP3119-12ES		Flat wrench, 9/16" (14.3mm)	615 801 0740	
		Flat wrench, 3/4" (19mm)	615 801 0760	

MODEL	ITEM	DESCRIPTION	PART NO.	
	CP3451-16SE25	1	2-1/2" (63mm) Disc Guard	615 504 1890
		2	Rear flange	615 503 1610
		3	Front flange	615 502 0800

MODEL	ITEM	DESCRIPTION	PART NO.	
	CP3451-18SE3	1	3" (80mm) Disc Guard	615 504 1910
		2	Rear flange	615 503 1620
		3	Front flange	615 502 0790
		4	Locknut	615 605 0950
FOR ALL CP3451		Flat wrench (2)	205 049 6453	

FOR ALL CP3850: accessories, look at www.cp.com

TUNE-UP KITS

MODEL	TUNE-UP KIT	MODEL	TUNE-UP KIT
CP9106Q-B	205 050 6743	CP3000-600CR	205 054 8613
CP9105Q-B	205 050 6703	CP3000-...	205 054 6403
CP9108Q-B	205 050 6763	CP3000-4..	205 054 7863
CP9110Q-B	205 050 6603	CP3000-5..	205 054 7923
CP9120CR	205 050 4823	CP3019-..AC	205 054 2133
CP9122BR	205 050 4823	CP3109-13AC.	205 054 1673
CP9122CR	205 050 4823	CP3030-3..	205 054 6403
CP9121BR	205 050 4823	CP3030-4..	205 054 7863
CP9121CR	205 050 4823	CP3030-5..	205 054 7923
CP9121AR	205 050 4823	CP3451-..	615 397 3030
CP3019-..	205 054 2133	CP3450-..	615 397 3030



Finishing



Belt Sanders

To suit your finishing edge applications in restricted areas.

Finishing Sanders

Various solutions for your narrow spots or surface finishing fitting your requirements.

How to select your finishing tool?

Step 1

Applications

- ▶ Materials type
- ▶ Finishing type
- ▶ Treatment type
- ▶ Duty

Step 2

Abrasives

- ▶ Shapes
- ▶ Grid size
- ▶ Process
- ▶ Rotation type
- ▶ Access

Step 3

Tools

- ▶ Handling Shape
- ▶ Pad / Belt Size
- ▶ Speed

Finishing

CP7200

15,000 rpm



CP7200S KIT

See details on page 34



SMART SANDING REPAIR

FEATURES

- Mini pistol random orbital sander with 2" (50 mm) and 3" (75 mm) H&L pads
- Adjustable power regulator
- 2-fingered progressive throttle

BENEFITS

- Compact & lightweight
- Maximize operator control and ergonomics, less fatigue
- Excellent for small area repair

CP3070-120G

12,000 rpm



5" PISTOL SANDER

FEATURES

- Heavy-duty 5" (125 mm) sander
- High power 0.5hp (370 W)
- Low noise and vibrations

BENEFITS

- High durability
- Ergonomics - Compact & easy handling
- Ideal for vertical sanding or tight area work

CP870

10,000 rpm



DUAL ACTION SANDER

FEATURES

- General-duty sander with rotary or random orbital options
- PSA sanding pad
- Insulated grip and lock off throttle to prevent accidental start ups
- Power regulator for precise control

BENEFITS

- Operator comfort
- Excellent for blending and smoothing filler, feather edging and pre-paint preparation



See accessories on page 34

MODEL	PART NUMBER	FREE SPEED		POWER		PAD CAPACITY		AIR CONS. @LOAD		NET WEIGHT		LENGTH		VIBRATION LEVEL ISO 28927 (m/s ²)		SOUND PRESS. ISO 15744 - dB(A)	SOUND POWER	AIR INLET
		rpm	hp	W	in.	mm	cfm	l/s	lb	kg	in.	mm	a	k				
CP7200	894 107 2001	15000	0.2	150	2 & 3	50 & 75	21	9.9	1.5	0.6	4.7	120	5.9	2.0	87	98	1/4	
CP3070-120G	615 162 0090	12000	0.5	375	5	125	22	10.5	2.2	1.0	6.9	175	<2.5	-	84	95	1/4	
CP870	T023990	10000	0.5	375	6	150	18	7.6	4.2	1.9	4.3	193	13.6	4.3	83	94	1/4	

All models: Hose int. 3/8" (10mm) - @90 PSI (@6.3 Bar)

Listed specifications are for reference only. Please check documents in each tool.

CP9780

20,000 rpm

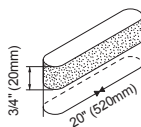

EASY HANDLING & LARGE REMOVAL

FEATURES

- Heavy-duty belt sander 3/4" (20 mm) capacity
- Quick-change belt replacement
- Adjustable sanding arm
- Rubber molded grip

BENEFITS

- Operator comfort
- Excellent for paint removal, weld sanding, smoothing and rust removal in tight areas

CP9779

Similar features as CP9780 with 22000 rpm and 3/8" (10 mm) / 13" (330 mm) belt size

CP858

18,000 rpm

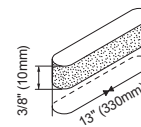

PRODUCTIVITY & DURABILITY

FEATURES

- Belt sander 3/8" (10 mm) capacity
- Quick change belt replacement
- Adjustable sanding arm

BENEFITS

- Excellent for paint removal, weld sanding, smoothing and rust removal in tight areas

CP5080-5220H18

22,000 rpm

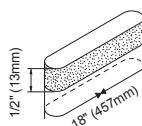

HEAVY-DUTY BELT SANDERS

FEATURES

- 18" (457 mm) belt sander 0.8 hp (560 W)
- Sanding head pivots 360° for multi position sanding
- Easy change of abrasives and contact arm

BENEFITS

- More power for faster material removal and Ergonomic handle
- High durability thanks to simple and robust design
- Ideal for heavy sanding applications

CP5080-3260D12

Same features as CP5080-5220H18 with 26000 rpm and 1/2" (13 mm) / 12" (305 mm)

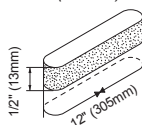

CP5080-3260D12K

See details on page 34



See accessories on page 34

CP5080-4200H18

20,000 rpm

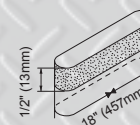

HEAVY-DUTY BELT SANDER

CP5080-4200D24 FEATURES

Same features as CP5080-4200H18 with 1/2" (13 mm) / 18" (457 mm) belt capacity

- 18" (457 mm) belt sander 0.5 hp (400 W)
- Sanding head pivots 360° for multi position sanding
- Easy change of abrasives and contact arm

BENEFITS

- Ergonomic handle and high speed
- High durability thanks to simple and robust design
- Ideal for versatile sanding applications



CP5080-4200H18K

See details on page 34

MODEL	PART NUMBER	FREE SPEED		POWER		BELT CAPACITY L x W		AIR CONS. @LOAD		NET WEIGHT		LENGTH		VIBRATION LEVEL ISO 28927 (m/s ²)		SOUND PRESS.	SOUND POWER	AIR INLET
		rpm	hp	W	in.	mm	cfm	l/s	lb	kg	in.	mm	a	k	ISO 15744 - dB(A)	NPT		
CP9780	615 193 9780	20000	0.4	300	3/4x20	20x520	30	14.1	3.3	1.5	15.0	380	<2.5	-	91	102	1/4	
CP9779	615 193 9779	22000	0.3	220	3/8x13	10x330	28	13.2	1.9	0.9	12.0	304	<2.5	-	91	102	1/4	
CP858	T025179	18000	0.4	300	3/8x13	10x330	22	10.4	1.9	0.8	12.0	304	<2.5	-	93	104	1/4	
CP5080-5220H18	615 162 0030	22000	0.8	560	1x18	25x457	27	12.8	3.3	1.5	13.4	340	<2.5	-	84	95	1/4	
CP5080-4200D24	615 162 0010	20000	0.5	400	1/2x24	13x610	21	10.2	3.1	1.4	15.3	390	<2.5	-	78	89	1/4	
CP5080-4200H18	615 162 0020	20000	0.5	400	1/2x18	16x457	21	10.3	2.8	1.3	13.4	340	<2.5	-	80	91	1/4	
CP5080-3260D12	615 162 0000	26000	0.4	300	1/2x12	13x305	18	8.4	1.7	0.7	11.4	280	<2.5	-	82	93	1/4	

All models: Hose int. 3/8" (10mm) - @90 PSI (@6.3 Bar)

Listed specifications are for reference only. Please check documents in each tool.

Finishing

Kits, Accessories & Spares



CP7200S Kit

Part No. 894 117 2001

Kit includes:

- (1) CP7200S, Mini random orbital sander
- (1) 2" (50mm) and 3" (75mm) backing pads
- (10) 2" (50mm) 320, 400 and 600 grit sand paper and spindle key packed in heavy duty carrying case

CP5080-3260D12K

Part No. 615 162 0050

Kit includes:

- (1) CP5080-3260D12
- (1) Contact arm 1/8" x 12" (3x305mm)
- (1) Contact arm 1/4" x 12" (6x305mm)
- (1) Bag of 5 belts



CP5080-4200H18K

Part No. 615 162 0040

Kit includes:

- (1) CP5080-4200H18
- (1) Contact arm 1/4" x 18" (6x457mm)
- (1) Contact arm 1" x 18" (25x457 mm)
- (1) Handle
- (1) Bag of 5 belts
- (1) Hex key



SANDING PADS

MODEL	DESCRIPTION	PART NUMBER
CP7200S	ø 3" (75mm) Pad H&L w/o hole	894 015 8330
CP7200S	ø 2" (50mm) Pad H&L w/o hole	894 015 8334

SANDING PAPER

MODEL	DESCRIPTION	PART NUMBER
CP7200S	ø 2" (50mm)-320 Grit (50 pc) - H&L	894 015 8677
CP7200S	ø 2" (50mm)-400 Grit (50 pc) - H&L	894 015 8678
CP7200S	ø 2" (50mm)-600 Grit (50 pc) - H&L	894 015 8679
CP7200S	ø 3" (75mm)-320 Grit (50 pc) - H&L	894 015 8680
CP7200S	ø 3" (75mm)-400 Grit (50 pc) - H&L	894 015 8681
CP7200S	ø 3" (75mm)-600 Grit (50 pc) - H&L	894 015 8682

BELT SANDERS - BAGS OF 10 BELTS

DESCRIPTION	PART NUMBER
Belt Sanding 330X10 Gr60	894 016 9003
Belt Sanding 330X10 Gr80	894 016 9004
Belt Sanding 330X10 Gr120	894 016 9006
Belt Sanding 330X10 Gr60	894 016 9003
Belt Sanding 330X10 Gr80	894 016 9004
Belt Sanding 330X10 Gr100	894 016 9005
Belt Sanding 330X10 Gr120	894 016 9006
Belt Sanding 520X20 Gr60	894 016 9007
Belt Sanding 520X20 Gr80	894 016 9008
Belt Sanding 520X20 Gr100	894 016 9009
Belt Sanding 520X20 Gr120	894 016 9010

CP5080-3260D12 - 12" (305mm)



GUARD SUPPORT	PART NO.
12" (305mm) Belt	205 054 5513
CONTACT ARM	PART NO.
1/2"x12" (13x305mm) - 5/8" (16mm) Diam	205 054 5523
1/2"x12" (13x305mm) - 5/16" (8mm) Diam	205 054 5533
1/8"x12" (3x305mm)	205 054 5543
1/4"x12" (6x305mm)	205 054 5553

WHEEL ASSEMBLY	PART NO.	PLATTEN PAD SET	PART NO.
1/2" (13mm) - 5/8" (16mm) Diam.	205 054 6443	1/2" x 1.97" (12.5 x 50mm)	205 054 6243
1/2" (13mm) - 5/16" (8mm) Diam.	205 055 0283	1/2" x 1-15/16" (12.5 x 49mm)	205 054 6233
1/8" (3mm)	205 054 6473	5/16" x 2.05" (7.5 x 52mm)	205 054 6253
1/4" (6mm)	205 054 6493		

CP5080-4200H18 & CP5080-5220H18 - 18" (457mm)



GUARD SUPPORT	PART NO.
18" (457mm) Belt	205 054 5443
18" (457mm) Belt with side handle	205 054 7953
CONTACT ARM	PART NO.
5/8" to 3/4" x 18" (16 to 19 x 457mm)	205 054 5453
1/2" x 18" (13 x 457mm)	205 054 5463
1/8" to 1/2" x 18" (3 to 13 x 457mm)	205 054 5473
1/2" x 18" (13 x 457mm)	205 054 5483
1/4" x 18" (6 x 457mm)	205 054 5493
1" x 18" (25 x 457mm)	205 054 5503

WHEEL ASSEMBLY	PART NO.	PLATTEN PAD SET	PART NO.
5/8" (16mm)	205 054 6433	3/4" x 2-1/8" (19.5 x 54mm)	205 054 6263
1/2" (13mm)	205 055 0273	11/16" x 1-15/16" (17.5 x 49mm)	205 054 6273
1/8" (3mm)	205 054 6473	1/2" x 2-1/8" (12.5 x 54mm)	205 054 6283
1/2" (13mm)	205 054 6483	5/16" x 2.05" (7.5 x 52mm)	205 054 6253
1/4" (6mm)	205 054 6493	26 x 55	205 054 6293
1" (25mm)	205 054 6423		

CP5080-4200D24 - 24" (610mm)



GUARD SUPPORT	PART NO.
24" (610mm) Belt	205 054 5413
CONTACT ARM	PART NO.
1/2"x24" (13x610mm)	205 054 5423
1/4" to 2"x24" (6 to 50x610mm)	205 054 5433

WHEEL ASSEMBLY	PART NO.
1/2" (13mm)	205 054 6443
1/4" (6mm)	205 054 6473
PLATTEN PAD SET	PART NO.
1/2" x 1.97" (12.5x50mm)	205 054 6243

TUNE-UP KITS

MODEL	TUNE-UP KIT
CP9779	205 050 3853
CP9780	205 050 3863
CP5080-3260..	205 054 6403
CP5080-4200..	205 054 7863
CP5080-5220..	205 054 7923
CP3070-120G	205 054 8293
CP870	CA144954



Drilling



Pistol grip drills

- Ideal for all drilling tasks
- Maintenance up to very intensive duties
- Drilling hole capacity up to 1/2" (13mm) diameter in steel
- Extra-support side handle recommended for better handling with larger drilling capacity and higher torque

Angle drills

- Ideal for restricted access application
- Drilling hole capacity to 3/8" (10mm) dia. (in steel)

Straight drills

- Mainly smaller diameter drilling less than 3/8" (10mm) diameter (in steel)
- Preferred for vertical drilling

How to select your drill tool?

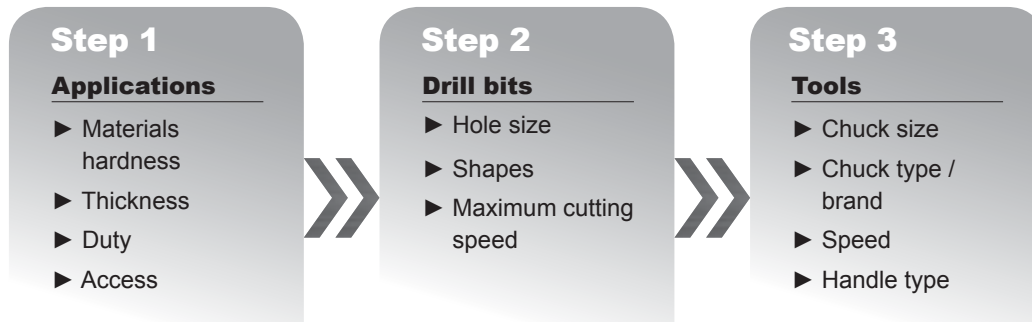

MATERIAL		Stainless Steel	Forged Steel	Mild Steel	Soft Cast Iron	Malleable Iron	Brass or Bronze	Aluminum	Magnesium	Plastic	Wood	Titanium
DRILL BIT SIZE		CUTTING SPEED (m/min.)										
in.	mm	9-12	12-15	24-33	30-45	24-27	60-90 rpm	60-90	75-120	30-45	90-120	15-18
1/8	3	1100	1400	3000	4000	2700	8000	8000	10400	4000	11000	1750
5/32	4	840	1100	2200	3000	2000	6000	6000	7800	3000	8400	1300
3/16	5	660	860	1800	2400	1600	4800	4800	6200	2400	6700	1050
1/4	6	550	700	1500	2000	1350	4000	4000	5200	2000	5600	880
5/16	8	420	540	1100	1500	1000	3000	3000	3900	1500	4200	660
3/8	10	330	430	900	1200	800	2400	2400	3100	1200	3300	630
15/32	12	280	350	750	1000	700	2000	2000	2600	1000	2800	440
1/2	13	260	330	700	920	630	1800	1800	2400	920	2550	400
9/16	14	240	300	640	850	580	1700	1700	2200	850	2400	370
5/8	16	210	270	560	750	500	1500	1500	1950	750	2100	330
3/4	19	180	230	480	630	430	1250	1250	1600	630	1800	280
7/8	22	150	200	410	540	370	1100	1100	1400	540	1500	240
29/32	23	140	190	390	520	350	1000	1000	1350	520	1450	230
1	25	130	170	360	480	320	960	960	1250	480	1330	210
1-1/8	28	120	150	320	420	290	850	850	1100	420	1200	190
1-1/4	32	100	130	280	380	250	750	750	980	380	1050	160
55/32	44	75	100	210	270	180	550	550	700	270	750	120
2	50	65	85	180	240	160	480	480	620	240	670	110
3	75	44	57	120	160	110	320	320	420	160	450	70
4	100	33	43	90	120	80	240	240	310	120	330	55

To reduce the risk of injury, everyone using, installing, repairing, maintaining, changing accessories on, or working near CP Tools must read and understand CP safety instructions packed with each tool.

Drilling

Drills

CP7300R



1/4" 6mm 2,700 rpm



COMPACTNESS & COMFORT

FEATURES

- 1/4" (6 mm) reversible compact drill
- Ergonomic grip and lightweight, only 1.35 lbs (0.6 kg)
- Progressive throttle
- Industrial quality Jacobs chuck

BENEFITS

- Fast, efficient and great for tight areas with its size
- Excellent precision to allow for very slow start-up and control throughout the drilling process
- Excellent for drilling, honing, reaming, and hole sawing

CP7300RQC

Same features as CP7300R with quick chuck

CP7300R Kit

See details on page 38

CP7300R Kit Metric

See details on page 38

CP887



3/8" 10mm 2,500 rpm

POWERFUL IN-LINE

FEATURES

- 3/8" (10 mm) in-line drill
- High performance Jacobs chuck
- Built-in regulator for efficient control

BENEFITS

- Powerful and fast
- Durability and productivity
- Perfect tool for vertical drilling and to reach confined areas

CP879

Similar features as CP887 with angle head shape & 800 rpm



See accessories on page 38

CP1014P45

1/4" 6mm 4,500 rpm



0,5HP 4500 RPM
1/4" KEY CHUCK

FEATURES

- 1/4" (6mm) industrial pistol drill with Jacobs keyed chuck
- Excellent power to weight ratio with 0,5hp (375W) motor
- Teasing throttle for progressive and safety control
- Exclusive handle with double wings for precise drilling
- Durable gearbox reducing maintenance cost and downtime

CP1114P33

Similar features as CP1014P45 with 3300 rpm

CP1114P24

Similar features as CP1014P45 with 2400 rpm

BENEFITS

- Operator comfort thanks to exclusive ergonomic features
- Compact shape & light weight for easy handling and access
- Designed for intensive duty and high durability



CP789R-26

3/8" 10mm 2,600 rpm



SUPER-DUTY & EFFICIENCY

FEATURES

- 3/8" (10 mm) reversible pistol drill
- Powerful with 0.5 hp (375 W) motor
- Teasing throttle and high-speed precision drilling
- Industrial quality Jacobs chuck

BENEFITS

- Maximize operator comfort
- Productivity coupled with extreme durability
- Great tool for screw driving, honing and heavy drilling

CP789R-42

Similar features as CP789R-26 with 4200 rpm

MODEL	PART NUMBER	FREE SPEED		POWER		CHUCK CAPACITY		MAXIMUM TORQUE		NET WEIGHT		LENGTH		AIR CONS. @LOAD		VIBRATION LEVEL ISO 28927 (m/s ²)		SOUND PRESS.	SOUND POWER	AIR INLET
		rpm	hp	W	in.	mm	ft.lb	Nm	lb	kg	in.	mm	cfm	l/s	a	k	ISO 15744 - dB(A)	in.		
CP7300R	894 107 3001	2700	0.3	200	1/4	6	2.2	3.0	1.3	0.6	5.0	127	16.4	8	<2.5	-	88	99	1/4	
CP7300RQC	894 107 3002	2700	0.3	200	1/4	6	2.2	3.0	1.3	0.6	5	127	16.4	8	<2.5	-	88	99	1/4	
CP1014P24	615 158 0050	2400	0.5	375	1/4	6	1.7	2.3	1.2	0.5	4.9	124	19.0	9	3.1	2	78	89	1/4	
CP1014P33	615 158 0030	3300	0.5	375	1/4	6	1.3	1.8	1.2	0.5	4.9	124	19.0	9	<2.5	-	78	89	1/4	
CP887	T025376	2500	0.5	375	3/8	10	3.9	5.2	2.2	1.0	8.0	203	27.0	13	<2.5	-	99	110	1/4	
CP879	T023999	1800	0.3	200	3/8	10	3.3	4.4	2.2	1.0	8.3	210	21.0	10	<2.5	-	95	106	1/4	
CP789R-26	T025180	2600	0.5	375	3/8	10	3.0	4.1	2.5	1.1	7.0	178	30.0	14	<2.5	-	101	112	1/4	
CP789R-42	T025198	4200	0.5	375	3/8	10	1.8	2.5	2.5	1.1	7.0	178	30.0	14	<2.5	-	104	115	1/4	

ALL CP1014 KEY CHUCK MODELS ARE ALSO AVAILABLE WITH KEYLESS CHUCK. PLEASE LOOK AT WWW.CP.COM

All models: Hose int. 3/8" (10mm) - @90 PSI (@6.3 Bar)

Listed specifications are for reference only. Please check documents in each tool.

CP1014P05



500 rpm



0,5HP 500 RPM 3/8" KEY CHUCK

FEATURES

- 3/8" (10mm) industrial pistol drill with Jacobs keyed chuck
- Excellent power to weight ratio with 0,5hp (375W) motor
- Teasing throttle for progressive and safety control
- Exclusive handle with double wings for precise drilling
- Durable gearbox reducing maintenance cost and downtime

BENEFITS

- Operator comfort thanks to exclusive ergonomic features
- Compact shape & light weight for easy handling and access
- Designed for intensive duty and high durability



CP1117P09



900 rpm



1HP 900 RPM 1/2" KEY CHUCK

FEATURES

- 1/2" (13 mm) industrial pistol drill with Jacobs keyed chuck
- The best power to weight ratio with 1 hp (750 W) motor
- Teasing throttle for progressive and safety control
- Exclusive handle with double wings for precise drilling
- Durable gearbox reduce maintenance cost and downtime

BENEFITS

- Improve your productivity thanks to high power
- Operator comfort thanks to exclusive ergonomic features
- Designed for intensive duty and high durability

CP1117P05

Similar features as CP1117P09 with 500 rpm



See accessories on page 38

CP1117P26



2,600 rpm



1HP 2600 RPM 3/8" KEY CHUCK

FEATURES

- 3/8" (10 mm) industrial pistol drill with Jacobs keyed chuck
- The best power to weight ratio with 1hp (750 W) motor
- Teasing throttle for progressive and safety control
- Exclusive handle with double wings for precise drilling
- Low vibrations
- Durable gearbox reduce maintenance cost and downtime

CP1117P60

Similar features as CP1117P26 with 6000 rpm

CP1117P32

Similar features as CP1117P26 with 3200 rpm

BENEFITS

- Improve your productivity thanks to high power & speed
- Operator comfort thanks to exclusive ergonomic features
- Designed for intensive duty and high durability



CP1117P09

MODEL	PART NUMBER	FREE SPEED		POWER		CHUCK CAPACITY		MAXIMUM TORQUE		NET WEIGHT		LENGTH		AIR CONS. @LOAD		VIBRATION LEVEL ISO 28927 (ml/s²)		SOUND PRESS.	SOUND POWER	AIR INLET
		rpm	hp	W	in.	mm	ft.lb	Nm	lb	kg	in.	mm	cfm	l/s	a	k	ISO 15744 - dB(A)	in.		
CP1014P05	615 158 0190	500	0.5	375	3/8	10	9.2	12.5	1.4	0.6	5.9	150	19.0	9	<2.5	-	78	89	1/4	
CP1117P26	615 158 0130	2600	1.0	750	3/8	10	2.9	3.9	2.2	1.0	7.1	180	29.8	14	3.6	1.7	83	94	1/4	
CP1117P60	615 158 0090	6000	1.0	750	3/8	10	1.2	1.7	2.2	1.0	7.1	180	29.8	14	<2.5	-	83	94	1/4	
CP1117P32	615 158 0110	3200	1.0	750	3/8	10	2.1	2.8	2.2	1.0	7.1	180	29.8	14	<2.5	-	83	94	1/4	
CP1117P05	615 158 0170	500	1.0	750	1/2	13	12.3	16.7	3.4	1.5	8.3	210	29.6	14	2.7	2	83	94	1/4	
CP1117P09	615 158 0150	900	1.0	750	1/2	13	7.3	10	2.2	1.0	8.3	210	29.8	14	3.7	2.6	83	94	1/4	

ALL CP10148 CP1117 KEY CHUCK MODELS ARE ALSO AVAILABLE WITH KEYLESS CHUCK. PLEASE LOOK AT WWW.CP.COM

All models: Hose int. 3/8" (10mm) - @90 PSI (@6.3 Bar)

Listed specifications are for reference only. Please check documents in each tool.

Drilling

Kits, Accessories & Spares

DRILL KITS



CP7300R Kit Imperial

Part No. 8941173001
 Kit includes:
 - (1) CP7300R Drill
 - (13) Drill bits - 1/16", 5/64", 3/32",
 7/64", 1/8", 9/64", 5/32", 11/64",
 3/16", 13/64", 7/32", 15/64", & 1/4"

CP7300R Kit Metric

Part No. 8941273001
 Kit includes:
 - (1) CP7300R Drill
 - (13) Drill bits - 1.5, 2, 2.5, 3, 3.2,
 3.5, 4, 4.5, 4.8, 5, 5.5, 6,
 & 6.5 mm

ACCESSORIES INCLUDED



CHUCKS



MODEL	DESCRIPTION	PART NO.
CP1014P45 CP1014P33 CP1014P24	Chuck threaded 3/8" UNF - cap 1/4" (6mm) with key	205 055 5863



CP1117P60 CP1117P32 CP1117P26 CP1014P05	Chuck threaded 3/8" UNF - cap 3/8" (10mm) with key Key for chuck 3/8"	S066095 CA050120
--	--	---------------------



CP1117P09 CP1117P05	Chuck threaded 3/8" UNF - cap 1/2" (13mm) with key Key for chuck 1/2"	C142408 CA050122
------------------------	--	---------------------



CP1117P60 CP1117P32 CP1117P26	Keyless Chuck threaded 3/8" UNF - cap 3/8" (10mm)	205 050 2063
-------------------------------------	---	--------------



CP1117P09 CP1117P05	Keyless Chuck threaded 3/8" UNF - cap 1/2" (13mm)	205 050 2073
------------------------	---	--------------



HANDLE



MODEL	DESCRIPTION	PART NO.
CP1117P09/P05	Handle fixture Handle	205 055 2463 205 055 2473

CP1117P..	Suspension bail	894 016 8729
-----------	-----------------	--------------



OPTIONAL ACCESSORIES

DRILL CHUCKS



MODEL	CAPACITY		THREAD MOUNT	CHUCK PART NO.	TYPE	KEY PART NO.
	in.	mm				
CP7300	1/4	6	3/8-24	895 101 1473	Chuck + Key	205 049 7003
CP879, CP887	3/8	10	3/8-24	C142408	Chuck + Key	C142411
CP7300RQC	1/4	6	3/8-24	894 016 2272	Keyless Chuck	

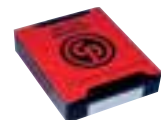

TUNE-UP KITS

MODEL	TUNE-UP KIT
CP7300R	205 052 8673
CP789R-26	-
CP789R-42	-
CP1014 P24	205 055 5513
CP1014 P45	205 055 5513
CP879	205 050 6523
CP1014 P05	205 055 5513
CP1117 P60	205 055 2333
CP1117 P32	205 055 2333
CP1117 P09	205 055 2333
CP1117 P05	205 055 2333

Chipping



Needle scalers

Perfect for derusting applications, pistol or in-line needle scalers are used in almost all the industrie

Chipping hammers

Pistol or in-line chipping hammers including selection of unique vibration damping body to improve operator comfort and minimize fatigue.



In-line needle scaler / Chipping hammer

Quick change 2 in 1 needle scaler and chipping hammer for less down time

How to define the right percussive?

Step 1

Applications

- ▶ Derusting
- ▶ Deburring
- ▶ After welding
- ▶ Duty
- ▶ Access



Step 2

Consumables

- ▶ Needles size and number
- ▶ Chisel type and dimensions



Step 3

Tools

- ▶ Handle type
- ▶ Vibration level
- ▶ Stroke capacity
- ▶ Bore

Chipping

Percussive tools

CP9361



AIR SCRIBE

CP9361-1 Kit

See details on page 43

FEATURES

- Air scribe with the highest durability in the market
- Hose 8ft (2.4m) length with air filter
- Convertible to a light scaler

BENEFITS

- Ideal for use on variety of materials such as metals, plastics, ceramics, and glass
- Easy handling
- Adjustable power for a variety of applications

CP7111



PISTOL GRIP HAMMER

FEATURES

- Standard .401 round shank
- Easy change retainer for quick accessory change

BENEFITS

- Powerful and cost effective
- Fast cutting action
- Designed for all general works

CP7111 Hex

Same features as CP7111 with hexagonal shank



CP7111 Kit

See details on page 43

CP7111 Hex Kit

See details on page 43

CP714



PRECISION & PRODUCTIVITY

FEATURES

- Super-duty pistol grip hammer
- Positive action trigger for precise control
- Speed regulator

BENEFITS

- Versatile, handling a wide range of body shop applications including front end, exhaust, frame and body work
- Operator comfort



See accessories on page 44

CP7120



2 TOOLS IN 1

FEATURES

- General purpose needle scaler
- Weld flux chipping hammer
- Quick change chisel retainer
- Adjustable sleeve, 1/8" (19 x 3mm) steel needles and 1.37" (35 mm) width chisel

BENEFITS

- Easily converts into a chipping hammer
- Durable and economical solution
- Ideal for surface preparation

MODEL	PART NUMBER	BORE		STROKE		SHANK		BLOWS PER MINUTE	AIR CONS. @LOAD		WEIGHT		LENGTH		VIBRATION LEVEL ISO 28927 (m/s ²)		SOUND PRESS. ISO 15744 - dB(A)	SOUND POWER	AIR INLET
		in.	mm	in.	mm	in.	shape		blows/min.	cfm.	l/s	lb	kg	in.	mm	a			
CP9361	T012644	-	-	-	-	-	-	13500	1.1	0.1	0.3	0.1	5	127	5.1	2.4	79	90	1/4
CP7111	894 107 1110	3/4	19	2.6	67	0.4	R	3000	25	11.8	3.5	1.6	6.7	171	6.3	3.1	100	111	1/4
CP7111HEX	894 107 1111	3/4	19	2.6	67	0.4	Hex	3000	25	11.8	3.5	1.6	6.7	171	11.0	4.6	100	111	1/4
CP714	T012735	9/16	14	3.5	80	0.4	R	2000	8.5	4.0	3.3	1.5			13.1	5.8	95	106	1/4
CP7120	894 107 1200	1	25	1.2	28	0.5	R	4800	4	1.8	6.2	2.8	18	457	11.4	3.4	99	110	1/4

All models: Hose int. 1/2" (13mm) - @90 PSI (@6.3 Bar)

Listed specifications are for reference only. Please check documents in each tool.

CP7125



COVERING LARGE SURFACES WITH COMFORT GRIP

FEATURES

- General purpose needle scaler
- Rubber sleeve on handle for better comfort
- Delivered with 2 sets of needles:
 - 19 x 0.12" (3 mm) for standard usage
 - 29 x 0.08" (2 mm) for finer usage

BENEFITS

- Great for rust removal on chassis
- Great cleaning up steel wheel drums
- Ideal for surface clean-up work



CP9356 NS



See accessories on page 48

CP0951



HEAVY INDUSTRIAL NEEDLE SCALERS

FEATURES

- Straight needle scaler for heavy industrial application
- Superior design with internal spring components provides greater durability
- Needle capacity 12 x 1/8" (3mm)

BENEFITS

- High durability
- Low vibration and comfort with soft grip
- Ideal tool for de-rusting and de-painting

CP0952

Same features as CP0951 with pistol shape



CP9356 NS



NEEDLE SCALERS

FEATURES

- Straight needle scaler for industrial application
- Versatile design with good durability
- Needle capacity 19 x 1/8" (3mm)

BENEFITS

- Sturdy and simple design for heavy and wide applications
- Convertible to weld-flux chipper
- Ideal tool for de-rusting and de-painting

CP9356 WF

Same features as CP9356 NS with 1/2" square chisel

MODEL	PART NUMBER	BORE		STROKE		NEEDLE CAPACITY No. x Ø in.(mm)	BLOWS PER MINUTE blows/min.	AIR CONS. @LOAD		WEIGHT		LENGTH		VIBRATION LEVEL ISO 28927 (m/s ²)		SOUND PRESS. ISO 15744 - dB(A)	SOUND POWER	AIR INLET in.
		in.	mm	in.	mm			cfm.	l/s	lb	kg	in.	mm	a	k			
CP7125	894 107 1250	1	21	1.3	33.5	19x1/8" (3)	4000	4.6	2.2	6.2	2.8	12.8	325	19.2	2.4	105	116	1/4
CP0951	T022306	0.9	23.8	1.1	28.6	12x1/8" (3)	4000	9.6	4.5	5.9	2.7	9.3	237	9.2	2.9	90	101	3/8
CP0952	T019191	25/32	23.8	1.1	28.6	12x1/8" (3)	4000	7.1	3.3	5.2	2.4	9.6	245	15.4	4.3	92	103	3/8
CP9356 WF	T021959	1	25.4	1.1	28.6	1/2" square	4600	10.2	4.8	3.7	1.7	9.4	238	21.3	8.0	90	101	3/8
CP9356 NS	T022165	1	25.4	1.1	28.6	19x1/8" (3)	4600	10.2	4.8	3.7	1.7	17	432	17.3	3.4	90	101	3/8

All models: Hose int. 1/2" (13mm) - @90 PSI (@6.3 Bar)

Listed specifications are for reference only. Please check documents in each tool.

Chipping

Percussive tools

B19BV

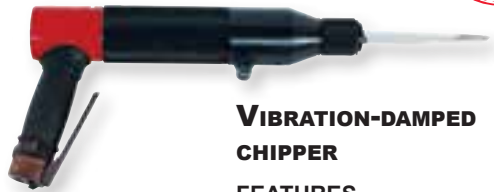

VIBRATION-DAMPED CHIPPER



FEATURES

- Vibration-damped needle scaler, Pistol grip
- Easily convertible to needle scaler using accessories

BENEFITS

- Light weight and easy to handle thanks to high engineered design
- Low vibration and ergonomic design
- Ideal for chisel scaling work such as splitting, chipping, pointing

B16BV

Similar features as B19BV with straight shape

B18BV

Similar features as B19BV with small Bore & Stroke

ACCESSORIES INCLUDED

MODEL	DESCRIPTION	PART NO.
	Hex Key 6 mm	615 802 0560
	1/4" Air Hose Nipple for 3/8" (10mm) ID hose	
B16BV / B18BV / B19BV	1 Chisel, width 1 3/8" (35mm), length 7" (178 mm) for B18BV & B19BV	615 804 6180
	2 Angle Chisel, width 1 3/8" (35 mm), length 7" (178 mm) for B16BV	615 804 6220



GV5



POWERFUL PNEUMATIC HAMMER FEATURES

- Pneumatic Hammer for heavy industrial application
- Safety lever furnished
- Hex. 3/4" x 1 31/32" (19.2 x 50mm) shank

BENEFITS

- Sturdy design for heavy applications
- Powerful and durable
- Ideal tool for heavy chipping or cutting applications

OPTIONAL ACCESSORIES

MODEL	DESCRIPTION	PART NO.
GV5	Chisel, width 3/4" (19 mm), length 11 15/16" (300mm)	615 804 0950
	Chisel, width 3/4" (19 mm), length 19 15/16" (500mm)	615 804 0960
	Pick, length 11 15/16" (300mm)	615 804 0930
	Pick, length 19 11/16" (500mm)	615 804 0940
	Scraper, width 2 23/64" (60mm), length 9 27/32" (250mm)	615 804 0970

B18MV



VIBRATION-DAMPED NEEDLE SCALER



B16MV

Similar features as B18MV with straight shape



B19MV

Same features as B18MV with larger Bore & Stroke

FEATURES

- Vibration-damped needle scaler, Pistol grip
- Easily convertible to chipper using accessories

BENEFITS

- Light weight and easy to handle thanks to high engineered design
- Low vibration and ergonomic design
- Ideal for removal of coatings, corrosion and other accumulated materials

ACCESSORIES INCLUDED

MODEL	DESCRIPTION	PART NO.
B16MV / B18MV / B19MV	Hex Key 6 mm	615 802 0560
	1/4" Air Hose Nipple for 3/8" (10mm) ID hose	

See accessories on page 44



B16BV Hammer is delivered with an angle chisel and B18BV/B19BV Hammers are delivered with standard straight chisel. All Needle Scalers are delivered with Chisel Tipped needles.

MODEL	PART NUMBER	BORE		STROKE		CHISEL NEEDLE CAPACITY No. x Ø in.(mm)	BLOWS PER MINUTE blows/min.	AIR CONS. @LOAD		WEIGHT		LENGTH		VIBRATION LEVEL ISO 8662 (m/s ²)		SOUND PRESS. ISO 15744 - dB(A)	SOUND POWER	AIR INLET in.
		in.	mm	in.	mm			cfm.	l/s	lb	kg	in.	mm	a	k			
B19BV	615 174 0550	1.3	34.4	0.7	20	1/2" Square	3000	4.4	2.1	9.0	4.1	17.7	450	2.6	-	93	104	1/4
B16BV	615 174 0510	0.9	23.5	0.4	11	1/2" Square	2400	5.1	2.4	6.2	2.8	16.7	425	2.2	-	89	100	1/4
B18BV	615 174 0530	0.9	23.5	0.4	11	1/2" Square	2400	4.2	2.0	6.8	3.1	16.5	420	2.3	-	88	99	1/4
GV5	615 174 0170	1.1	28.0	2.0	53	3/4" Hex	2400	17.6	8.3	11.2	5.1	15.0	385	15.7	-	95	106	1/2
B18MV	615 174 0520	0.9	23.5	0.4	11	19 x 1/8" (3)	2400	4.2	2.0	5.9	2.7	13.4	340	2.2	-	86	97	1/4
B16MV	615 174 0500	0.9	23.5	0.4	11	19 x 1/8" (3)	2400	5.1	2.4	5.3	2.4	14.2	360	2.8	-	86	97	1/4
B19MV	615 174 0540	1.3	34.4	0.8	20	19 x 1/8" (3)	3000	4.4	2.1	7.9	3.6	14.8	375	2.7	-	88	99	1/4

All models: Hose int. 3/8" (10mm) - @90 PSI (@6.3 Bar)
GV5: Hose int. 1/2" (13mm) - @90 PSI (@6.3 Bar)

Listed specifications are for reference only. Please check documents in each tool.

B14A



B23

Same features as B14A with 3 head pistons

PISTON SCALER, RAPID AND HARD-HITTING FEATURES

- Single head piston scaler
- Ergonomic side-hand
- Furnished tungsten carbide tipped cross bit

BENEFITS

- Light weight and easy to handle thanks to simple design
- Designed for versatile removal application including tight spot
- Ideal for removal of thick scale, heavy corrosion and hard coating

ACCESSORIES INCLUDED



MODEL	ITEM	DESCRIPTION	PART NO.
B14/B23	1	Cross bit, conical shank (carbide tipped)	615 250 5450
	2	Side handle	615 576 5130
	.	Washer	615 746 5290

B20



B20-00

Flexible and low air consumption



B20-0

Handy handle length 43" (1,100mm) covers all basic application



B20-1

Longest reach handle 68" (1,730mm) enable the widest scaling work



B20L

Aluminum body to reduce weight



B20L-1

Lightweight suitable for vertical work

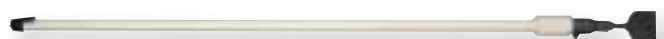

MODEL	PART NUMBER	BORE		STROKE		SHANK		BLOWS PER MINUTE	AIR CONS. @LOAD		WEIGHT		LENGTH		VIBRATION LEVEL ISO 28927 (m/s ²)		SOUND PRESS. ISO 15744 - dB(A)	SOUND POWER	AIR INLET
		in.	mm	in.	mm	in.	shape		blows/min.	cfm.	l/s	lb	kg	in.	mm	a			
B14A	615 174 0220	1.06	27.0	1.04	26.5	-	Conical	2800	9.0	4.2	5.5	2.5	18.2	462	4.9	6.9	88	99	1/4
B23	615 174 0420	1.06	27.0	1.04	26.5	-	Conical	2800	16.0	7.5	8.1	3.7	18.0	456	23.2	32.4	92	103	1/4
B20	615 174 0340	1.12	28.6	1.35	39.0	5/8	Hex	2200	4.5	2.1	12.2	5.5	55.1	1400	13.1	18.3	86	97	1/4
B20-0	615 174 0350	1.12	28.6	1.35	39.0	5/8	Hex	2200	4.5	2.1	10.8	4.9	43.3	1100	16.6	23.2	83	94	1/4
B20-00	615 174 0360	1.12	28.6	1.35	39.0	5/8	Hex	2200	4.5	2.1	8.2	3.7	28.0	710	20.5	28.7	84	95	1/4
B20-1	615 174 0370	1.12	28.6	1.35	39.0	5/8	Hex	2200	4.5	2.1	13.5	6.1	68.1	1730	14.3	19.9	84	95	1/4
B20L-1	615 174 0390	1.12	28.6	1.35	39.0	5/8	Hex	2200	4.5	2.1	8.4	9.4	67.3	1710	19.8	27.7	84	95	1/4
B20L	615 174 0380	1.12	28.6	1.35	39.0	5/8	Hex	2200	4.5	2.1	7.5	3.4	55.5	1410	21.2	29.6	86	97	1/4

All models: Hose int. 3/8" (10mm) - @90 PSI (@6.3 Bar)

Listed specifications are for reference only. Please check documents in each tool.

Kits & Accessories

HAMMERS KITS



CP7111 Kit

Part No. 8941171110

Kit includes:

- (1) CP7111 Hammer
- (4) Chisels

CP7111HEX Kit

Part No. 8941171111

Kit includes:

- (1) CP7111HEX Hammer
- (4) Chisels

CP9361-1 Kit

Part No. T011970

Kit includes:

- (1) CP9361 Air Scribe
- Stylus - carbide tipped
- Anvil for use with chisels and blank
- Flat Chisel
- Chisel Blank
- Round Nose Chisel
- Carrying Case



NEEDLE SETS FOR CP9356NS, CP0951 & CP0952



Ø	LENGTH		DESCRIPTION	PART NO.	
	in.	mm			
5/64	2	7	180	Steel Needle flat set (Qty 29)	NP123905
5/64	2	7	180	Steel Needle flat set (Qty 53)	NP123906
1/8	3	5	127	Steel Needle flat set (Qty 19)	P136403
1/8	3	7	180	Steel Needle flat set (Qty 12)	NP123901
1/8	3	7	180	Steel Needle flat set (Qty 23)	NP123902
1/8	3	7	180	Steel Needle Pak (Qty 250)	NP137638
1/8	3	7	180	Steel Needle flat set (Qty 19)	P100146
1/8	3	7	180	Stainless Needle flat set (Qty 19)	P106454

Chipping

Accessories & Spares

CHISELS FOR CP9356 & CP7120

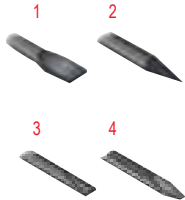

ITEM	LENGTH		WIDTH		DESCRIPTION	PART NO.
	in.	mm	in.	mm		
1	7	180	1.37	35	Curved chisel	205 049 9653
2	7	180	-	-	Pointed chisel	205 051 2793
3	7	180	0.79	20	Flat chisel	205 051 2803
4	4	102	5/8	16	Flat chisel	WP123997
4	7-1/2	191	5/8	16	Flat chisel	WP123996
4	6-1/2	165	1-3/8	35	Flat chisel	WP123998
-	6-1/2	165	1-3/8	35	Angle scaling	WP123999
	7	178			1/8" (3mm) Needles Set. (19)	894 015 9860
	5	127			1/8" (3mm) Needles Set. (19)	P136403
	2	50			Scraper	894 016 2308
	7	178			Blank Chisel	WP123994
	7	178			Diamond Point Chisel	WP123995

RETAINERS 0.401" (10.2MM)

MODEL	DESCRIPTION	PART NO.
CP7111 & CP714	Bee hive retainer	A046096
CP7111	Quick change retainer	A046095
CP714	Zip-quick retainer	A046094
CP7111 & CP714	Quick change retainer	894 015 8924
CP7111 & CP714	Posi lock retainer	A121721

0.401" (10.2MM) - ROUND SHANK CHISELS FOR CP714 & CP7111



ITEM	LENGTH		WIDTH		DESCRIPTION	PART NO.
	in.	mm	in.	mm		
1	6.5	165	0.63	16.0	Rivet cutter	A046050
2	6.5	165	1.28	32.4	Angle scaling chisel	A046063
3	7.0	180	-	-	Diamond point chisel	A046064
4	7.0	180	0.82	20.9	Twin blade panel (pipe) cutter	A046071
5	7.0	180	0.75	19.1	Cold chisel	A046073
5	18.0	457	0.75	19.1	Cold chisel	A046080
6	7.0	180	-	-	Straight punch	A046074
7	7.0	180	1.02	25.9	Spot weld splitter	A046075
8	7.0	180	-	-	Tapered punch	A046078

ITEM	LENGTH		DESCRIPTION	PART NO.
	in.	mm		
-	7.0	178	Edging chisel	A046076
-	4.0	100	Universal joint chisel	A046057
-	6.5	165	Goo scraper chisel	A046072
-	3.5	90	1/8" Rivet removal chisel	A046087
-	3.5	90	3/16" Rivet removal chisel	A046088
-	3.5	90	1/4" Rivet removal chisel	A046089
-	3.0	75	1-1/4" Smoothing hammer	A046090
-	3.0	75	1-3/4" Smoothing hammer	A046091
Round Shank Set 6 pc			Set includes: rivet cutter, twin blade cutter, cold chisel, straight punch, tapered punch, spot weld splitter	CA155807

0.401" (10.2MM) - HEXAGONAL SHANK CHISELS FOR CP7111HEX



ITEM	LENGTH		DESCRIPTION	PART NO.
	in.	mm		
1	6.5	165	Rivet cutter	CA155778
2	7.0	178	Angle scaling chisel	CA155780
3	7.0	178	Diamond point chisel	CA155782
4	6.5	165	Twin blade panel (pipe) cutter	CA155784
5	7.0	178	Cold chisel	CA155786
6	7.0	178	Straight punch	CA155790
7	7.0	178	Spot weld splitter	CA155792
8	7.0	178	Tapered punch	CA157107
Hex Shank Set 6 pc			Set Includes: rivet cutter, twin blade cutter, cold chisel, straight punch, tapered punch, spot weld splitter	CA155806

TUNE-UP KITS

MODEL	TUNE-UP KIT
CP7120	205 050 6933
CP7111/CP7111H	205 050 6823
CP7110	205 050 6863
CP0952	894 016 3083

HEX. SHANK 5/8" CHISEL FOR B20-00 / B20-0 / B20-1 / B20L / B20L-1

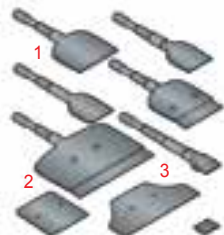

ITEM	LENGTH		WIDTH		DESCRIPTION	PART NO.
	in.	mm	in.	mm		
1	7	180	1-31/32	50	Spark-resistant chisel	615 002 9000
2	-	-	3-15/16	100	Spare blade (Qty 5)	615 250 5270
3	-	-	7-1/8	200	Spare blade (Qty 5)	615 250 5280



Speciality Tools



CP offers a wide range of speciality tools to match your daily air tool needs:

Saws



High speed cutters



Caulking Gun



Riveters



Nibbler



Tire buffers



Air files



Speciality Tools

CP881



3/8" / 10mm stroke

9,500 rpm



CP7900

Similar features as CP881 with lighter weight

CP7901

Same features as CP881 with low vibration

CP7901 Kit

See details on page 48

RUGGED SAW

FEATURES

- Heavy-duty reciprocating saw
- Power and speed of 9500 strokes per minute
- Strokes 3/8" (10mm)
- Adjustable guard guide
- Includes 32T saw blade

BENEFITS

- Powerful and durability
- Comfortable tool for intensive use

CP861



20,000 rpm



CP874

Similar features as CP861 with 22000 rpm

DURABILITY & POWER

FEATURES

- Heavy-duty high speed cutter
- Rugged, energy efficient 0.5hp (375 W) motor
- Lightweight tool: 1.63 lbs (0.74kg)
- 2-7/8" (73mm) cutting wheel capacity
- Square handle design for positive grip
- Safety lever to prevent accidental start-up

BENEFITS

- Power, durability and productivity
- Excellent for cutting through composite, fiberglass, steel metal, bolts, clamps and hangars

CP785S



RELIABLE & POWERFUL

FEATURES

- Heavy-duty pistol shear
- Powerful efficient 0.5 hp (375 W) motor to cut up to 18-gauge steel (1.1 mm - 0.04")
- Ergonomic handle design

BENEFITS

- Smooth operation and extended life
- Operator comfort
- Excellent tool for cutting square and angles in all types of aluminum, tin and steel



See accessories on page 48

CP835



GOOD CUTTING CONTROL

FEATURES

- Heavy-duty nibbler
- **Nibbling capacity:**
 - steel up to .60" (16 gauges)
 - aluminium up to .102" (10 gauges)
- Easy access to punch and die for quick replacement
- Lever throttle for low-speed starting
- 4 optional cutting positions

BENEFITS

- Easy to operate and control
- The best for tight corners and circles
- Used for nibbling plastic, tin, aluminum, steel and others metals

MODEL	PART NUMBER	STROKES PER MIN.	AIR CONS. @LOAD		NET WEIGHT		LENGTH		VIBRATION LEVEL ISO 28927 (m/s ²)		SOUND PRESS. ISO 15744 - dB(A)	SOUND POWER	AIR INLET
			cfm	l/s	lb	kg	in.	mm	a	k			
CP881	T023916	9500	6.0	2.8	1.6	0.7	8.6	219	23.2	6.6	95	106	1/4
CP7900	894 107 9000	10000	5.5	2.6	1.3	0.5	8.5	216	19.6	5.2	93	104	1/4
CP7901	894 107 9011	10000	5.5	2.6	1.9	0.8	9.0	229	<2.5	-	89	100	1/4
CP861	T022039	20000	8.5	4.0	1.6	0.7	7.7	197	2.8	1.0	90	101	1/4
CP874	T025375	22000	12.5	5.9	1.7	0.7	7.2	184	4.0	4.0	99	110	1/4
CP785S	T023200	2400	15.5	7.3	2.5	0.8	8.2	229	3.2	3.0	95	106	1/4
CP835	T022550	2750	17.0	8.0	2.2	0.6	7.5	216	5.4	3.0	97	108	1/4

All models: Hose int. 3/8" (10mm) - @90 PSI (@6.3 Bar)

Listed specifications are for reference only. Please check documents in each tool.

CP871



22,000 rpm



HIGH SPEED TIRE BUFFER

FEATURES

- Adjustable speed control
- Jacobs quality 3/8" (10 mm) chuck for holding buffing accessories
- Lock-off throttle to prevent accidental start-up

BENEFITS

- Ideal for patchwork, roughing areas for recapping and cleaning tire moldings

CP873

Similar features as CP871 with low speed (2800 rpm)



CP871 Kit

See details on page 48

CP873 Kit

See details on page 48

CP9882



HEAVY PULLING & ERGONOMIC

FEATURES

- Compact Air riveters
- 1/4" (6.4 mm) max. capacity
- Heavy pulling: up to 3530 lbs (1.6 T)
- Low vibrations
- Includes: 3/16", 1/4", 1/4" monobolt (4.8, 6.4, and 6.4 mm monobolt) nose pieces
- Includes jaws, syringe, service wrenches and oil bottle

BENEFITS

- Enlarge applications coverage
- Durable, reliable and easy to service
- Maximize operator comfort

CP9710



20,000 rpm



POWERFUL & PRECISE

FEATURES

- Air file 0.4" (10 mm) stroke
- Lock-off throttle to prevent accidental start-up
- 360° swivel air inlet
- Rubber handle grip
- Includes 4 types of file: flat, half round, round, triangular

BENEFITS

- Excellent tool for use in confined areas or for precise work
- Deburring or sharpening sheet metal, iron or plastic

CP9705

Similar features as CP9710 with Air file 0.2" (5 mm) stroke and 12000 stroke/min

CP9885



CAULKING GUN

FEATURES

- Material flow controlled by trigger
- Accepts standard cartridges: 2" x 8-1/2" (50x210 mm)

BENEFITS

- Labor time saving
- Easy to handle
- Operator comfort



See accessories on page 48

MODEL	PART NUMBER	STROKES PER MIN.	AIR CONS. @LOAD		NET WEIGHT		LENGTH		VIBRATION LEVEL ISO 28927 (m/s ²)		SOUND PRESS. ISO 15744 - dB(A)	SOUND POWER	AIR INLET
			cfm	l/s	lb	kg	in.	mm	a	k			
CP871	T025372	22000	13.0	6.1	1.7	0.7	8.0	203	4.5	2.0	100	111	1/4
CP873	T025374	2800	13.0	6.1	2.2	1.0	8.2	210	<2.5	-	99	110	1/4
CP9882	894 109 8820	-	4.0	1.9	3.3	1.5	8.8	225	<2.5	-	73	84	1/4
CP9710	615 193 9710	8000	6.0	2.8	1.3	0.6	9.8	250	5.0	3.0	74	85	1/4
CP9705	615 193 9705	12000	6.0	2.8	1.2	0.5	8.0	204	5.0	3.0	84	95	1/4
CP9885	615 197 9885	-	16.8	7.9	2.3	1.0	10.0	270	<2.5	-	82	93	1/4

All models: Hose int. 3/8" (10mm) - @90 PSI (@6.3 Bar)

Listed specifications are for reference only. Please check documents in each tool.

Speciality Tools

Kits & Accessories

CP7901 Kit

Part No. 894 107 9010

Kit includes:

- (1) Heavy duty saw CP7901
- (5) Each 18T, 24T, 32T blades
- (1) Swivel inlet in a heavy duty case



CP871 Kit

Part No. T025420

Kit includes:

- (1) Tire buffer CP871
- (1) Whip hose and exhaust hose

CP873 Kit

Part No. T024362

Kit includes:

- (1) Tire buffer CP873
- (1) Whip hose and exhaust hose

OPTIONAL ACCESSORIES

SAW BLADE FOR CP7901



ACCESSORIES	PART NUMBER
18T Saw blades (5)	894 015 8775
24T Saw blades (5)	894 015 8776
32T Saw blades (5)	894 015 8777

SAW BLADE FOR CP7900



ACCESSORIES	PART NUMBER
18T Saw blades (5)	CA146719
24T Saw blades (5)	CA146720
32T Saw blades (5)	CA146721

WHEEL FOR CP874



ACCESSORIES	PART NUMBER
Package of 5 wheels (ø 2-7/8"x1/16"x3/8" - 73x1.6x9.52mm)	CA155312

WHEEL FOR CP861



ACCESSORIES	PART NUMBER
Package of 5 wheels (ø 2-7/8"x1/16"x3/8" - 73x1.6x9.52mm)	CA155312



PUNCH FOR CP835

ACCESSORIES	PART NUMBER
Punch set	KF137310
Die	KF137273

SHANK FILE FOR CP9705 AND CP9710

ACCESSORIES	PART NUMBER
0.2" (5mm) Shank file rectangular (5)	205 051 9113
0.2" (5mm) Shank file round (5)	205 051 9123
0.2" (5mm) Shank file half round (5)	205 051 9133
0.2" (5mm) Shank file triangular (5)	205 051 9143
Swivel air inlet	205 052 3733



Air Line Accessories

Chicago Pneumatic Air Preparation Units are designed to help you get maximum performance from your tools.

They ensure minimal pressure drop and thus minimum energy losses in the air distribution system, benefiting the environment and cutting your operating costs.

The lifetimes of your tools will be extended by using air preparation units and with that comes lower repair costs and less downtime. A correct air installation guarantees productivity and good total economy.

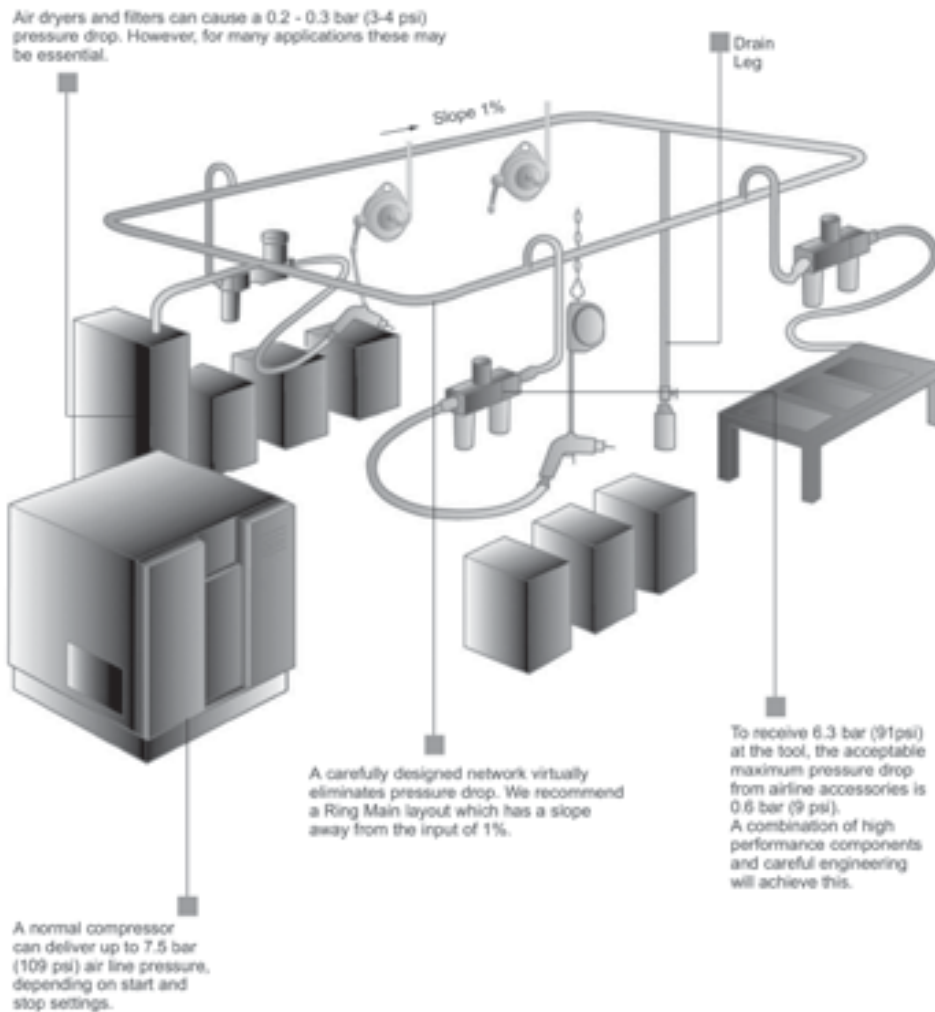

How to select your Air Line Accessories?

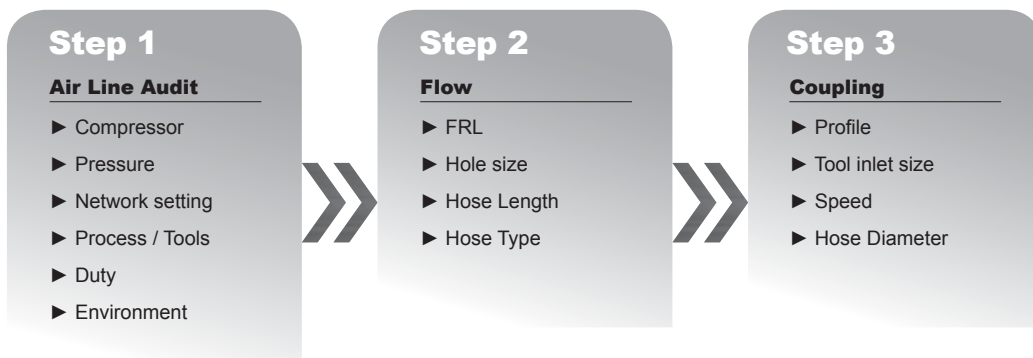

Air Line Accessories



FILTERS, REGULATORS, LUBRICATORS

Why should you use a filter, regulator and lubricator ?

The use of a filter, regulator and lubricator (in that order) for pretool air preparation is strongly recommended by Chicago Pneumatic. Proper air preparation will result in improved tool performance and increased tool life. The units should be mounted as close to the tool as possible, preferably right where the tool hose is connected to the system. To realize their full value, these units should be checked on a regular assigned basis by maintenance workers or the operators themselves.

AIR FILTER

Filter separates impurities such as water and solid particles.

Not using filters in combination with air tools leads to shorter service life, higher maintenance costs and lower efficiency. Old air systems with cool dryers, for instance, generate a lot of rust and running tools without installing a filter could damage the tool in less than a week.

Chicago Pneumatic filters separate up to 98% of the water when operating within their working range. All the types (Small, Medium and Big) are very low pressure drop.

High air flow capacity: up to 220 cfm (100 l/s) to cover most of the pneumatic tool needs. Available in kits: 1/2", 3/4", BSP or NPT, 2 or 3 stages units or individual units. Durable design including quick release bayonet metal bowls for rough working environments.

FILTER-REGULATOR LUBRICATOR WITH PRESSURE GAUGE (0-150PSI - 0-10 BAR)	THREAD	MAX. AIR FLOW		MAX PRESSURE Inlet (psi/bar)	OIL CAPACITY		PART NUMBER	
		in.	cfm / l/s		oz	ml	NPT	BSP
2 STAGE	1/2 G	110	50	246/17	6.8	201	894 016 8517	894 016 8480
2 STAGE	3/4 G	220	100	246/17	6.8	201	894 016 8519	894 016 8483

Included with the units: Filter 5µm, Pressure gauge 0-150 psi - 0-10 bar, Microfog lubricator, Automatic drain valve

REGULATOR

The regulator ensures that the pre-set working pressure remains constant - regardless of pressure variations in the intake air and minor variations in the airflow rate. For example, a pressure of 1 bar higher than necessary results in a 16% increase in air consumption. Spring controlled regulators are quick acting and therefore should be used for all types of air tools.

LUBRICATORS

If lubricators are not used, tool motor vanes will need to be changed more often. The life of the vanes may decrease to as little as 1/10th of the normal working time. The oil fog lubricator is the most common type of lubricator. It supplies a mist of oil to the air hose.

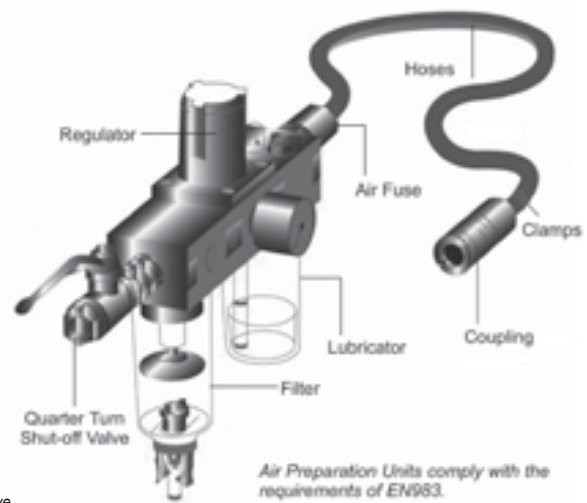

THE FLEXIBILITY OF AIR-FLEX



The Air-Flex makes all rigid hoses flexible and multi-directional. Easy: less effort due to hose rigidity, makes work easier in hard to reach areas. Comfort and safety: no twisting, the hose remains in the ideal working position and lower the risk of tendinitis. Less wear: no more premature hose wear.



MULTI DIRECTION SWIVEL CONNECTOR	MAX RECOMMENDED FLOW		WEIGHT		LENGTH		PART NUMBER		
	CFM	L/S	lb	kg	in.	mm	BSP	NPT	R
1/4"	25	12	0.17	0.079	2.62	67	615 804 7460	615 804 7470	615 995 5590
3/8"	74	35	0.28	0.126	3.23	82	615 804 7480	615 804 7490	615 995 5570
1/2"	74	35	0.29	0.132	3.23	82	615 804 7500	615 804 7510	615 995 5580

HOSES

Selecting a hose first depends on the working environment. The environments are evaluated according to the Working temperature, level of usage, presence of oil ... With such inputs you can select the correct material of hose for the application. The most common hose materials are: Rubber, PVC and Polyurethane. Air Flow is a important point to be checked. The diameter of the hose shouldn't be smaller than the recommended flow for your tool, otherwise the pressure drop can be higher than expected. Hoses have a standard pressure drop per length. To avoid performance problems in the tool, if the hose is too long, you must increase the diameter of it.

EFFI MAX HOSES

Effi max is the unique range of CP Brand rubber hose. Its construction allows a thinner wall for the same working pressure. This result in a light weight and more flexible hose

Aimed to generic grinding applications

- Exeme low weight
- Antistatic
- Rubber hose
- Soft and flexible
- Welding spatter resistant



DIMENSIONS (IDxOD)		LENGTH		AIR FLOW		WEIGHT PER 65.6 ft /20m		PART NUMBER
in. ID	mm	ft	m	cfm	l/s	lb	kg	
3/8	9.5x12.5	65.6	20	27.6	13	6.4	2.9	894 016 9921
1/2	13x18.6	65.6	20	44.5	21	8.6	3.9	615 810 9000
5/8	16x22.5	65.6	20	91.1	43	10.6	4.8	615 810 9010
3/4	20x26.1	65.6	20	159	75	11.9	5.4	615 810 9020

RUBBER HOSES

Aimed to the most demanding tasks in construction, mining, shipyards, foundries etc.

- Durable
- Antistatic
- Grinding and welding spatter resistant



DIMENSIONS (IDxOD)		LENGTH		AIR FLOW		WEIGHT PER 98 ft /30m		PART NUMBER
in. ID	mm	ft	m	cfm	l/s	lb	kg	
3/8	10x16	65.6	20	27.5	13	7.9	3.6	615 810 8640
1/2	12.5x19.1	65.6	20	44.5	21	10.4	4.7	615 810 8650
5/8	16x23	65.6	20	91.1	43	13.4	6.1	615 810 8660
3/4	20x26.6	65.6	20	159	75	17.2	7.8	615 810 8680
1	25x34	65.6	20	265	125	26.0	11.8	615 810 8700

EFFI MAX HOSE WHIPS

Always use a hose whip between the tool and the air supply hose. It provides safety and longer tool air inlet life.



HOSE DIAM.		THREAD SIZE	HOSE LENGHT		AIR FLOW		PART NUMBER	
in.	mm	in.	ft	m	cfm	l/s	NPT	BSP
3/8	10	1/4	2.0	0.6	27.6	13	CA047270	615 811 1920
1/2	13	3/8	2.0	0.6	44.5	21	CA049271	615 811 2640
1/2	13	1/2	2.0	0.6	44.5	21	CA049270	615 811 1930
5/8	16	1/2	2.0	0.6	91.1	43	615 811 2660	615 811 2650

Max working pressure: 232 PSI (16 Bar)

RUBBER HOSE REEL (AIR / WATER)

A



HRO M / Hose Reel Medium Open Steel Series
Heavy-duty air hose reel in industrial quality
Airflow > 17.6 cfm (8.5 l/s)

B



HRO L / Hose Reel Large Open Steel Series
Heavy-duty air hose reel in industrial quality
Airflow > 33.6 cfm (16 l/s)

C



CP9445H 3/8HD / Hose Reel 50FT 15M
CP9455H 1/2HD / Hose Reel 50FT 15M
Steel Series
Heavy-duty air hose reel in industrial quality

CUSTOMERS BENEFITS

- No hoses on the ground for improved safety
- From 3.3 to 33 ft / 49 or 52 ft (1 to 10 / 15 or 16 m) hose lengths with feedback force for a clean work space
- Directional swivel-plate to help you correctly reach your application
- High airflow for maximum productivity
- Lightweight and flexible polyurethane hose to reduce operator fatigue
- Open Reels with rubber hose available for heavy-duty grinding/spark areas
- Working temperatures: -30°C+ 60°C (-4°F +140°F)

PIC REF	MODEL	THREAD TYPE	CONNECTION		LENGTH		Ø INTERNAL		INLET	WEIGHT		MAX. PRESSURE		AIR FLOW		PART NUMBER
			IN (in.)	OUT (in.)	ft	m	in.	mm		lb	kg	PSI	bar	cfm	l/s	
A	HRO M HOSE REEL	BSP	1/4	1/4	52	16	3/8	10	feet lead-hose 4.9 ft (1.5)	24.3	11.0	290	20	17.6	8.5	615 804 5060
A	HRNO M HOSE REEL	NPT	1/4	1/4	52	16	3/8	10	feet lead-hose 4.9 ft (1.5)	24.3	11.0	290	20	17.6	8.5	615 804 5070
B	HROR L HOSE REEL	BSP	3/8	3/8	49	15	1/2	13	feet lead-hose 4.9 ft (1.5)	30.9	14.0	290	20	33.5	16	615 804 5120
B	HRNOR L HOSE REEL	NPT	3/8	3/8	49	15	1/2	13	feet lead-hose 4.9 ft (1.5)	30.9	14.0	290	20	33.5	16	615 804 5130
C	CP9445H 3/8HD	NPT	3/8	3/8	49	15	3/8	10	feet lead-hose 4.9 ft (1.5)	50.0	22.7	300	21	-	-	894 109 4352
C	CP9455H 1/2HD	NPT	1/2	1/2	49	15	1/2	13	feet lead-hose 4.9 ft (1.5)	50.0	25.8	300	21	-	-	894 109 4551

Air Line Accessories

CP gives you the right selection of accessories to get the best from your tool.



KIT: NPT + EASY FLOW ASIA 7,5MM



KIT DESCRIPTION	PART NUMBER	KIT CONTENT
FRL KIT		

KIT: BSP + EASY FLOW EURO SERIES COUPLINGS/NIPPLES



KIT DESCRIPTION	PART NUMBER	KIT CONTENT
FRL KIT		

HOSE KIT

KIT: NPT + EASY FLOW ISO 6150B MIL-C4109 COUPLINGS/NIPPLES



KIT DESCRIPTION	PART NUMBER	KIT CONTENT
FRL KIT		

HOSE KIT



615 398 0365	1/4" BSP Ball valve + 2 Stage 1/4" FRL + 1/4" EF Coupling EURO 7,6mm
615 398 0375	1/2" BSP Ball valve + 2 Stage 1/2" FRL + 1/2" EF Coupling EURO 7,6mm
615 398 0385	3/4" BSP Ball valve + 2 Stage 3/4" FRL + 3/4" EF Coupling EURO 10,4mm

HOSE KIT



615 398 0555	Hose Kit: 1/4" EF Nipple EURO 7,6mm + 8m 1/4" Polyuretane hose + EF Coupling EURO 7,6mm Nipple's kit for tool 1/4" & 1/8"
615 398 0565	Hose Kit: 1/4" EF Nipple EURO 7,6mm + 8m 3/8" Polyuretane hose + EF Coupling EURO 7,6mm Nipple's kit for 1/4" & 1/8" tool inlet
615 398 0575	Hose Kit: 3/8" EF Nipple EURO 7,6mm + 8m 1/2" Polyuretane hose + EF Coupling EURO 7,6mm Nipple's kit for 3/8" tool inlet
615 398 0585	Hose Kit: 1/2" EF Nipple EURO 10,4mm + 8m 5/8" Polyuretane hose + EF Coupling EURO 10,4mm Nipple's kit for 3/8" & 1/2" tool inlet

HOSE WHI



HOSE WHIP KIT

615 398 0445	Rubber hose whip 3/8" BSP 13mm ID + EF Nipple EURO 10,4mm
615 398 0455	Rubber hose whip 1/2" BSP 16mm ID + EF Nipple EURO 10,4mm

CLOSED

HOSE WHI

OPEN HO

CLOSED H

CLOSED HOSE REEL KIT



615 398 0495	HRS Polyurethane Hose Reel 8mm ID, 10m length + EF Nipple and Coupling EURO 7,6mm
615 398 0505	HRM Polyurethane Hose Reel 10mm ID, 10m length + EF Nipple and Coupling EURO 7,6mm

OPEN HOSE

OPEN HOSE REEL KIT



615 398 0685	HROM Polyurethane Hose Reel 10mm ID, 16m length + EF Nipple and Coupling EURO 7,6mm
615 398 0695	HROL Polyurethane Hose Reel 13mm ID, 16m length + EF Nipple and Coupling EURO 7,6mm

For more information, visit us at: www.cp.com

Index (Model Search)

MODEL	PART NUMBER	DESCRIPTION	PAGE	MODEL	PART NUMBER	DESCRIPTION	PAGE
B14A	615 174 0220	Percussive tools Chippers & scalers	43	CP6920 PALED	615 190 6920	Impact Wrenches	15
B16BV	615 174 0510	Percussive tools Vibration-damped chippers	42	CP6920 PALED	615 190 6920	Impact Wrenches	15
B16MV	615 174 0500	Percussive tools Vibration-damped needle scalers	42	CP7111	894 107 1110	Percussive tools Hammers	40
B18BV	615 174 0530	Percussive tools Vibration-damped chippers	42	CP7120	894 107 1200	Percussive tools Chippers & scalers	40
B18MV	615 174 0520	Percussive tools Vibration-damped needle scalers	42	CP7125	894 107 1250	Percussive tools Needle scalers	41
B19BV	615 174 0550	Percussive tools Vibration-damped chippers	42	CP714	T012735	Percussive tools Hammers	40
B19MV	615 174 0540	Percussive tools Vibration-damped needle scalers	42	CP7200	894 107 2001	Sanders 50 & 75	32
B20	615 174 0340	Percussive tools Chippers & scalers	43	CP724H	894 100 7240	Impact Wrenches	13
B20-0	615 174 0350	Percussive tools Chippers & scalers	43	CP724H	894 100 7240	Impact Wrenches	13
B20-1	615 174 0370	Percussive tools Chippers & scalers	43	CP7300R	894 107 3001	Drills 1/4"	36
B20L	615 174 0380	Percussive tools Chippers & scalers	43	CP7300RQC	894 107 3002	Drills 1/4"	36
B20L-1	615 174 0390	Percussive tools Chippers & scalers	43	CP734H	T024351	Impact Wrenches	13
B33	615 174 0420	Percussive tools Chippers & scalers	43	CP734H	T024351	Impact Wrenches	13
CP0611 GASED	T022580	Impact Wrenches	16	CP772H	T024598	Impact Wrenches	13
CP0611 GASEL	T022581	Impact Wrenches #5 spline	16	CP772H	T024598	Impact Wrenches	13
CP0611 GASEL	T022581	Impact Wrenches	16	CP7748	894 107 7480	Impact Wrenches	12
CP0611 HAZED	T022582	Impact Wrenches	16	CP7748	894 107 7480	Impact Wrenches	12
CP0611 HAZED	T022582	Impact Wrenches	16	CP7748-2	894 107 7482	Impact Wrenches	12
CP0611 PASED	T022578	Impact Wrenches	16	CP7748-2	894 107 7482	Impact Wrenches	12
CP0611 PASEL	T022579	Impact Wrenches	16	CP7774	894 107 7740	Impact Wrenches	14
CP0611 PASEL	T022579	Impact Wrenches	16	CP7774	894 107 7740	Impact Wrenches	14
CP0611P RLS	T025414	Impact Wrenches	14	CP7774-6	894 107 77746	Impact Wrenches	14
CP0611P RLS	T025414	Impact Wrenches	14	CP7774-6	894 107 77746	Impact Wrenches	14
CP0611P RS	T025413	Impact Wrenches	14	CP7830HQ	894 107 8308	Ratchet Wrenches	17
CP0611P RS	T025413	Impact Wrenches	14	CP7830HQ	894 107 8308	Ratchet Wrenches	17
CP0951	T022306	Percussive tools Chippers & scalers	41	CP7830Q	894 107 8306	Ratchet Wrenches	17
CP0952	T019191	Percussive tools Chippers & scalers	41	CP7855	T023200	Drills 3/8"	46
CP1014P05	615 158 0190	Drills 3/8"	37	CP789R-26	T025180	Drills 3/8"	36
CP1014P24	615 158 0050	Drills 3/8"	36	CP789R-42	T025198	Drills 3/8"	36
CP1014P33	615 158 0030	Drills 3/8"	36	CP9000	894 107 9000	Specialty & Cutting Reciprocating saws	46
CP1117P05	615 158 0170	Drills 1/2"	37	CP9001	894 107 9011	Specialty & Cutting Reciprocating saws	46
CP1117P09	615 158 0150	Drills 1/2"	37	CP8222-P	615 159 0180	Impact Wrenches	12
CP1117P26	615 158 0130	Drills 3/8"	37	CP8222-P	615 159 0180	Impact Wrenches	12
CP1117P32	615 158 0110	Drills 3/8"	37	CP8222-R	615 159 0230	Impact Wrenches	12
CP1117P60	615 158 0090	Drills 3/8"	37	CP8222-R	615 159 0230	Impact Wrenches	12
CP2612	615 192 2612	Screwdrivers Roller/Cushion	20	CP8242-P	615 159 0200	Impact Wrenches	12
CP2623	615 192 2623	Screwdrivers Roller/Cushion	20	CP8242-P	615 159 0200	Impact Wrenches	12
CP2755	615 192 2755	Screwdrivers Direct drive	20	CP8242-R	615 159 0240	Impact Wrenches	12
CP2765	615 192 2765	Screwdrivers Direct drive	20	CP8242-R	615 159 0240	Impact Wrenches	12
CP2780	615 192 2780	Screwdrivers Positive	20	CP825	T023145	Ratchet Wrenches	17
CP3000-515R	615 160 0270	Die Grinders	25	CP825	T023145	Ratchet Wrenches	17
CP3000-518R	615 160 0280	Die Grinders	25	CP8252-P	615 159 0210	Impact Wrenches	12
CP3000-520R	615 160 0290	Die Grinders	25	CP8252-P	615 159 0210	Impact Wrenches	12
CP3000-600CR	615 160 0140	Die Grinders	24	CP8252-R	615 159 0250	Impact Wrenches	12
CP3000-600CR	615 160 0140	Die Grinders	24	CP8252-R	615 159 0250	Impact Wrenches	12
CP3030-518R	615 160 4190	Die Grinders	25	CP825T	T023190	Ratchet Wrenches	17
CP3030-520R	615 160 4200	Die Grinders	25	CP825T	T023190	Ratchet Wrenches	17
CP3040GABTIM	615 160 7010	Angle Grinders 100 mm	28	CP8272-D	615 159 0260	Impact Wrenches	12
CP3040GASTIM	615 160 7020	Angle Grinders 100 mm	28	CP8272-D	615 159 0260	Impact Wrenches	12
CP3070-120G	615 162 0090	Sanders	32	CP8272-P	615 159 0220	Impact Wrenches	12
CP3119-12EL	615 160 2150	Extended Die Grinders	26	CP8272-P	615 159 0220	Impact Wrenches	12
CP3119-12ES	615 160 2110	Extended Die Grinders	26	CP828	T022708	Ratchet Wrenches	17
CP3119-12ES3	615 160 6010	Straight Grinders	26	CP828	T022708	Ratchet Wrenches	17
CP3119-12ES4	615 160 6020	Straight Grinders	26	CP828H	T022970	Ratchet Wrenches	17
CP3119-12EXL	615 160 2160	Die Grinders	26	CP828H	T022970	Ratchet Wrenches	17
CP3119-15ES	615 160 2120	Die Grinders	26	CP835	T022550	Specialty & Cutting Nibblers	46
CP3119-18ES	615 160 2130	Die Grinders	26	CP854	T023186	Angle grinders 100 mm	27
CP3119-22ES	615 160 2140	Die Grinders	26	CP854E	T023187	Angle grinders 125 mm	27
CP3349-SALAVADE	615 160 9110	Vertical Grinders	29	CP857	T024387	Angle grinders 178 mm	28
CP3349-SALAVELE	615 160 9130	Vertical Grinders	29	CP858	T025179	Sanders 10x330	33
CP3349-SALAVETE	615 160 9150	Vertical Grinders	29	CP860	T019704	Die grinders 1/4"	25
CP3450-12AA5	615 160 4040	Angle Grinders	28	CP860E	T021136	Die grinders 1/4"	25
CP3450-12AB5	615 160 4050	Angle Grinders	28	CP860ES	T023193	Die grinders 1/4"	25
CP3451-16SE25	615 160 2020	Straight Grinders	26	CP861	T022039	Specialty & Cutting Cutters	46
CP3451-18SE3	615 160 2030	Straight Grinders	26	CP870	T023990	Sanders 150 mm	32
CP3451-18SEC	615 160 2010	Extended Die Grinder	26	CP871	T025372	Specialty & Cutting Tire buffers	47
CP3850-65AB9VE	615 170 4940	Angle grinders 230 mm	29	CP873	T025374	Specialty & Cutting Tire buffers	47
CP3850-77AB7V	615 170 4960	Angle grinders 180 mm	29	CP874	T025375	Specialty & Cutting Cutters	46
CP3850-85AB7VE	615 170 4920	Angle grinders 180 mm	29	CP879	T023999	Drills 3/8"	36
CP5000	T024585	Impact Wrenches 1"	15	CP881	T023916	Specialty & Cutting Reciprocating saws	46
CP5000	T024585	Impact Wrenches 1"	15	CP887	T025376	Drills 3/8"	36
CP5080-3260D12	615 162 0000	Belt Sanders	33	CP9105Q-B	615 195 2105	Die grinders 1/4"	24
CP5080-4200D24	615 162 0010	Belt Sanders	33	CP9106Q-B	615 195 2106	Die grinders 1/4"	24
CP5080-4200H18	615 162 0020	Belt Sanders	33	CP9108Q-B	615 195 2108	Die grinders 1/4"	24
CP5080-5220H18	615 162 0030	Belt Sanders	33	CP9110Q-B	615 195 2110	Die grinders 1/4"	24
CP6060 SASAB	T024059	Impact Wrenches	13	CP9113G	615 160 0010	Die grinders 1/4"	25
CP6060 SASAB	T024059	Impact Wrenches	13	CP9113GES	615 160 2070	Die grinders 1/4"	25
CP6060 SASAK	T024060	Impact Wrenches	14	CP9120CR	615 195 2120	Angle grinders 100 mm	27
CP6060 SASAK	T024060	Impact Wrenches	14	CP9121AR	615 195 7321	Angle grinders 125 mm	27
CP6060 SASAR	T024058	Impact Wrenches	13	CP9121BR	615 195 7221	Angle grinders 125 mm	27
CP6060 SASAR	T024058	Impact Wrenches	13	CP9121CR	615 195 2121	Angle grinders 125 mm	27
CP6060 ZASAB	T024064	Impact Wrenches	13	CP9122CR	615 195 2122	Angle grinders 115 mm	27
CP6060 ZASAB	T024064	Impact Wrenches	13	CP9356 NS	T022165	Percussive tools Chippers & scalers	41
CP6060 ZASAK	T024063	Impact Wrenches	14	CP9356 WF	T021959	Percussive tools Chippers & scalers	41
CP6060 ZASAK	T024063	Impact Wrenches	14	CP9361	T012644	Percussive tools Engraving pens / Air Scribe®	40
CP6120 GASED	T018237	Impact Wrenches	16	CP9426	615 191 9426	Ratchet Wrenches	17
CP6120 GASED	T018237	Impact Wrenches	16	CP9426	615 191 9426	Ratchet Wrenches	17
CP6120 PASED	T018841	Impact Wrenches	16	CP9427	615 191 9427	Ratchet Wrenches 3/8"	17
CP6120 PASED	T018841	Impact Wrenches	16	CP9427	615 191 9427	Ratchet Wrenches 3/8"	17
CP6500 RS	T025214	Impact Wrenches	13	CP9705	615 193 9705	Specialty & Cutting Air files	47
CP6500 RS	T025214	Impact Wrenches	13	CP9710	615 193 9710	Specialty & Cutting Air files	47
CP6500 RSR	T025216	Impact Wrenches	13	CP9779	615 193 9779	Sanders 10x330	33
CP6500 RSR	T025216	Impact Wrenches	13	CP9780	615 193 9780	Sanders 20x520	33
CP6910 RS	615 190 6910	Impact Wrenches	15	CP9882	894 109 8820	Specialty & Cutting Riveters	47
CP6910 RS	615 190 6910	Impact Wrenches	15	CP9885	615 197 9885	Specialty & Cutting Caulking guns	47
CP6910 RS	615 190 6910	Impact Wrenches	15	GV5	615 174 0170	Percussive tools Pneumatic hammers	42

Chicago Pneumatic Tools follows a policy of continuous product improvement.

Specifications and descriptions are thus subject to change without notice. Check the online catalog at www.cp.com for the latest product information.

General Safety Instructions for the Operation of Power Tools

The goal of Chicago Pneumatic is to produce tools that help the operator work safely and efficiently. The most important safety device for this or any tool is the operator. Care and good judgement are the best protection against injury. All possible hazards cannot be covered here, but we have tried to highlight some of the important ones. Individuals should look for and obey Caution, Warning and Danger Signs placed on tools, and displayed in the workplace. Operators should read and follow safety instructions packed with each tool. For a copy of these instructions, contact your nearest Chicago Pneumatic representative or www.cp.com.

Learn how each tool works. Even if you have previously used similar tools, carefully check out each tool before you use it. Get the "feel" of it and know capabilities, limitations, potential hazards, how it operates and how it stops.



WARNING

Multiple Hazards. Read and understand safety instructions supplied with tool before operating or servicing. Failure to do so can result in serious bodily injury.

All tools are designed to operate on a air line pressure of 6.3 bar +/- 0.15 bar in accordance with ISO2787, 8NTC1.2. Sound levels +/- 3dB(A)* are measured in accordance with EN ISO15744. Vibration values* are measured in accordance with ISO8662 & ISO28927

**These declared values were obtained by laboratory type testing in accordance with the stated standards and are suitable for comparison with the declared values of other tools tested in accordance with the same standards. These declared values are not adequate for use in risk assessments and values measured in individual work places may be higher. The actual exposure values and risk of harm experienced by an individual user are unique and depend upon the way the user works, the workpiece and the workstation design, as well upon the exposure time and the physical condition of the user. We, Chicago Pneumatic, cannot be held liable for the consequences of using the declared values, instead of values reflecting the actual exposure, in an individual risk assessment in a work place situation over which we have no control.*



Compressed Air Hazards

- Air under pressure can cause injury. Never point an air hose at yourself or anyone else. Never blow your clothes free of dust with compressed air. Always direct exhaust air away from yourself and others in the work area.
- Always check for damaged or loose hoses and fittings before using an air tool, and replace if necessary. Whipping hoses can cause serious injury.
- Disconnect the tool from the air supply when not in use, before changing accessories, setting the torque, or when making repairs.
- Do not exceed rated air pressure to increase the output of the tool. This could cause injury and shorten tool life.
- Do not assemble quick coupler on the tool. Vibration can cause breakage resulting in a whipping air hose. Instead, use quick couplers on the end of a short leader hose.
- When universal twist couplings are used, lock pins must be installed to prevent accidental hose disconnection.
- Air tools are not intended for use in explosive atmospheres and are not insulated for contact with electric power sources.



Projectile Hazards for all air tools

- Always wear impact resistant eye and face protection when involved with or near the operation or the repair of air tools.



Noise Hazards

- Hearing loss can result from prolonged exposure to excessive sound levels.
- Use hearing protection as recommended by your employer or OSHA regulation (see 29 CFR part 1910).



Entanglement Hazards

- To reduce the risk of injury from entanglement, do not wear loose clothing when using rotating accessories.



Additional Hazards

- Slip/Trip/Fall is a major cause of serious injury or death. Beware of excess hose/cord left on the walking or work surface.
- Operators and maintenance personnel must be physically fit to perform job tasks, and handle the bulk, weight and power of the tool.
- Deburring tools should be used to reduce risk of cuts and abrasions due to burrs.
- Wear gloves to protect hands from sharp edges.



Breathing Hazards

- Proper breathing protection must be worn when working with materials which produce airborne particles.



Vibration Hazards

- Repetitive work motions, awkward positions and exposure to vibration may be harmful to your hands and arms.
- If numbness, tingling, pain or whitening of the skin occurs, stop using tool and consult a physician.

Specific Safety Instructions for Power Tool Groups

In addition to the General Safety Instructions, the following are safety instructions and warnings that apply to the safe operation of specific power tool groups. Consult ANSI B186.1 Safety Code for Portable Air Tools. Available from: America National Standards Institute (ANSI), 11 W. 42nd St., 13th floor, New York, New York 10036, (212) 642-4900; or the European Committee for Standardization, Rue de Stassart 36, 1050 Brussels, Belgium.

Impact Wrenches



- Never use hand sockets. Use only impact sockets in good condition. Sockets in poor condition reduce impact power and could also shatter, resulting in personal injury.
- When using a universal joint, never free run the tool, it may run too fast and cause the joint to be thrown from the tool.
- Always use the simplest hook-up possible. Long springy extension bars and adapters absorb impact power and could break loose resulting in personal injury. Instead, use deep sockets whenever possible.
- For tools using the pin and o-ring socket retainer, use the o-ring to securely retain the socket pin.

Abrasive Tools



- Never mount a grinding wheel on a sander.
- Never use a grinding wheel marked with a speed lower than the rated air grinder speed.
- All grinding wheels and polishing/sanding accessories should be checked for cracks or other damage before mounting and use.
- Always use the recommended wheel guard to prevent injury when performing grinding operations. If a guard has withstood wheel or disc breakage, it must be replaced.
- Position a guard between the grinding wheel or disc and the operator. Use barriers to protect others from fragments and grinding sparks.
- Make sure grinding wheels are mounted according to manufacturer's specifications; always use correct mounting flanges.
- Before grinding, test grinding wheel or disc by briefly running tool at full throttle. Be sure to use a barrier (such as under a heavy work table) to protect yourself from possible broken wheel parts.
- Never tamper with or remove a speed governor from a tool to make it run faster. Periodically check tool speed with a tachometer.

Assembly Tools



- Serious injury can result from over-torqued or under-torqued fasteners, which can break, or loosen and separate.
- Released assemblies can become projectiles. Assemblies requiring a specific torque must be checked using a torque meter.

Hammers



- All chisels, rivet sets and other accessories should be checked for cracks, excessive wear, or other physical damage before each use. Accessories that show signs of damage should be replaced immediately.
- Never use a tool without the proper accessory retainer.

Drills



- Keep away from rotating bit and chuck. You can become cut or burned if you come in contact with the drill bit, chips or work surface.
- Use intermittent drill pressure to avoid long shaved chips.
- The drill bit can suddenly bind and cause the work piece or tool to rotate causing arm and shoulder injuries.
- ANSI recommends use of a support handle on drills with a chuck larger than 3/8" (10 mm).

Accessories



- Always use accessories of correct size and design for the tool. Tool and accessories must not be modified in any way.
- Never use a tool without the proper accessory retainer.

See Safety Requirements for Abrading Materials with Coated Abrasives (B7.7) from ANSI.

Conversion Table

LENGTH		
1 Inch (in.)	0.0254 m	25.4 mm
1 Foot (ft.)	0.3048 m	304.8 mm
WEIGHT		
1 Ounce (oz.)	0.02835 kg	28.35 g
1 Pound (lb.)	0.454 kg	454 g
1 kg	2.2046 lb	
VOLUME		
1 US Gallon	3.785 l	

POWER	
1 kpm/s	9.8067 W
1 hp	745.7 W
1 kW	1.3410 hp
TORQUE	
1 kpm	9.8067 Nm
1 ft-lb	1.3558 Nm
1 in-lb	0.1130 Nm
1 Nm	0.1020 kpm
1 Nm	0.7376 ft-lbs

AIR PRESSURE	
1 bar	100 kPa
1 kp/cm ² (at)	98.0665 kPa
1 psi	6.8948 kPa
AIR FLOW	
1 m ³ /min	16.6667 l/s
1 cfm	0.4720 l/s
1 m ³ /h	0.2778 l/s
1 l/s	2.1189 cfm



Over 110 years of experience

Since 1901 the Chicago Pneumatic (CP) name has represented reliability and attention to customer needs, with construction, maintenance and production tools and compressors designed for specific industrial applications. Today, CP has a global reach, with local distributors around the world.

Our people start every single day with a passion to research, develop, manufacture and deliver new products that are meant to meet your needs not only today, but tomorrow as well.
To learn more, visit www.cp.com.

IDEMCO

W : www.idemcosb.com.my
E : idemco@idemcosb.com.my
T : +6 03-7781 7973



**Chicago
Pneumatic**

www.cp.com