

CONTENTS

SKYHOOK™ SYSTEM.	14-15
HEAT SHRINK LOOPS	19
D-RINGS & SEALING TAPE	20
SPLIT RINGS & TOOL COLLARS.	21
RETROFIT KITS	22
CINCH LOOP	22
LANYARDS	23-25
WRIST CUFFS & WRIST STRAPS	23
POCKETS & POUCHES.	26-27
BUCKETS	27
TOOL BELTS	28
TETHER-READY SOCKETS & SOCKET SETS	29-40
TETHER-READY HEX BITS & SETS.	31, 34 & 39
1/2" & 3/8" DRIVE	
TETHER-READY RATCHETS	40
TETHER-READY TORQUE WRENCHES	41
TETHER-READY WRENCHES	
& WRENCH SETS	42-51
TETHER-READY STRIKING & STRUCK TOOLS.	52-53
TETHER-READY PUNCH, CHISEL	
& PRY BAR SETS	54-55
TETHER-READY PLIERS	56-59
TETHER-READY LOCKING,	
WIRE TWISTER & WIRE STRIPPER	59
TETHER-READY T-HANDLE HEX	
& FOLDING HEX KEYS	60-61
TETHER-READY DURATEK™ SCREWDRIVERS.	62-63
TETHER-READY SPECIALTY TOOLS	64-66

志發
CHEE FATT

TETHERED TOOLS

PROTO®



TOOL DROP PREVENTION

The SkyHook™ Tether & Transfer System is comprised of switches, docks, lanyards and carabiners, all designed to make tool control as complete as possible with little interference to tool function.

THE SKYHOOK™ AND THE SKYDOCK™

- › The SkyHook™ switch connector tethers to the tool on a short lanyard.
- › The SkyDock™ attachment securely anchors the SkyHook™ to wrist, belt, or apron.



01: TOOL IS SAFELY LOCKED.



02: USE SWITCH CONNECTOR TO TRANSFER.

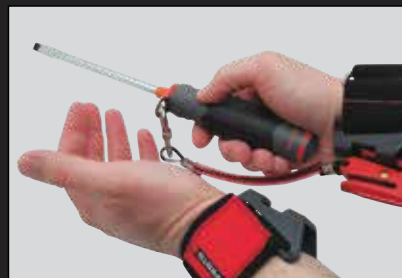

03: TRANSFER TOOL AFTER CONNECTOR SAFELY LOCKS.

BREADTH OF LINE

PROTO® tethered tools offers a wide range of retrofit supplies to secure existing tools to a belt, person or workstation.



LOOPS & COLLARS

- Heat Shrink Loops
- Cylindrical Loops
- Tool Collars



TETHERS

- Swivel Tethers
- Cinch Loop Tethers
- Drill Boot Tethers
- Swivel Cup Tethers
- Glove Tethers
- Eyeglass Retainers



STORAGE

- Pockets
- Pouches
- Buckets
- Bags



BELTS

- With and Without Carabiners
- Retractors
- Double-Up Retractors



CLASPS & CONNECTORS

- D-rings
- Quick Connector
- Split Rings
- Badge Clips
- Rope Clips
- Metal Clips



LANYARDS

- Hard Hat Lanyards
- Neck Lanyards
- Wrist Lanyards
- Wire Lanyards
- Web Lanyards
- Elastic Lanyards



- Swivel Coil Lanyards
- Retractable Lanyards
- Non-Metallic Lanyards
- Break-Away Lanyards
- Pen & Pencil Lanyards
- Camera Lanyards



THE PROTO® SKYHOOK™ TETHER & TRANSFER SYSTEM:

The next generation of safety technology for positive control of hand tools at height, in work areas requiring foreign material exclusion (FME) or anywhere simple accidents become costly mistakes. Since a better tether system is a safer tether system, SkyHook™ provides secure tool transfers, a free range of motion, and positive tool control at the work site.

**"TOOL IS COMPLETELY
SECURE
DURING TRANSFER"**

Just "Swipe to Switch".
Hand-to-hand, hand-to-belt, person-to-person
or person-to-station, the transfer is the same.





The SkyHook™ will only disengage once it is engaged to another SkyDock™.



You can hold the tool during transfer.
The SkyHook™ does not require hands to make the switch.

SKYHOOK™ TOOL & TRANSFER SYSTEM

The SkyHook™ tether & transfer system features a screw-gate carabiner at one end and a SkyHook™ Safety Switch at the other. Tether-Ready Tools attach to the carabiner and the SkyHook™ connects safely to a SkyDock™. SkyDocks™ are available individually as well as on wrist straps, pouches and other products.



SKYHOOK™ COMPONENTS

Product #	Name	Description
JPS	SkyHook™ Switch Connector	SkyHook™ switch connector with lanyard and carabiner
JPSDOCK	SkyDock™ Storage Attachment	SkyDock™ storage attachment point
JWS-SH	SkyDock™ Wrist Strap	SkyDock™ wrist attachment point



SKYHOOK™ TOOL KITS

Product #	Name	Description
JPS1	SkyHook™ Kit for 1 Tool	(1) SkyHook™ (1) SkyDock™ and (1) SkyDock™ Wrist Strap
JPS2	SkyHook™ Kit for 2 Tools	(2) SkyHooks™ (2) SkyDocks™ and (2) SkyDock™ Wrist Straps
JPSSCAFF4	SkyHook™ Kit for 4 Tools	(4) SkyHooks™ (4) SkyDocks™ and (2) SkyDock™ Wrist Straps
JPSSCAFF5	SkyHook™ Kit for 5 Tools	(5) SkyHooks™ (5) SkyDocks™ and (2) SkyDock™ Wrist Straps
JPS1	SkyHook™ with SkyDock™	(1) SkyHook™ and (1) SkyDock™ (No Wrist Strap)



SKYHOOK™ POCKET KITS

Product #	Name	Description
JPSTLPKT1	SkyHook™ Single Dock Pocket Kit	Single Dock Pouch with (1) SkyHook™ switch connector
JPSTLPKT2	SkyHook™ Dual Dock Pocket Kit	Dual Dock Pouch with (2) SkyHook™ switch connectors
JPSTLPKT3	SkyHook™ Three Dock Pocket Kit	Three Dock Pouch with (3) SkyHook™ switch connectors

JPSTLPKT2



SKYHOOK™ HAMMER KIT

Product #	Name	Description
JPSHS	SkyHook™ Hammer Kit	Holder for Hammer with (1) SkyHook™ switch connector



SKYHOOK™ TAPE POCKET

Product #	Name	Description
JPSTAPE	SkyHook™ Tape Pocket	Tape Measure Pouch with (1) SkyHook™ switch connector



SKYHOOK™ BOLT BAG

Product #	Name	Description
JPSBOLT	SkyHook™ Dual Dock Bolt Bag Kit	Dual Dock Bolt Bag with (2) SkyHook™ switch connectors



SKYHOOK™ SADDLE KIT

Product #	Name	Description
JPSSDLSM	SkyHook™ 8-Tool Saddle Kit	18" 8-Pocket Saddle featuring (8) integrated SkyDocks™ with (8) SkyHook™ switch connectors



SKYHOOK™ APRON KIT

Product #	Name	Description
JPSAPRON30	SkyHook™ 6-Dock Apron Kit	30" 6-Pocket Apron featuring (6) integrated SkyDocks™ with (6) SkyHook™ switch connectors





PROTO® TETHERED TOOLS OFFERS A WIDE RANGE OF RETROFIT SUPPLIES to secure existing tools to a belt, person or workstation. One size certainly does not fit all tools and all situations, so Proto® has expanded the range of collars, loops, lanyards, tethers, and storage options.

"EXISTING INVENTORY – RETROFIT OPTIONS"



SELECTING THE RIGHT ATTACHMENT TO THE RIGHT TOOL IS IMPORTANT. Collars are good for tools with long shanks like screwdrivers and punches. Shrink loops are used for tools with narrow necks and wide ends like wrenches and wide-edge chisels. Tools with complete openings, like the handle ends of adjustable wrenches, would use cinches or clasps.



Check out our YouTube page at
youtube.com/protoindustrial for "How To" videos.

SELECTION GUIDE

SHRINK LOOP ATTACHMENTS

SIZING

Part #	Tool Diameter (in)	Tool Weight Rating (lb/kg)
JP2R34X175LPOR	0.25 to 0.50	4/1.8
JP2R1X175LPOR	0.36 to 0.75	5/2.2
JP2R15X2LPOR	0.55 to 1.25	10/4.4
JP2R2X2LPOR	0.75 to 1.75	15/6.8
JP2R2X4LPOR	0.75 to 1.75	25/11.3
JP2R275X2LPOR	1.50 to 2.50	20/9
JP2R275X4LPOR	1.50 to 2.50	25/11.3
JP2R4X4LPOR	2.25 to 3.50	25/11.3

SIZING



Tools must have appropriate narrow geometry. Measure diameter at narrowed area of tool.

SIZING



Tools lacking appropriate narrow geometry.

TOOL LANYARDS - JLAN SERIES

WEIGHT RATINGS

Part #	Weight Rating (lb/kg)
JLAN15LBSSCAR	15/6.8
JLAN15LBDSS	15/6.8
JLAN15LBSSRP	15/6.8
JLAN15LB3LK	15/6.8
JLAN20LBD3LK	20/9
JLAN25LBDSS	25/11
JLAN40LBD3LK	40/18
JLAN40LBD3LKSW	40/18

Ensure the tool weight does not exceed the tool lanyard rating. Never exceed a tool lanyard weight limit for any reason.

TOOL ATTACHMENTS GUIDE

PROPER



Attach on tool areas that are fully closed or to Proto® brand attachment devices.

IMPROPER



Avoid tangles. Do not cinch without appropriate attachment point.

TOOL COLLARS

Part #	Tool Min. Dia. (in)	Tool Max. Dia. (in)	Tool Max. Weight Limit (lbs)
JTC0	0.035	0.094	0.10 lb
JTC1	0.094	0.156	0.10 lb
JTC2	0.156	0.250	0.13 lb
JTC3	0.219	0.313	0.32 lb
JTC4	0.313	0.438	0.60 lb
JTC5	0.400	0.540	0.67 lb
JTC6	0.54	0.79	1.20 lbs
JTC7	0.79	1.00	4.00 lbs

TOOL COLLAR TETHER LOOPS

Part #	Opening Dia. (in)
JTL1SS	0.14 Keyed
JTL2SS	0.21 Keyed
JTL3SS	0.27 Keyed
JTL4SS	0.35 Keyed
JTL5SS	0.61
JTL6SS	0.85
JTL7SS	1.10

LANYARD ATTACHMENT TAPE

WEIGHT RATINGS

Tape #	D-ring Webbing Part #	
	JDRSMOR	JDRHDOOR
JMOL36RFOR	3/4-inch Wide - (3 lbs)	1-1/2-inch Wide - (3 lbs)

Ratings are based on cylindrical test modules in a perpendicular configuration and may or may not represent field configurations. End user must make determination of suitability.

SIZING



Tools must have appropriate narrow geometry. Measure diameter at narrowed area of tool.

REQUIRED AMOUNT

Tool Dia. (in)	Estimated Tape Amount (in)
0.25	8.5
0.50	17
1.00	33
2.00	66

For other tool sizes, multiply the average diameter by 24. If unsure of amount, it is better to overestimate.



ATTACHMENT POINTS LOOPS & DELUXE ATTACHMENT SYSTEM

Existing tools can be retrofitted with the same Proto® Industrial Tether Attachments used in the general product line.

HEAT SHRINK LOOPS

- ▶ Superior strength over conventional heat shrink methods.
- ▶ Easy installation, quick attachment to lanyards, and eliminates confusion with matching D-ring webbing to proper shrink rings.
- ▶ Designed to keep the stitching away from the heat source to prevent damage to the stitching common with conventional methods. Prevents webbing from slipping out of the heat shrink.
- ▶ Allows for proper labeling of each shrink loop containing load limits, usage instructions and precautions.



Product #	Name	Size (in W x in L)	Max. Tool Weight (lbs)	Type	Pack Qty.	Brand
JP2R34X175LPOR	Heat Shrink Loop	0.75 x 1.75	4	Heavy-Duty	25	Proto®
JP2R1X175LPOR	Heat Shrink Loop	1.10 x 1.75	5	Heavy-Duty	25	Proto®
JP2R15X2LPOR	Heat Shrink Loop	1.50 x 2.00	10	Heavy-Duty	25	Proto®
JP2R2X2LPOR	Heat Shrink Loop	2.00 x 2.00	15	Heavy-Duty	25	Proto®
JP2R2X4LPOR	Heat Shrink Loop	2.00 x 4.00	25	Heavy-Duty	25	Proto®
JP2R275X2LPOR	Heat Shrink Loop	2.75 x 2.00	20	Heavy-Duty	25	Proto®
JP2R275X4LPOR	Heat Shrink Loop	2.75 x 4.00	25	Heavy-Duty	25	Proto®
JP2R4X4LPOR	Heat Shrink Loop	4.00 x 4.00	25	Heavy-Duty	25	Proto®

HEAT SHRINK LOOP SAMPLE KIT

Product #: JP2RSMPLKIT

- ▶ One of each standard size used for determining proper fit.
- ▶ See page 66 for Heat Gun.

Contents	Size (in W x in L)	Type	Brand
JP2R34X175LPOR	0.75 x 1.75	Heavy-Duty	Proto®
JP2R1X175LPOR	1.10 x 1.75	Heavy-Duty	Proto®
JP2R15X2LPOR	1.50 x 2.00	Heavy-Duty	Proto®
JP2R2X2LPOR	2.00 x 2.00	Heavy-Duty	Proto®
JP2R2X4LPOR	2.00 x 4.00	Heavy-Duty	Proto®
JP2R275X2LPOR	2.75 x 2.00	Heavy-Duty	Proto®
JP2R275X4LPOR	2.75 x 4.00	Heavy-Duty	Proto®
JP2R4X4LPOR	4.00 x 4.00	Heavy-Duty	Proto®



D-RING WEBBING

- › For use with sealing tape or heat shrink loops.



JDRSMOR

Product #	Name	Size (in)	Length (in)	Color	Pack Qty.
JDRHDOR	Heavy-Duty Web Tether with Metal D-ring	1.00	3.50	Orange	25
JDRSMOR	Standard Web Tether with Metal D-ring	0.50	2.50	Orange	25

MOLECULAR SEALING TAPE

- › Used for attaching D-ring webbing to tools.
- › No heat gun necessary.
- › Bonds to itself and not the tool.
- › Installs in seconds (stretch, wrap, and go).
- › Will not peel off, must be cut.
- › No residue.
- › For use with tethers of 12 inches or less.



JMOL36RFOR

Product #	Name	Type	Size (in x ft)	Thickness (in)	Color
JMOL36RFOR	Molecular Sealing Tape	Reinforced	1 x 36	0.020	Orange

WEB D-RING & TAPE SAMPLE KIT

Product #: JDRSMPKIT

- › One of each size to determine proper fit.

Contents	Description	Brand
JDRHDOR	HD D-ring Web Tethers	Proto®
JDRSMOR	D-ring Web Tethers	Proto®
N/A	Sealing Tape - 2 feet	Proto®





SPLIT RINGS

- › Installs easily to manufacturers pre-drilled tether holes.
- › Fits tools of significant geometry.
- › Create a tether ring on the fly.
- › Weight Rated - Max Tool Weight 2 lbs.
- › Semi-permanent attachment of tools to lanyards.
- › For use with tethers of 12 inches or less.

Product #	Name	Diameter (in)	Brand
JSR04	Tether Split Ring	0.40	Proto®
JSR06	Tether Split Ring	0.60	Proto®
JSR1	Tether Split Ring	1.00	Proto®
JSR125	Tether Split Ring	1.25	Proto®
JSR15	Tether Split Ring	1.50	Proto®
JSR2	Tether Split Ring	2.00	Proto®



TOOL COLLAR® KITS

- › Sizes below are used to determine proper fit.



Product #	Name	Description	Type	Pack Qty.	Brand
JPCL0SS	Tool Collar® (JTC0) & Loop (JTL1SS)	For tools from 0.035 to 0.094-in diameter	Metal Ring	10	Proto®
JPCL1SS	Tool Collar® (JTC1) & Loop (JTL2SS)	For tools from 0.094 to 0.156-in diameter	Metal Ring	10	Proto®
JPCL2SS	Tool Collar® (JTC2) & Loop (JTL3SS)	For tools from 0.156 to 0.250-in diameter	Metal Ring	10	Proto®
JPCL3SS	Tool Collar® (JTC3) & Loop (JTL4SS)	For tools from 0.219 to 0.313-in diameter	Metal Ring	10	Proto®
JPCL4SS	Tool Collar® (JTC4) & Loop (JTL5SS)	For tools from 0.313 to 0.438-in diameter	Metal Ring	10	Proto®
JPCL5SS	Tool Collar® (JTC5) & Loop (JTL5SS)	For tools from 0.400 to 0.540-in diameter	Metal Ring	10	Proto®
JPCL6SS	Tool Collar® (JTC6) & Loop (JTL6SS)	For tools from 0.540 to 0.790-in diameter	Metal Ring	10	Proto®
JPCL7SS	Tool Collar® (JTC7) & Loop (JTL7SS)	For tools from 0.790 to 1.000-in diameter	Metal Ring	10	Proto®

TOOL COLLAR® SAMPLE KIT

Product #: **JPCLSMPLKIT**

- › One of each metal ring size used for determining proper fit.

Contents	Description	Brand
JPCL0SS	0.035 to 0.094"	Proto®
JPCL1SS	0.094 to 0.156"	Proto®
JPCL2SS	0.156 to 0.250"	Proto®
JPCL3SS	0.219 to 0.313"	Proto®
JPCL4SS	0.313 to 0.438"	Proto®
JPCL5SS	0.400 to 0.540"	Proto®
JPCL6SS	0.540 to 0.790"	Proto®
JPCL7SS	0.790 to 1.00"	Proto®



RETROFIT KITS

- › A number of attachment point creation tools all in one location.
- › Portable kit used to bring directly to job locations.
- › Standard heat gun required for shrink ring assembly.

5-TOOL TETHERING KIT

Product #: **JPSSCAFF5KIT**

- › Recommended tether attachments for a tape rule, (2) pliers, hammer, and level.

Contents	Description	Brand
JTAPESLV	Tape Measure Holder	Proto®
N/A	Heat Shrink Loop	Proto®
N/A	(2) Sealing Tapes – 12"	Proto®
JSR15 & JSR2	(2) Key Rings	Proto®
JDRSMOR	(2) Web D-ring	Proto®



SWIVEL TETHER CINCH LOOP

- › For use on tools with a pre-drilled hole or slot.
- › Useful on applications where key rings and other solid anchors are cumbersome.
- › Features patented swivel.



Product #	Name	Max. Tool Weight (lbs)	Pack Qty.	Brand
T-TETHCNCHLPSW	Swivel Tether Cinch Loop	10	10	Ty-Flot



LANYARDS

PPE, WRIST & TOOL



HARD HAT LANYARDS

HARD HAT LANYARDS

- ▶ The Proto® hard hat lanyard is a great way to prevent your hard hat from becoming a dropped object. It can be used with almost any hard hat, and is a comfortable alternative to the traditional "chin strap."
- ▶ While keeping your helmet secure, the patented lanyard, attaches to an outer garment never impeding on the comfort or use of the hard hat.
- ▶ All Proto® Hard Hat lanyards feature an "easy release" where you may disengage the side release buckle, leaving one piece secured to the hard hat, and the other still attached to an outer garment. When ready to use the hard hat again, simply reengage the side release buckle.

Product #	Name	Color	Pack Qty.	Brand
JLANHATRD	Hard Hat Lanyard*	Red	100	Proto®
JLANHATRD10	Hard Hat Lanyard*	Red	10	Proto®

*Hard hat not included. Check out our YouTube page at youtube.com/protoindustrial for "How To" videos.

D-RING WRIST STRAP SYSTEM

- ▶ Completely forged D-Ring.
- ▶ Reinforced elastic fabric for safe but comfortable wrist control.
- ▶ All metal components to provide strong protection.
- ▶ 12" length lanyard to prevent entanglement in work.
- ▶ One carabiner that swivels to allow tool use in multiple and convenient positions.
- ▶ Two stainless steel carabiners with screw gate.



JDR2

Product #	Name	Size (in) L/W/H	Max. Tool Weight (lbs)	Brand
JWS-DR	Tethering D-Ring Wrist Strap	13 / 2 / 0.25	6	Proto®
JLANWR6LB	Tethering D-Ring Wrist Strap Lanyard	12 / 1 / 0.25	6	Proto®
JDR1	Tethering D-Ring Wrist Strap System with (1)JWS-DR and (1)JLANWR6LB	—	6	Proto®
JDR2	Tethering D-Ring Wrist Strap System with (2)JWS-DR and (2)JLANWR6LB	—	6	Proto®
JDR4	Tethering D-Ring Wrist Strap System with (2)JWS-DR and (4)JLANWR6LB	—	6	Proto®



TOOL LANYARDS - WIRE

- › Heavy-duty lanyards for use with large tools.
- › 10-15 lbs max. weight tool limit.
- › Swivel option on some lanyards to prevent entanglement.



T-L48WR153T

Product #	Name	Attachment	Length (in)	Max. Tool Weight (lbs)	Brand
T-L48WR153T	Wire Lanyard	Trip action lock	48	15	Ty-Flöt
T-L48WR153TSW	Wire Swivel Lanyard	Trip action lock	48	15	Ty-Flöt

TOOL LANYARDS - ELASTIC

- › Internal bungee cord with nylon outer sheathing on dual carabiner lanyards.
- › Lanyards with one carabiner have elastic woven into the webbing providing longevity versus standard elastic lanyards.



JLAN15LBSSRP

Product #	Name	Attachment	Retracted Length (in)	Extended Length (in)	Max Tool Weight (lbs)	Brand	ANSI Spec.
JLAN15LBSSRP	Elastic Lanyard	(1) Screw Gate Carabiner	32	48	15	Proto®	ANSI 121-2018
JLAN15LB3LK	Elastic Lanyard	(1) Triple Lock Carabiner	32	48	15	Proto®	—
JLAN20LBD3LK	Elastic Lanyard	(2) Triple Lock Carabiners	27	52	20	Proto®	—
JLAN25LBDSS	Elastic Lanyard	(2) Screw Gate Stainless Steel Carabiners	45	118	25	Proto®	ANSI 121-2018

TOOL LANYARDS - WEB

- › Heavy-duty lanyards for use with large tools.
- › Swivel option on some lanyards to prevent entanglement.



JLAN40LBD3LKSW

Product #	Name	Attachment	Length (ft)	Max Tool Weight (lbs)	Color	Pack Qty.	Brand
JLAN40LBD3LKSW	Web Lanyard	(2) Triple Lock Swivel Carabiners	4	40	Orange	1	Proto®
JLAN40LBD3LK	Web Lanyard	(2) Triple Lock Carabiners	4	40	Orange	1	Proto®
T-L72403TSWLP	Web Lanyard	Triple Action Lock & Swivel	6	40	Orange		Ty-Flöt

ANSI 121-2018



TOOL LANYARDS - METALLIC

- › High strength nylon webbing.
- › Quick and easy trigger snap hook or positive control screw gate.
- › Laminated and non-laminated versions.



Screw Gate

Product #	Name	Size (in)	Max. Tool Weight (lbs)	Color	Pack Qty.	Brand
T-SGS120R	Positive Control Tool Lanyard Screw Gate	12	10	Orange	10	Ty-Flöt
T-SGS240R	Positive Control Tool Lanyard Screw Gate	24	10	Orange	10	Ty-Flöt

RETRACTABLE TOOL LANYARDS

- › Attach to belt loops or harness D-rings.



Product #	Name	Description	Retracting Length (in)	Max. Tool Weight (lbs)	Retractor Force (oz)	Brand
T-HDRF810*	Heavy-Duty Retractor Pull with Carabiner	—	48	1	8 - 10	Ty-Flöt
T-1045601	Retractor Tool Lanyard with Belt Mount	Snap/Belt Mount	38	1	3	Ty-Flöt
T-TRSK8S	Retractor Locking Tool Lanyard	Belt (1.55" wide) or Carabiner Mounted	40	1	—	Ty-Flöt

* Do not force or bend the spring gate laterally as this will render the carabiner ineffective and create the potential for small parts to be released.

GLOVE TETHERS

- › Keep gloves and ear protection at an arm's reach.
- › Two styles for optimal use in any situation.
- › Reduce the cost of lost gloves and time spent searching for PPE.
- › Attach to belt loops or any convenient location.
- › Easy opening.
- › Features a breakaway.



Product #	Name	Description	Pack Qty.	Brand
JPPEGLV	PPE Caddy® Glove Holder	Secures gloves to belt loop	50	Proto®
JPPEGLV10	PPE Caddy® Glove Holder	Secures gloves to belt loop	10	Proto®
JPPEGLVPOU	PPE Caddy® Glove Holder/Pouch	Glove holder with pouch to hold ear protection	50	Proto®
JPPEGLVPOU10	PPE Caddy® Glove Holder/Pouch	Glove holder with pouch to hold ear protection	10	Proto®



STORAGE POCKETS, POUCHES & BUCKETS

TAPE MEASURE POCKET

- › Designed to conveniently hold a wide variety of tape measures.
- › Fits up to 2-inch tool belts.
- › Includes tape sleeve attachment for tape measure.
- › Ballistic nylon.

Product #	Name	Description	Max. Tool Weight (lbs)	Brand
JTAPESLV	Tethered Tape Rule Sleeve	Tethered tape rule sleeve with D-ring	2	Proto®



RETRACTABLE HAMMER / RATCHET POCKET

- › Designed for hammers and scaffold ratchets.
- › Fits up to 2-inch tool belts.
- › 42-inch Retractor with lock.
- › Ballistic nylon.

Product #	Name	Description	Max. Tool Weight (lbs)	Brand
T-RETHR	Retractable Hammer/Ratchet Pocket	42-inch Retractor with lock. Spectra cord	2	Ty-Flöt



RETRACTABLE 4 POCKET TOOL POUCH

- › Designed to hold hammers, scaffold ratchets, level, pliers, and tape measure.
- › Fits up to 2-inch tool belts.
- › 4 Retractors, 2 lanyard attachment points.
- › Ballistic nylon.



Product #	Name	Description	Max. Tool Weight (lbs)	Brand
T-RET4PKT	Retractable 4 Pocket Pouch - EZ Clean	(4) Retractors and (2) lanyard attachment points. Spectra cord	(1) for small retractors (2) for large retractors	Ty-Flöt



RETRACTABLE POUCH

- › 3 Ft. retractable lanyard rated to 1.5 lbs.
- › Removable retractor.
- › Strong & durable ballistic nylon.



Product #	Name	Description	Length (in)	Width (in)	Height (in)	Max. Tool Weight (lbs)	Brand
JRETPOU1	1-Pocket Retractable Pouch	Tethering D-Ring 1-Pocket Retractable Pouch	11	4	0.5	1.5	Proto®
JRETPOU2	2-Pocket Retractable Pouch	Tethering D-Ring 2-Pocket Retractable Pouch	11	4	0.5	1.5	Proto®
JRETSET1	1-Pocket Retractable Pouch Set	Tethering D-Ring Pouch Set with 1-Pocket, Retractable Lanyard, and D-Ring Wrist Strap System with (2)JWS-DR and (2)JLANVR6LB	11	4	0.5	1.5	Proto®
JRETSET2	2-Pocket Retractable Pouch Set	Tethering D-Ring Pouch Set with 2-Pockets, Retractable Lanyard, and D-Ring Wrist Strap System with (2)JWS-DR and (2)JLANVR6LB	11	4	0.5	1.5	Proto®

ANTI-SPILL POUCHES

- › Buckle closure.
- › Ballistic nylon.
- › Adaptable with 3-inch belts.



Product #	Name	Description	Brand
T-TLPC9X9SCL	Self Closing Parts Pouch	9" x 9" Buckle closure. Ballistic nylon	Ty-Flöt

TOOL BUCKETS



JBUCK300LBZP



Product #	Name	Description	Size (in Dia. x in Deep)	Max. Tool Weight (lbs)
JBUCK300LBZP	Tethering D-Ring Lift Bucket	Tethering D-Ring Lift Bucket with Swivel Triple Lock Carabiner	13 x 15	300
JBUCKSET	Tethering D-Ring Lift Bucket Set	Tethering D-Ring Lift Bucket Set with D-Ring Wrist Strap System (2)JWS-DR and (6)JLANVR6LB	13 x 15	300

ACCESSORIES

BELTS & RETRACTORS



JBELTSET-L

TOOL BELT SETS

Product #	Name	Description	Size (in)	Color	Brand
JBELTSET-M	Comfort Belt Set Medium	Tethering Medium Comfort Belt Set with (2) Belt Adapter (JBELTAD2) and D-Ring Wrist Strap System (2)JWS-DR and (2)JLANVR6LB	28 - 40	■ Black	Proto®
JBELTSET-L	Comfort Belt Set Large	Tethering Large Comfort Belt Set with (2) Belt Adapter (JBELTAD2) and D-Ring Wrist Strap System (2)JWS-DR and (2)JLANVR6LB	40 - 54	■ Black	Proto®

TOOL BELTS

Product #	Name	Description	Size (in)	Color	Brand
JBELTCM-M	Comfort Belt Medium	Tethering Comfort Belt	28 - 40	■ Black	Proto®
JBELTCM-L	Comfort Belt Large	Tethering Comfort Belt	40 - 54	■ Black	Proto®

TOOL BELT ADAPTER WITH CARABINERS



JBELTAD2

Product #	Name	Description	Size (in)	Color	Brand
JBELTAD2	Belt Adaptor with (2) Carabiners	(2) Screw Gate Carabiners	2	■ Orange	Proto®



SOCKETS, DRIVE TOOLS & ACCESSORIES

All Proto® Tethered Tool Sockets, Ratchets, and Torque Wrenches feature a Positive Control Pin Detent System. Unlike the usual ball detent that only provides friction to retain the socket, the Positive Control System requires a separate tool (such as a punch pin) to attach or remove the socket. These sockets cannot be removed without specific intent.



3/8" DRIVE 21 PIECE METRIC SOCKET SET - 12 POINT

Product #: J52215-TT

Contents	Description	MM
J5206M-TT	Socket, 3/8" DR 6 mm 12 PT	
J5207M-TT	Socket, 3/8" DR 7 mm 12 PT	
J5208M-TT	Socket, 3/8" DR 8 mm 12 PT	
J5209M-TT	Socket, 3/8" DR 9 mm 12 PT	
J5210M-TT	Socket, 3/8" DR 10 mm 12 PT	
J5211M-TT	Socket, 3/8" DR 11 mm 12 PT	
J5212M-TT	Socket, 3/8" DR 12 mm 12 PT	
J5213M-TT	Socket, 3/8" DR 13 mm 12 PT	
J5214M-TT	Socket, 3/8" DR 14 mm 12 PT	
J5215M-TT	Socket, 3/8" DR 15 mm 12 PT	
J5216M-TT	Socket, 3/8" DR 16 mm 12 PT	
J5217M-TT	Socket, 3/8" DR 17 mm 12 PT	
J5218M-TT	Socket, 3/8" DR 18 mm 12 PT	
J5219M-TT	Socket, 3/8" DR 19 mm 12 PT	
J5220M-TT	Socket, 3/8" DR 20 mm 12 PT	
J5221M-TT	Socket, 3/8" DR 21 mm 12 PT	
J5222M-TT	Socket, 3/8" DR 22 mm 12 PT	
J5223M-TT	Socket, 3/8" DR 23 mm 12 PT	
J5224M-TT	Socket, 3/8" DR 24 mm 12 PT	
J5225M-TT	Socket, 3/8" DR 25 mm 12 PT	
J5226M-TT	Socket, 3/8" DR 26 mm 12 PT	
J2585	Socket, Bar 9"	
J2588	Socket, Bar 11"	
J2591	Socket, Clip 3/8" DR	

- › 12 Point Standard: 6, 7, 8, 9, 10, 11, 12, 13, 14, 15, 16, 17, 18, 19, 20, 21, 22, 23, 24, 25, 26 mm.
- › Accessories: 9- and 11-inch Socket Bars, and 21 Socket Clips.



Weight (lbs): 2.98

AS954E S3.8.1 ASME B107.1



WARNING: WORK SAFELY WITH TOOLS. WEAR SAFETY GOGGLES.

+1.800.800.TOOL • Fax: +1.800.828.7809 • www.protoindustrial.com

3/8" DRIVE 18 PIECE METRIC DEEP SOCKET SET - 12 POINT

Product #: J52207-TT

- › 12 Point Deep: 6, 7, 8, 9, 10, 11, 12, 13, 14, 15, 16, 17, 18, 19, 20, 21, 22, 23 mm.
- › Accessories: 17-inch Socket Bar and 18 Socket Clips.



Contents	Description	MM
J5006M-TT	Socket, 3/8" DR Deep 6 mm 12 PT	
J5007M-TT	Socket, 3/8" DR Deep 7 mm 12 PT	
J5008M-TT	Socket, 3/8" DR Deep 8 mm 12 PT	
J5009M-TT	Socket, 3/8" DR Deep 9 mm 12 PT	
J5010M-TT	Socket, 3/8" DR Deep 10 mm 12 PT	
J5011M-TT	Socket, 3/8" DR Deep 11 mm 12 PT	
J5012M-TT	Socket, 3/8" DR Deep 12 mm 12 PT	
J5013M-TT	Socket, 3/8" DR Deep 13 mm 12 PT	
J5014M-TT	Socket, 3/8" DR Deep 14 mm 12 PT	
J5015M-TT	Socket, 3/8" DR Deep 15 mm 12 PT	
J5016M-TT	Socket, 3/8" DR Deep 16 mm 12 PT	
J5017M-TT	Socket, 3/8" DR Deep 17 mm 12 PT	
J5018M-TT	Socket, 3/8" DR Deep 18 mm 12 PT	
J5019M-TT	Socket, 3/8" DR Deep 19 mm 12 PT	
J5020M-TT	Socket, 3/8" DR Deep 20 mm 12 PT	
J5021M-TT	Socket, 3/8" DR Deep 21 mm 12 PT	
J5022M-TT	Socket, 3/8" DR Deep 22 mm 12 PT	
J5023M-TT	Socket, 3/8" DR Deep 23 mm 12 PT	
J2587	Socket Bar, 17"	
J2591	Socket Clip, 3/8" DR	

Weight (lbs): 2.98

AS954E S3.8.1 ASME B107.1

3/8" DRIVE 13 PIECE SOCKET SET - 12 POINT

Product #: J52124-TT

- › 12 Point Standard: 1/4, 5/16, 3/8, 7/16, 1/2, 9/16, 5/8, 11/16, 3/4, 13/16, 7/8, 15/16, 1".
- › Accessories: 13-inch Socket Bar with 13 Socket Clips.



Contents	Description	INCH
J5208-TT	Socket, 3/8" DR 1/4" 12 PT	
J5210-TT	Socket, 3/8" DR 5/16" 12 PT	
J5212-TT	Socket, 3/8" DR 3/8" 12 PT	
J5214-TT	Socket, 3/8" DR 7/16" 12 PT	
J5216-TT	Socket, 3/8" DR 1/2" 12 PT	
J5218-TT	Socket, 3/8" DR 9/16" 12 PT	
J5220-TT	Socket, 3/8" DR 5/8" 12 PT	
J5222-TT	Socket, 3/8" DR 11/16" 12 PT	
J5224-TT	Socket, 3/8" DR 3/4" 12 PT	
J5226-TT	Socket, 3/8" DR 13/16" 12 PT	
J5228-TT	Socket, 3/8" DR 7/8" 12 PT	
J5230-TT	Socket, 3/8" DR 15/16" 12 PT	
J5232-TT	Socket, 3/8" DR 1" 12 PT	
J2586	Socket, Bar 13"	
J2591	Socket, Clip 3/8" DR	

Weight (lbs): 1.96

AS954E S3.8.1 ASME B107.1



3/8" DRIVE 13 PIECE DEEP SOCKET SET - 12 POINT

Product #: J52112-TT

Contents	Description	INCH
J5008-TT	Socket, 3/8" DR 1/4" 12 PT Deep	
J5010-TT	Socket, 3/8" DR 5/16" 12 PT Deep	
J5012-TT	Socket, 3/8" DR 3/8" 12 PT Deep	
J5014-TT	Socket, 3/8" DR 7/16" 12 PT Deep	
J5016-TT	Socket, 3/8" DR 1/2" 12 PT Deep	
J5018-TT	Socket, 3/8" DR 9/16" 12 PT Deep	
J5020-TT	Socket, 3/8" DR 5/8" 12 PT Deep	
J5022-TT	Socket, 3/8" DR 11/16" 12 PT Deep	
J5024-TT	Socket, 3/8" DR 3/4" 12 PT Deep	
J5026-TT	Socket, 3/8" DR 13/16" 12 PT Deep	
J5028-TT	Socket, 3/8" DR 7/8" 12 PT Deep	
J5030-TT	Socket, 3/8" DR 15/16" 12 PT Deep	
J5032-TT	Socket, 3/8" DR 1" 12 PT Deep	
J2586	Socket, Bar 13"	
J2591	Socket, Clip 3/8" DR	

Weight (lbs): 3.64

AS954E S3.8.1 ASME B107.1

- 12 Point Deep: 1/4, 5/16, 3/8, 7/16, 1/2, 9/16, 5/8, 11/16, 3/4, 13/16, 7/8, 15/16, 1".
- Accessories: 13-inch Socket Bar with 13 Socket Clips.



3/8" & 1/2" DRIVE 10 PIECE HEX BIT SET

Product #: J4900A-TT

Contents	Description	INCH
J49901/8-TT	Socket, Hex Bit 3/8" DR 1/8"	
J49905/32-TT	Socket, Hex Bit 3/8" DR 5/32"	
J49903/16-TT	Socket, Hex Bit 3/8" DR 3/16"	
J49907/32-TT	Socket, Hex Bit 3/8" DR 7/32"	
J49901/4-TT	Socket, Hex Bit 3/8" DR 1/4"	
J49905/16-TT	Socket, Hex Bit 3/8" DR 5/16"	
J49903/8-TT	Socket, Hex Bit 3/8" DR 3/8"	
J54411/2-TT	Socket, Hex Bit 1/2" DR 1/2"	
J54419/16-TT	Socket, Hex Bit 1/2" DR 9/16"	
J54415/8-TT	Socket, Hex Bit 1/2" DR 5/8"	
J4968PB	Blow-Molded Case	

Weight (lbs): 3.15

Individual components available for purchase.

- 3/8-inch Drive: 1/8, 5/32, 3/16, 7/32, 1/4, 5/16, 3/8".
- 1/2-inch Drive: 1/2, 9/16, 5/8".



3/8" & 1/2" DRIVE 10 PIECE METRIC HEX BIT SET

Product #: J4900MA-TT

Contents	Description	MM
J4990-4M-TT	Socket, Hex Bit 3/8" DR 4 mm	
J4990-5M-TT	Socket, Hex Bit 3/8" DR 5 mm	
J4990-6M-TT	Socket, Hex Bit 3/8" DR 6 mm	
J4990-7M-TT	Socket, Hex Bit 3/8" DR 7 mm	
J4990-8M-TT	Socket, Hex Bit 3/8" DR 8 mm	
J4990-9M-TT	Socket, Hex Bit 3/8" DR 9 mm	
J4990-10M-TT	Socket, Hex Bit 3/8" DR 10 mm	
J5441-12M-TT	Socket, Hex Bit 1/2" DR 12 mm	
J5441-14M-TT	Socket, Hex Bit 1/2" DR 14 mm	
J5441-17M-TT	Socket, Hex Bit 1/2" DR 17 mm	
J4968PB	Blow-Molded Case	

Weight (lbs): 3.11

Individual components available for purchase.

- 3/8-inch Drive: 4, 5, 6, 7, 8, 9, 10 mm.
- 1/2-inch Drive: 12, 14, 17 mm.

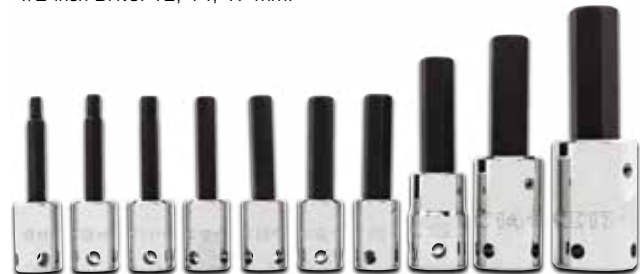

3/8" DRIVE SOCKETS - 12 POINT

- ▶ Proto® 12 Point Sockets are ideal for use on stubborn or damaged fasteners, as well as on fasteners made from soft materials.
- ▶ TorquePlus™ features apply.

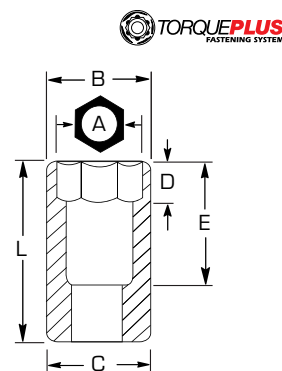

12	INCH (A)	Nut End Outside Dia. (in) (B)	Drive End Outside Dia. (in) (C)	Nut Depth (in) (D)	Bolt Clearance Depth (in) (E)	Overall Length (in) (L)	Weight (lbs)
J5208-TT	1/4	25/64	43/64	23/64	21/32	1-3/32	0.05
J5210-TT	5/16	15/32	43/64	23/64	21/32	1-3/32	0.05
J5212-TT	3/8	35/64	43/64	23/64	21/32	1-3/32	0.06
J5214-TT	7/16	41/64	43/64	23/64	21/32	1-3/32	0.06
J5216-TT	1/2	47/64	47/64	23/64	21/64	1-1/8	0.08
J5218-TT	9/16	13/16	13/16	1/2	11/16	1-1/8	0.09
J5220-TT	5/8	7/8	7/8	33/64	11/16	1-1/8	0.10
J5222-TT	11/16	61/64	61/64	17/32	11/16	1-1/8	0.13
J5224-TT	3/4	1-1/32	1-1/32	39/64	3/4	1-3/16	0.15
J5226-TT	13/16	1-3/32	1-3/32	39/64	3/4	1-3/16	0.17
J5228-TT	7/8	1-3/16	1-3/16	41/64	7/8	1-5/16	0.24
J5230-TT	15/16	1-1/4	1-1/4	49/64	7/8	1-5/16	0.25
J5232-TT	1	1-5/16	1-5/16	13/16	59/64	1-3/8	0.27

AS954E S3.8.1 ASME B107.1

12	MM (A)	Nut End Outside Dia. (in) (B)	Drive End Outside Dia. (in) (C)	Nut Depth (in) (D)	Bolt Clearance Depth (in) (E)	Overall Length (in) (L)	Weight (lbs)
J5206M-TT	6	25/64	43/64	1/4	45/64	1-3/32	0.05
J5207M-TT	7	27/64	43/64	1/4	45/64	1-3/32	0.05
J5208M-TT	8	15/32	43/64	1/4	45/64	1-3/32	0.06
J5209M-TT	9	33/64	43/64	9/32	45/64	1-3/32	0.05
J5210M-TT	10	19/32	43/64	5/16	45/64	1-3/32	0.06
J5211M-TT	11	41/64	43/64	21/64	45/64	1-3/32	0.07
J5212M-TT	12	45/64	45/64	9/32	1/2	1-1/8	0.05
J5213M-TT	13	47/64	47/64	9/32	1/2	1-1/8	0.07
J5214M-TT	14	25/32	25/32	15/32	7/16	1-1/8	0.08
J5215M-TT	15	27/32	27/32	17/32	7/16	1-1/8	0.10
J5216M-TT	16	55/64	55/64	17/32	7/16	1-1/8	0.10
J5217M-TT	17	15/16	15/16	17/32	7/16	1-1/8	0.12
J5218M-TT	18	61/64	61/64	17/32	1/2	1-3/16	0.12
J5219M-TT	19	1	1	17/32	1/2	1-3/16	0.14
J5220M-TT	20	1-3/32	1-3/32	5/8	1/2	1-3/16	0.17
J5221M-TT	21	1-3/32	1-3/32	9/16	41/64	1-9/32	0.18
J5222M-TT	22	1-11/64	1-11/64	43/64	5/8	1-5/16	0.22
J5223M-TT	23	1-3/16	1-3/16	47/64	5/8	1-5/16	0.21
J5224M-TT	24	1-1/4	1-1/4	49/64	37/64	1-5/16	0.23
J5225M-TT	25	1-21/64	1-21/64	49/64	5/8	1-3/8	0.29
J5226M-TT	26	1-21/64	1-21/64	49/64	59/64	1-3/8	0.26

AS954E S3.8.1 ASME B107.5M



3/8" DRIVE DEEP SOCKETS - 12 POINT

- ▶ Proto® 12 Point Sockets are ideal for use on stubborn or damaged fasteners, as well as on fasteners made from soft materials.
- ▶ TorquePlus™ features apply.

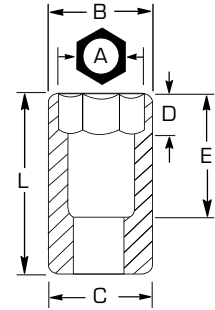

3/8" DRIVE TETHER-READY SOCKETS

12	INCH (A)	Nut End Outside Dia. (in) (B)	Drive End Outside Dia. (in) (C)	Nut Depth (in) (D)	Bolt Clearance Depth (in) (E)	Overall Length (in) (L)	Weight (lbs)
J5008-TT	1/4	13/32	21/32	5/16	1-11/16	2-1/8	0.10
J5010-TT	5/16	15/32	21/32	13/32	1-11/16	2-1/8	0.10
J5012-TT	3/8	35/64	21/32	13/32	1-11/16	2-1/8	0.10
J5014-TT	7/16	21/32	21/32	7/16	1-11/16	2-1/8	0.12
J5016-TT	1/2	23/32	23/32	33/64	1-11/16	2-1/8	0.14
J5018-TT	9/16	51/64	51/64	19/32	1-11/16	2-1/8	0.18
J5020-TT	5/8	7/8	7/8	43/64	2-5/16	2-3/4	0.24
J5022-TT	11/16	15/16	15/16	43/64	2-5/16	2-3/4	0.30
J5024-TT	3/4	1-1/64	1-1/64	43/64	2-5/16	2-3/4	0.33
J5026-TT	13/16	1-5/64	1-5/64	43/64	2-5/16	2-3/4	0.36
J5028-TT	7/8	1-15/64	1-15/64	1-3/16	2-5/16	2-3/4	0.43
J5030-TT	15/16	1-15/64	1-15/64	1-3/16	2-5/16	2-3/4	0.46
J5032-TT	1	1-5/16	1-5/16	1-3/16	2-5/16	2-3/4	0.54

AS954E S3.8.1 ASME B107.1

12	MM (A)	Nut End Outside Dia. (in) (B)	Drive End Outside Dia. (in) (C)	Nut Depth (in) (D)	Bolt Clearance Depth (in) (E)	Overall Length (in) (L)	Weight (lbs)
J5006M-TT	6	25/64	21/32	5/16	1-13/16	2-1/8	0.11
J5007M-TT	7	25/64	21/32	25/64	1-47/64	2-1/8	0.09
J5008M-TT	8	15/32	21/32	25/64	1-47/64	2-1/8	0.10
J5009M-TT	9	33/64	21/32	25/64	1-47/64	2-1/8	0.11
J5010M-TT	10	37/64	21/32	25/64	1-47/64	2-1/8	0.12
J5011M-TT	11	21/32	7/16	1-11/16	1-47/64	2-1/8	0.13
J5012M-TT	12	45/64	45/64	33/64	1-39/64	2-1/8	0.13
J5013M-TT	13	23/32	23/32	33/64	1-39/64	2-1/8	0.13
J5014M-TT	14	25/32	25/32	19/32	1-17/32	2-1/8	0.15
J5015M-TT	15	55/64	55/64	21/32	2-7/64	2-3/4	0.15
J5016M-TT	16	55/64	55/64	21/32	2-7/64	2-3/4	0.24
J5017M-TT	17	15/16	15/16	21/32	2-7/64	2-3/4	0.27
J5018M-TT	18	15/16	15/16	21/32	2-7/64	2-3/4	0.28
J5019M-TT	19	1-1/64	1-1/64	11/16	2-1/16	2-3/4	0.30
J5020M-TT	20	1-5/64	1-5/64	11/16	2-1/16	2-3/4	0.33
J5021M-TT	21	1-5/64	1-5/64	11/16	2-1/16	2-3/4	0.34
J5022M-TT	22	1-11/64	1-11/64	11/16	2-1/16	2-3/4	0.45
J5023M-TT	23	1-7/32	1-11/64	1-3/16	1-37/64	2-3/4	0.54

AS954E S3.8.1 ASME B107.5M



3/8" DRIVE HEX BIT SOCKETS

- › Manufactured with four detent holes so that the pin detent will engage correctly regardless of the direction the socket is placed on the square drive.
- › The positive control system requires a separate tool to attach or remove the socket, meaning it cannot be removed without specific intent.
- › Chrome finish is applied after the holes are bored for better corrosion resistance.
- › Made using a heat treated alloy for wear-resistance which helps minimize distortion for a long life.
- › Hex opening holds the bit allowing the bit holder to take the torque load.



HEX	INCH	Bit Length (in)	Overall Length (in)	Weight (lbs)
J49901/8-TT	1/8	1-5/8	2-23/32	0.12
J49905/32-TT	5/32	1-5/8	2-23/32	0.12
J49903/16-TT	3/16	1-5/8	2-23/32	0.12
J49907/32-TT	7/32	1-5/8	2-23/32	0.12
J49901/4-TT	1/4	1-5/8	2-23/32	0.12
J49905/16-TT	5/16	1-5/8	2-23/32	0.13
J49903/8-TT	3/8	1-5/8	2-23/32	0.15

HEX	MM	Bit Length (in)	Overall Length (in)	Weight (lbs)
J4990-4M-TT	4	1-5/8	2-23/32	0.12
J4990-5M-TT	5	1-5/8	2-23/32	0.12
J4990-6M-TT	6	1-5/8	2-23/32	0.12
J4990-7M-TT	7	1-5/8	2-23/32	0.12
J4990-8M-TT	8	1-5/8	2-23/32	0.13
J4990-9M-TT	9	1-5/8	2-23/32	0.15
J4990-10M-TT	10	1-5/8	2-23/32	0.16

1/2" DRIVE 24 PIECE METRIC SOCKET SET - 12 POINT

Product #: J54211-TT

- › 12 Point Standard: 10, 11, 12, 13, 14, 15, 16, 17, 18, 19, 20, 21, 22, 23, 24, 25, 26, 27, 28, 29, 30, 31, 32, 36 mm.
- › Accessories: (2) 17-inch Socket Bars with 24 Socket Clips.



Contents	Description	MM
J5410M-TT	Socket, 1/2" DR 10 mm 12 PT	
J5411M-TT	Socket, 1/2" DR 11 mm 12 PT	
J5412M-TT	Socket, 1/2" DR 12 mm 12 PT	
J5413M-TT	Socket, 1/2" DR 13 mm 12 PT	
J5414M-TT	Socket, 1/2" DR 14 mm 12 PT	
J5415M-TT	Socket, 1/2" DR 15 mm 12 PT	
J5416M-TT	Socket, 1/2" DR 16 mm 12 PT	
J5417M-TT	Socket, 1/2" DR 17 mm 12 PT	
J5418M-TT	Socket, 1/2" DR 18 mm 12 PT	
J5419M-TT	Socket, 1/2" DR 19 mm 12 PT	
J5420M-TT	Socket, 1/2" DR 20 mm 12 PT	
J5421M-TT	Socket, 1/2" DR 21 mm 12 PT	
J5422M-TT	Socket, 1/2" DR 22 mm 12 PT	
J5423M-TT	Socket, 1/2" DR 23 mm 12 PT	
J5424M-TT	Socket, 1/2" DR 24 mm 12 PT	
J5425M-TT	Socket, 1/2" DR 25 mm 12 PT	
J5426M-TT	Socket, 1/2" DR 26 mm 12 PT	
J5427M-TT	Socket, 1/2" DR 27 mm 12 PT	
J5428M-TT	Socket, 1/2" DR 28 mm 12 PT	
J5429M-TT	Socket, 1/2" DR 29 mm 12 PT	
J5430M-TT	Socket, 1/2" DR 30 mm 12 PT	
J5431M-TT	Socket, 1/2" DR 31 mm 12 PT	
J5432M-TT	Socket, 1/2" DR 32 mm 12 PT	
J5436M-TT	Socket, 1/2" DR 36 mm 12 PT	
J2586	Socket, Bar 13"	
J2587	Socket, Bar 17"	
J2592	Socket, Clip 1/2" DR	

Weight (lbs): 7.69

AS954E S3.8.1 ASME B107.5M



1/2" DRIVE 23 PIECE METRIC DEEP SOCKET SET - 12 POINT



Product #: J54201-TT

- ▶ 12 Point Deep: 10, 11, 12, 13, 14, 15, 16, 17, 18, 19, 20, 21, 22, 23, 24, 25, 26, 27, 28, 29, 30, 31, 32 mm.
- ▶ Accessories: (2) 17-inch Socket Bars with 23 Socket Clips.
- ▶ TorquePlus™ features apply.

Contents	Description	MM
J5310M-TT	Socket, 1/2" DR 10 mm 12 PT	
J5311M-TT	Socket, 1/2" DR 11 mm 12 PT	
J5312M-TT	Socket, 1/2" DR 12 mm 12 PT	
J5313M-TT	Socket, 1/2" DR 13 mm 12 PT	
J5314M-TT	Socket, 1/2" DR 14 mm 12 PT	
J5315M-TT	Socket, 1/2" DR 15 mm 12 PT	
J5316M-TT	Socket, 1/2" DR 16 mm 12 PT	
J5317M-TT	Socket, 1/2" DR 17 mm 12 PT	
J5318M-TT	Socket, 1/2" DR 18 mm 12 PT	
J5319M-TT	Socket, 1/2" DR 19 mm 12 PT	
J5320M-TT	Socket, 1/2" DR 20 mm 12 PT	
J5321M-TT	Socket, 1/2" DR 21 mm 12 PT	
J5322M-TT	Socket, 1/2" DR 22 mm 12 PT	
J5323M-TT	Socket, 1/2" DR 23 mm 12 PT	
J5324M-TT	Socket, 1/2" DR 24 mm 12 PT	
J5325M-TT	Socket, 1/2" DR 25 mm 12 PT	
J5326M-TT	Socket, 1/2" DR 26 mm 12 PT	
J5327M-TT	Socket, 1/2" DR 27 mm 12 PT	
J5328M-TT	Socket, 1/2" DR 28 mm 12 PT	
J5329M-TT	Socket, 1/2" DR 29 mm 12 PT	
J5330M-TT	Socket, 1/2" DR 30 mm 12 PT	
J5331M-TT	Socket, 1/2" DR 31 mm 12 PT	
J5332M-TT	Socket, 1/2" DR 32 mm 12 PT	

Weight (lbs): 8.95

ASME B107.110-2012



1/2" DRIVE TETHER-READY SOCKET SETS

1/2" DRIVE 19 PIECE SOCKET SET - 12 POINT

Product #: J54113-TT

- ▶ 12 Point Standard: 3/8, 7/16, 1/2, 9/16, 5/8, 11/16, 3/4, 13/16, 7/8, 15/16, 1, 1-1/16, 1-1/8, 1-3/16, 1-1/4, 1-5/16, 1-3/8, 1-7/16, 1-1/2".
- ▶ Accessories: 17-inch Socket Bar with 19 Socket Clips.



Contents	Description	INCH
J5412-TT	Socket, 1/2" DR 3/8" 12 PT	
J5414-TT	Socket, 1/2" DR 7/16" 12 PT	
J5416-TT	Socket, 1/2" DR 1/2" 12 PT	
J5418-TT	Socket, 1/2" DR 9/16" 12 PT	
J5420-TT	Socket, 1/2" DR 5/8" 12 PT	
J5422-TT	Socket, 1/2" DR 11/16" 12 PT	
J5424-TT	Socket, 1/2" DR 3/4" 12 PT	
J5426-TT	Socket, 1/2" DR 13/16" 12 PT	
J5428-TT	Socket, 1/2" DR 7/8" 12 PT	
J5430-TT	Socket, 1/2" DR 15/16" 12 PT	
J5432-TT	Socket, 1/2" DR 1" 12 PT	
J5434-TT	Socket, 1/2" DR 1-1/16" 12 PT	
J5436-TT	Socket, 1/2" DR 1-1/8" 12 PT	
J5438-TT	Socket, 1/2" DR 1-3/16" 12 PT	
J5440-TT	Socket, 1/2" DR 1-1/4" 12 PT	
J5442-TT	Socket, 1/2" DR 1-5/16" 12 PT	
J5444-TT	Socket, 1/2" DR 1-3/8" 12 PT	
J5446-TT	Socket, 1/2" DR 1-7/16" 12 PT	
J5448-TT	Socket, 1/2" DR 1-1/2" 12 PT	
J2587	Socket, Bar 17"	
J2592	Socket, Clip 1/2" DR	

Weight (lbs): 7.25

AS954E S3.8.1 ASME B107.1

1/2" DRIVE 19 PIECE DEEP SOCKET SET - 12 POINT

Product #: J54105-TT

- ▶ 12 Point Deep: 3/8, 7/16, 1/2, 9/16, 5/8, 11/16, 3/4, 13/16, 7/8, 15/16, 1, 1-1/16, 1-1/8, 1-3/16, 1-1/4, 1-5/16, 1-3/8, 1-7/16, 1-1/2".
- ▶ Accessories: 17-inch Socket Bar with 19 Socket Clips.



Contents	Description	INCH
J5312-TT	Socket, 1/2" DR 3/8" 12 PT Deep	
J5314-TT	Socket, 1/2" DR 7/16" 12 PT Deep	
J5316-TT	Socket, 1/2" DR 1/2" 12 PT Deep	
J5318-TT	Socket, 1/2" DR 9/16" 12 PT Deep	
J5320-TT	Socket, 1/2" DR 5/8" 12 PT Deep	
J5322-TT	Socket, 1/2" DR 11/16" 12 PT Deep	
J5324-TT	Socket, 1/2" DR 3/4" 12 PT Deep	
J5326-TT	Socket, 1/2" DR 13/16" 12 PT Deep	
J5328-TT	Socket, 1/2" DR 7/8" 12 PT Deep	
J5330-TT	Socket, 1/2" DR 15/16" 12 PT Deep	
J5332-TT	Socket, 1/2" DR 1" 12 PT Deep	
J5334-TT	Socket, 1/2" DR 1-1/16" 12 PT Deep	
J5336-TT	Socket, 1/2" DR 1-1/8" 12 PT Deep	
J5338-TT	Socket, 1/2" DR 1-3/16" 12 PT Deep	
J5340-TT	Socket, 1/2" DR 1-1/4" 12 PT Deep	
J5342-TT	Socket, 1/2" DR 1-5/16" 12 PT Deep	
J5344-TT	Socket, 1/2" DR 1-3/8" 12 PT Deep	
J5346-TT	Socket, 1/2" DR 1-7/16" 12 PT Deep	
J5348-TT	Socket, 1/2" DR 1-1/2" 12 PT Deep	
J2587	Socket, Bar 17"	
J2592	Socket, Clip 1/2" DR	

Weight (lbs): 14.00

AS954E S3.8.1 ASME B107.1



1/2" DRIVE SOCKETS - 12 POINT

- Proto® 12 Point Sockets are ideal for use on stubborn or damaged fasteners, as well as on fasteners made from soft materials.

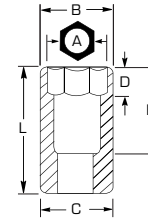

1/2" DRIVE TETHER-READY SOCKETS

12	INCH (A)	Nut End Outside Dia. (in) (B)	Drive End Outside Dia. (in) (C)	Nut Depth (in) (D)	Bolt Clearance Depth (in) (E)	Overall Length (in) (L)	Weight (lbs)
J5412-TT	3/8	9/16	55/64	23/64	7/8	1-31/64	0.11
J5414-TT	7/16	43/64	55/64	23/64	7/8	1-31/64	0.11
J5416-TT	1/2	47/64	55/64	23/64	7/8	1-31/64	0.11
J5418-TT	9/16	13/16	55/64	23/64	51/64	1-1/2	0.13
J5420-TT	5/8	7/8	7/8	9/16	21/32	1-1/2	0.14
J5422-TT	11/16	61/64	61/64	9/16	21/32	1-1/2	0.15
J5424-TT	3/4	1-1/32	1-1/64	11/16	21/32	1-1/2	0.15
J5426-TT	13/16	1-3/32	1-5/64	11/16	21/32	1-1/2	0.23
J5428-TT	7/8	1-11/64	1-3/16	11/16	45/64	1-9/16	0.26
J5430-TT	15/16	1-1/4	1-1/4	13/16	45/64	1-9/16	0.33
J5432-TT	1	1-21/64	1-5/16	27/32	45/64	1-9/16	0.38
J5434-TT	1-1/16	1-13/32	1-25/64	13/16	25/32	1-5/8	0.42
J5436-TT	1-1/8	1-31/64	1-31/64	15/16	29/32	1-3/4	0.47
J5438-TT	1-3/16	1-9/16	1-17/32	59/64	29/32	1-3/4	0.59
J5440-TT	1-1/4	1-39/64	1-37/64	1	7/8	1-3/4	0.66
J5442-TT	1-5/16	1-21/32	1-41/64	27/32	1-19/64	1-55/64	0.69
J5444-TT	1-3/8	1-25/32	1-5/8	25/32	1-19/64	2	0.79
J5446-TT	1-7/16	1-59/64	1-5/8	27/32	1-19/64	2-1/8	0.98
J5448-TT	1-1/2	1-63/64	1-5/8	27/32	1-19/64	2-1/4	1.12

AS954E S3.8.1 ASME B107.1

12	MM (A)	Nut End Outside Dia. (in) (B)	Drive End Outside Dia. (in) (C)	Nut Depth (in) (D)	Bolt Clearance Depth (in) (E)	Overall Length (in) (L)	Weight (lbs)
J5410M-TT	10	39/64	55/64	23/64	55/64	1-31/64	0.11
J5411M-TT	11	45/64	55/64	23/64	55/64	1-31/64	0.11
J5412M-TT	12	47/64	55/64	23/64	55/64	1-31/64	0.11
J5413M-TT	13	3/4	55/64	23/64	55/64	1-31/64	0.12
J5414M-TT	14	13/16	55/64	23/64	7/8	1-1/2	0.13
J5415M-TT	15	55/64	55/64	37/64	7/8	1-1/2	0.13
J5416M-TT	16	7/8	7/8	37/64	7/8	1-1/2	0.13
J5417M-TT	17	61/64	61/64	37/64	7/8	1-1/2	0.14
J5418M-TT	18	61/64	61/64	37/64	7/8	1-1/2	0.17
J5419M-TT	19	1-1/32	1-1/32	11/16	27/32	1-1/2	0.19
J5420M-TT	20	1-3/32	1-3/32	11/16	27/32	1-1/2	0.22
J5421M-TT	21	1-3/32	1-3/32	11/16	27/32	1-1/2	0.24
J5422M-TT	22	1-11/64	1-11/64	11/16	27/32	1-17/32	0.26
J5423M-TT	23	1-13/64	1-13/64	25/32	59/64	1-17/32	0.27
J5424M-TT	24	1-1/4	1-1/4	53/64	59/64	1-17/32	0.28
J5425M-TT	25	1-9/32	1-9/32	53/64	59/64	1-17/32	0.30
J5426M-TT	26	1-21/64	1-21/64	55/64	63/64	1-39/64	0.33
J5427M-TT	27	1-13/32	1-13/32	15/16	1-3/64	1-43/64	0.39
J5428M-TT	28	1-31/64	1-31/64	63/64	1-5/32	1-25/32	0.48
J5429M-TT	29	1-31/64	1-31/64	63/64	1-5/32	1-25/32	0.62
J5430M-TT	30	1-9/16	1-17/32	63/64	1-5/32	1-25/32	0.63
J5431M-TT	31	1-39/64	1-39/64	1-1/16	1-5/32	1-25/32	0.63
J5432M-TT	32	1-39/64	1-39/64	1-1/8	1-7/32	1-27/32	0.63
J5436M-TT	36	1-31/32	1-31/32	1-3/8	1-39/64	2-15/64	1.04

AS954E S3.8.1 ASME B107.5M

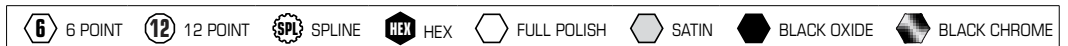

1/2" DRIVE DEEP SOCKETS - 12 POINT

- Proto® 12 Point Sockets are ideal for use on stubborn or damaged fasteners, as well as on fasteners made from soft materials.

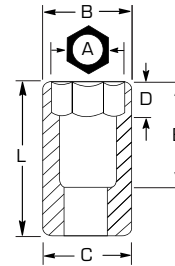

12	INCH (A)	Nut End Outside Dia. (in) (B)	Drive End Outside Dia. (in) (C)	Nut Depth (in) (D)	Bolt Clearance Depth (in) (E)	Overall Length (in) (L)	Weight (lbs)
J5312-TT	3/8	9/16	7/8	1/4	2-39/64	3-1/4	0.28
J5314-TT	7/16	9/16	7/8	23/64	2-39/64	3-1/4	0.28
J5316-TT	1/2	47/64	55/64	25/32	2-39/64	3-1/4	0.29
J5318-TT	9/16	13/16	27/32	15/16	2-39/64	3-1/4	0.29
J5320-TT	5/8	7/8	7/8	1-7/32	2-39/64	3-1/4	0.30
J5322-TT	11/16	31/32	31/32	1-7/32	2-39/64	3-1/4	0.42
J5324-TT	3/4	1-3/64	1-3/64	1-7/32	2-39/64	3-1/4	0.42
J5326-TT	13/16	1-3/32	1-3/32	1-7/32	2-39/64	3-1/4	0.52
J5328-TT	7/8	1-11/64	1-11/64	1-7/32	2-39/64	3-1/4	0.58
J5330-TT	15/16	1-1/4	1-1/4	1-7/32	2-39/64	3-1/4	0.67
J5332-TT	1	1-21/64	1-21/64	1-7/32	2-29/64	3-1/4	0.67
J5334-TT	1-1/16	1-13/32	1-13/32	1-9/32	2-29/64	3-1/4	0.75
J5336-TT	1-1/8	1-1/2	1-1/2	1-5/32	2-29/64	3-1/4	0.83
J5340-TT	1-1/4	1-9/16	1-9/16	1-13/32	2-29/64	3-1/4	1.06
J5338-TT	1-3/16	1-35/64	1-35/64	1-7/64	2-1/4	3-1/4	0.83
J5342-TT	1-5/16	1-7/8	1-5/8	27/32	2-1/4	3-1/2	1.06
J5344-TT	1-3/8	1-7/8	1-5/8	61/64	2-1/4	3-1/2	1.23
J5346-TT	1-7/16	2-1/16	1-5/8	61/64	2-1/4	3-1/2	1.27
J5348-TT	1-1/2	2-1/16	1-5/8	1	2-1/4	3-1/2	1.58

AS954E S3.8.1 ASME B107.1

12	MM (A)	Nut End Outside Dia. (in) (B)	Drive End Outside Dia. (in) (C)	Nut Depth (in) (D)	Bolt Clearance Depth (in) (E)	Overall Length (in) (L)	Weight (lbs)
J5310M-TT	10	39/64	55/64	19/32	2-3/32	3-1/4	0.25
J5311M-TT	11	45/64	55/64	5/8	2-3/32	3-1/4	0.25
J5312M-TT	12	47/64	55/64	43/64	2-3/32	3-1/4	0.26
J5313M-TT	13	3/4	55/64	43/64	2-3/32	3-1/4	0.26
J5314M-TT	14	27/32	27/32	15/16	2-3/32	3-1/4	0.30
J5315M-TT	15	55/64	55/64	1-1/16	2-3/32	3-1/4	0.32
J5316M-TT	16	55/64	55/64	1-3/16	2-3/32	3-1/4	0.32
J5317M-TT	17	61/64	61/64	1-3/16	2-3/32	3-1/4	0.33
J5318M-TT	18	63/64	63/64	1-3/16	2-3/32	3-1/4	0.33
J5319M-TT	19	1-3/64	1-3/64	1-3/16	2-3/32	3-1/4	0.37
J5320M-TT	20	1-3/32	1-3/32	1-3/16	2-3/32	3-1/4	0.46
J5321M-TT	21	1-3/32	1-3/32	1-3/16	2-3/32	3-1/4	0.51
J5322M-TT	22	1-11/64	1-11/64	1-3/16	2-3/32	3-1/4	0.51
J5323M-TT	23	1-13/64	1-13/64	1-3/16	2-3/32	3-1/4	0.51
J5324M-TT	24	1-1/4	1-1/4	1-3/16	2-3/32	3-1/4	0.51
J5325M-TT	25	1-5/16	1-5/16	1-3/16	2-3/32	3-1/4	0.62
J5326M-TT	26	1-21/64	1-21/64	1-3/16	2-3/32	3-1/4	0.63
J5327M-TT	27	1-1/64	1-1/64	1-7/64	2-3/32	3-1/4	0.65
J5328M-TT	28	1-3/32	1-31/64	1-7/64	2-3/32	3-1/4	0.68
J5329M-TT	29	1-31/64	1-31/64	1-7/64	2-3/32	3-1/4	0.68
J5330M-TT	30	1-9/16	1-9/16	1-7/64	2-5/8	3-1/4	0.70
J5331M-TT	31	1-39/64	1-39/64	1-7/64	2-5/8	3-1/4	0.73
J5332M-TT	32	1-39/64	1-39/64	1-7/64	2-5/8	3-1/4	0.73

ASME B107.110-2012



1/2" DRIVE HEX BIT SOCKETS



- › Manufactured with four detent holes so that the pin detent will engage correctly regardless of the direction the socket is placed on the square drive.
- › The positive control system requires a separate tool to attach or remove the socket, meaning it cannot be removed without specific intent.
- › Chrome finish is applied after the holes are bored for better corrosion resistance.
- › Made using a heat treated alloy for wear-resistance which helps minimize distortion for a long life.
- › Hex opening holds the bit allowing the bit holder to take the torque load.



HEX	INCH	Bit Length (in)	Overall Length (in)	Weight (lbs)
J54411/4-TT	1/4	1-3/4	3-1/4	0.19
J54415/16-TT	5/16	1-3/4	3-1/4	0.22
J54413/8-TT	3/8	1-3/4	3-1/4	0.25
J54417/16-TT	7/16	1-3/4	3-1/4	0.28
J54411/2-TT	1/2	1-7/8	3-5/8	0.46
J54419/16-TT	9/16	1-7/8	3-5/8	0.50
J54415/8-TT	5/8	2	4	0.85

HEX	MM	Bit Length (in)	Overall Length (in)	Weight (lbs)
J5441-6M-TT	6	1-3/4	3-1/4	0.20
J5441-8M-TT	8	1-3/4	3-1/4	0.22
J5441-10M-TT	10	1-3/4	3-1/4	0.26
J5441-12M-TT	12	1-3/4	3-1/4	0.29
J5441-13M-TT	13	1-7/8	3-41/64	0.46
J5441-14M-TT	14	1-7/8	3-41/64	0.50
J5441-15M-TT	15	1-7/8	3-41/64	0.50
J5441-17M-TT	17	2	4	0.87
J5441-18M-TT	18	2	4	0.90
J5441-19M-TT	19	2	4	0.94

EXTENSIONS

- › Made from alloy steel.
- › Heat treated for strength and durability.

Product #	Drive Size (in)	Overall Length (in)	Weight (lbs)
J5260-TT	3/8	3	0.16
J5262-TT	3/8	12	0.61
J5460-TT	1/2	2-1/2	0.24
J5461-TT	1/2	5	0.44
J5463-TT	1/2	10	0.89

ASME B107.10M



ADAPTERS



Product #	Input Drive (in)	Output Drive (in)	Overall Length (in)	Weight (lbs)
J5253-TT	3/8	1/2	1-7/16	0.11
J5254-TT	1/2	3/8	1-3/8	0.13

ASME B107.10M

UNIVERSAL JOINTS



Product #	Input Drive (in)	Output Drive (in)	Overall Length (in)	Weight (lbs)
J5270A-TT	3/8	1/2	1-7/16	0.11
J5470A-TT	1/2	3/8	1-3/8	0.13

ASME B107.10M

6	6 POINT	12	12 POINT	SPL	SPLINE	HEX	HEX	FULL POLISH	SATIN	BLACK OXIDE	BLACK CHROME
---	---------	----	----------	-----	--------	-----	-----	-------------	-------	-------------	--------------

1/2" DRIVE SCAFFOLDING RATCHET

- › The scaffold ratchet is designed for working with scaffolding and other construction applications.
- › Socket retained with through hole and pin for safety.
- › Hammer tip reduces vibration and protects fasteners against distortion.
- › Hole in ratchet handle to be used with tether strap.



Product #	Drive Size (in)	Finish	Style	Overall Length (in)	Weight (lbs)
J5449SC	1/2	Full Polish	Scaffolding	10	2.01

3/8" & 1/2" DRIVE PREMIUM PEAR HEAD RATCHETS

- › Small pear head design for access in tight, hard to reach work areas.
- › 45-Tooth gear provides balance between 8° articulation angle and high torque carrying capacity.
- › Sealed design helps prevent debris from entering the ratchet mechanism reducing wear. Also, helps to keep lubrication contained within the components. Patent pending design.
- › Low profile reversing lever design for quick, one-hand operation.
- › Contoured, ergonomically-designed handle for comfort. Knurled bands allow for increased grip and slip resistance.
- › Double nickel chrome plated for enhanced corrosion protection or black oxide finish.
- › Field repairable.
- › Locking pin detent to retain socket during use.



Lanyard ready through-hole built directly into the handle.

Product #	Drive Size (in)	Finish	Overall Length (in)	Weight (lbs)	Repair Kit
J5249XL-TT	3/8	Full Polish	8-1/2	0.86	J5249XLRK-TT
J5250XL-TT	3/8	Full Polish	11	1.03	J5249XLRK-TT
J5449XL-TT	1/2	Full Polish	10-1/2	1.72	J5449XLRK-TT
J5450XL-TT	1/2	Full Polish	15	2.18	J5449XLRK-TT

ASME B107.500



RATCHETING HEAD MICROMETER TORQUE WRENCHES

MEETS ASME STANDARD

- › Calibrated to +/- 4% clockwise direction and +/- 6% counter clockwise direction at 20% to 100% of full scale.
- › Calibration is accomplished by manually loading the torque wrenches.
- › Manufactured to meet standard industrial torque applications, general industry, heavy equipment, and maintenance.
- › Locking pin Detent to retain Socket during use.



TETHER-READY TORQUE WRENCHES

FT-LBS

Product #	Drive Size (in)	Torque Range (ft-lbs)	Increments (ft-lbs)	Head Width (in)	Head Depth (in)	Overall Length (in)	Weight (lbs)	Storage Case	Repair Kit
J6012C-TT	3/8	20-100	0.5	1-7/16	1-1/64	17	3.30	J6006PBF	J6006RK-TT
J6014C-TT	1/2	50-250	1	1-7/8	1-13/32	27-1/8	5.90	J6014PBF	J6014RK-TT

NOTE: For use with Elastic Bungee or Web Lanyard only.

ASME B107.14M

NM

Product #	Drive Size (in)	Torque Range (Nm)	Increments (Nm)	Head Width (in)	Head Depth (in)	Overall Length (in)	Weight (lbs)	Storage Case	Repair Kit
J6006NMC-TT	3/8	16-80	0.5	1-7/16	1-1/64	15-1/2	3.00	J6006PBF	J6006RK-TT
J6016NMC-TT	1/2	40-200	1	1-7/8	1-13/32	21-1/2	5.00	J6014PBF	J6014RK-TT

NOTE: For use with Elastic Bungee or Web Lanyard only.

ASME B107.14M



WRENCHES

Proto® Tethered Wrenches are specifically assembled with the correct Heat Shrink Loop, as appropriate, selected from seven different sizes, and fitted for the weight and diameter of the tool. Some wrenches (adjustable and pipe) don't require the heat shrink. The durable, light loop does not interfere with the function of the tool.





15 PIECE COMBINATION ASD WRENCH SET - 12 POINT



Product #: J1200FASD-TT

- › Satin finish provides corrosion resistance and a slip-resistant grip.
- › 12 Point box end allows for fine indexing, helping to improve speed and access. Fits 4, 6, and 12 Point fasteners.
- › Anti-Slip Design (ASD) open end. Fractional sizes 11/32" and smaller do not have the ASD feature.
- › Box ends incorporate the TorquePlus™ system.



12	INCH	Point Count	Overall Length (in)
J1210A-TT	5/16	12	5-3/8
J1212ASD-TT	3/8	12	6
J1214ASD-TT	7/16	12	7
J1216ASD-TT	1/2	12	8
J1218ASD-TT	9/16	12	8-7/8
J1220ASD-TT	5/8	12	9-1/2
J1222ASD-TT	11/16	12	10-1/4
J1224ASD-TT	3/4	12	11
J1226ASD-TT	13/16	12	11-7/8
J1228ASD-TT	7/8	12	12-1/2
J1230ASD-TT	15/16	12	13-1/4
J1232ASD-TT	1	12	14
J1234ASD-TT	1-1/16	12	15-1/4
J1236ASD-TT	1-1/8	12	15-7/8
J1240ASD-TT	1-1/4	12	16-7/8
J25TR34C	Tool Roll		

Weight (lbs): 9.75

ASME B107.100

15 PIECE METRIC COMBINATION ASD WRENCH SET - 12 POINT



Product #: J1200P-MASD-TT

- › Satin finish provides corrosion resistance and a slip-resistant grip.
- › 12 Point box end allows for fine indexing, helping to improve speed and access. Fits 4, 6, and 12 Point fasteners.
- › Anti-Slip Design (ASD) open end. Metric sizes 9 mm and smaller do not have ASD feature.
- › Box ends incorporate the TorquePlus™ system.



12	MM	Point Count	Overall Length (in)
J1207MA-TT	7	12	5-5/32
J1208MA-TT	8	12	5-13/32
J1210MASD-TT	10	12	5-29/32
J1212MASD-TT	12	12	7-45/64
J1214MASD-TT	14	12	8-13/16
J1216MASD-TT	16	12	9-35/64
J1218MASD-TT	18	12	10-11/16
J1220MASD-TT	20	12	11-27/64
J1222MASD-TT	22	12	12-17/32
J1224MASD-TT	24	12	13-5/16
J1226MASD-TT	26	12	14-41/64
J1228MASD-TT	28	12	15-35/64
J1229MASD-TT	29	12	15-55/64
J1230MASD-TT	30	12	15-55/64
J1232MASD-TT	32	12	16-59/64
J25TR41C	Tool Roll		

Weight (lbs): 4.25

ASME B107.100

SATIN COMBINATION WRENCHES - 12 POINT



- ▶ Satin finish provides corrosion resistance and a slip-resistant grip.
- ▶ 12 Point box end allows for fine indexing, helping to improve speed and access. Fits 4, 6, and 12 Point fasteners.
- ▶ Anti-Slip Design (ASD) open end.
- ▶ Fractional sizes 11/32" and smaller and sizes 1-5/16" and larger do not have the ASD feature.
- ▶ Box ends incorporate the TorquePlus™ system.

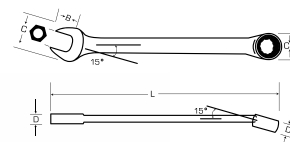

12	INCH	Throat Depth (in) (B)	Outside Head Width (in) (C)	Head Thickness (in) (D)	Outside Head Width (in) (C1)	Head Thickness (in) (D1)	Overall Length (in)	Weight (lbs)
J1210A-TT	5/16	3/8	45/64	3/16	33/64	17/64	5-3/8	0.08
J1212ASD-TT	3/8	13/32	13/16	3/16	39/64	5/16	6	0.11
J1214ASD-TT	7/16	17/32	15/16	15/64	43/64	21/64	7	0.14
J1216ASD-TT	1/2	39/64	1-5/16	1/4	49/64	11/32	8	0.18
J1218ASD-TT	9/16	11/16	1-3/16	9/32	3/4	23/64	8-7/8	0.21
J1220ASD-TT	5/8	3/4	1-21/64	19/64	15/16	13/32	9-1/2	0.29
J1222ASD-TT	11/16	13/16	1-29/64	5/16	1-1/64	7/16	10-1/4	0.35
J1224ASD-TT	3/4	57/64	1-37/64	11/32	1-3/32	15/32	11	0.41
J1226ASD-TT	13/16	31/32	1-11/16	23/64	1-11/64	1/2	11-7/8	0.54
J1228ASD-TT	7/8	1-1/16	1-13/16	3/8	1-1/4	33/64	12-1/2	0.65
J1230ASD-TT	15/16	1-1/8	1-29/32	13/32	1-27/64	37/64	13-1/4	0.74
J1232ASD-TT	1	1-13/64	2-1/64	13/32	1-13/32	37/64	14	0.95
J1234ASD-TT	1-1/16	1-9/32	2-9/64	29/64	1-31/64	39/64	15-1/4	1.13
J1236ASD-TT	1-1/8	1-23/64	2-17/64	15/32	1-21/32	41/64	15-7/8	1.38
J1240ASD-TT	1-1/4	1/2	2-33/64	33/64	1-3/4	45/64	16-7/8	1.89

AS 954 ASME B107.100

SATIN METRIC COMBINATION WRENCHES - 12 POINT



- ▶ Satin finish provides corrosion resistance and a slip-resistant grip.
- ▶ 12 Point box end allows for fine indexing, helping to improve speed and access. Fits 4, 6, and 12 Point fasteners.
- ▶ Anti-Slip Design (ASD) open end.
- ▶ Metric sizes 9 mm and smaller and sizes 36 mm and larger do not have the ASD feature.
- ▶ Box ends incorporate the TorquePlus™ system.



12	MM	Throat Depth (in) (B)	Outside Head Width (in) (C)	Head Thickness (in) (D)	Outside Head Width (in) (C1)	Head Thickness (in) (D1)	Overall Length (in)	Weight (lbs)
J1207MA-TT	7	5/16	19/32	11/64	13/32	15/64	5-5/32	0.06
J1208MA-TT	8	25/64	11/16	3/16	1/2	17/64	5-13/32	0.07
J1210MASD-TT	10	31/64	7/8	7/32	21/32	5/16	5-29/32	0.11
J1212MASD-TT	12	9/16	1	1/4	47/64	11/32	7-45/64	0.18
J1214MASD-TT	14	11/16	1-3/16	9/32	55/64	23/64	8-13/16	0.29
J1216MASD-TT	16	3/4	1-21/64	5/16	15/16	13/32	9-35/64	0.26
J1218MASD-TT	18	55/64	1-33/64	11/32	1-1/16	29/64	10-11/16	0.41
J1220MASD-TT	20	63/64	1-11/16	23/64	1-3/16	31/64	11-27/64	0.55
J1222MASD-TT	22	1-3/64	1-25/32	3/8	1-17/64	1/2	12-17/32	0.62
J1224MASD-TT	24	1-1/8	1-57/64	13/32	1-11/32	35/64	13-5/16	0.77
J1226MASD-TT	26	1-13/64	2-1/64	27/64	1-27/64	19/32	14-41/64	0.97
J1228MASD-TT	28	1-23/64	2-17/64	15/32	1-21/32	41/64	15-35/64	1.37
J1229MASD-TT	29	1-23/64	2-17/64	15/32	1-21/32	41/64	15-55/64	1.39
J1230MASD-TT	30	1-23/64	2-17/64	15/32	1-21/32	41/64	15-55/64	1.41
J1232MASD-TT	32	1-1/2	2-33/64	33/64	1-49/64	45/64	16-59/64	1.82

ASME B107.100



7 PIECE DOUBLE BOX WRENCH SET - 12 POINT

Product #: J1100R-TT

- › Full polish finish provides corrosion resistance and easy to clean surfaces.
- › 12 Point box end allows for fine indexing, helping to improve speed and access. Fits 4, 6, and 12 Point fasteners.
- › Box ends incorporate the TorquePlus™ system.



12

INCH

J1170-TT	5/16 x 3/8
J1171-TT	7/16 x 1/2
J1172-TT	9/16 x 5/8
J1173-TT	11/16 x 3/4
J1174-TT	13/16 x 7/8
J1175-TT	15/16 x 1
J1176-TT	1-1/16 x 1-1/8

Individual components available for purchase.

11 PIECE DOUBLE BOX METRIC WRENCH SET - 12 POINT

Product #: J1100S-M-TT

- › Full polish finish provides corrosion resistance and easy to clean surfaces.
- › 12 Point box end allows for fine indexing, helping to improve speed and access. Fits 4, 6, and 12 Point fasteners.
- › Offset box end allows access to recessed fasteners and keeps hands clear of obstructions.
- › Box ends incorporate the TorquePlus™ system.



12

MM

J1050M-TT	6 x 7
J1051M-TT	8 x 9
J1053M-TT	10 x 11
J1057M-TT	12 x 13
J1061M-TT	14 x 15
J1064M-TT	16 x 18
J1065M-TT	17 x 19
J1072M-TT	21 x 24
J1073M-TT	22 x 24
J1077M-TT	27 x 30
J1079M-TT	30 x 32

Individual components available for purchase.

3 PIECE FLARE NUT WRENCH SET - 6 POINT

Product #: J3760-TT

- › Satin finish provides corrosion resistance and a slip-resistant grip.
- › Flare nut box ends incorporate the TorquePlus™ system.



6

INCH

J3764-TT	3/8 x 7/16
J3768-TT	1/2 x 9/16
J3772-TT	5/8 x 11/16

Individual components available for purchase.

5 PIECE FLARE NUT METRIC WRENCH SET - 6 POINT

Product #: J3700M-TT

- › Satin finish provides corrosion resistance and a slip-resistant grip.
- › Flare nut box ends incorporate the TorquePlus™ system.



6

MM

J3707M-TT	7 x 8
J3709M-TT	9 x 11
J3710M-TT	10 x 12
J3713M-TT	13 x 14
J3715M-TT	15 x 17

Individual components available for purchase.

BLACK CHROME REVERSIBLE COMBINATION RATCHETING WRENCH SETS - SPLINE

- › Black chrome finish is corrosion-resistant and visually distinctive.
- › Spline wrenches can be used on fractional 4, 6, or 12 Point, spline fasteners and Torx® fasteners.
- › Anti-Slip Design (ASD) open end.

9 PIECE BLACK CHROME REVERSIBLE COMBINATION RATCHETING WRENCH SET - SPLINE

Product #: JSCV-9S-TT

- › The chrome-vanadium switch lever allows for easy changes in turning direction which helps improve speed.
- › 15° Angled offset box end helps keep shank clear of obstructions.



INCH

JSCV09-TT	9/32
JSCV10-TT	5/16
JSCV12-TT	3/8
JSCV14-TT	7/16
JSCV16-TT	1/2
JSCV18-TT	9/16
JSCV20-TT	5/8
JSCV22-TT	11/16
JSCV24-TT	3/4

Individual components available for purchase.

13 PIECE BLACK CHROME REVERSIBLE COMBINATION RATCHETING WRENCH SET - SPLINE

Product #: JSCVM-13S-TT

- › The chrome-vanadium switch lever allows for easy changes in turning direction which helps improve speed.
- › 15° Angled offset box end helps keep shank clear of obstructions.
- › Chrome-vanadium box ends and switch levers provide high strength and durability.
- › Box end is countersunk for easy application to the fastener.
- › Spline design was created for use with specialty spline bolts which are used when weight and size of bolt heads must be minimized.
- › Spline design enables the wrench to contact conventional fasteners away from the corners, which help apply force over a large area helping to reduce risk of fastener rounding.
- › Spline design also helps prevent rounding of corners and other fastener damage that could lead to Foreign Object Damage (FOD).
- › The high contact surface area which is away from fastener points enables turning of highly rounded fasteners.



MM

JSCVM07-TT	7
JSCVM08-TT	8
JSCVM09-TT	9
JSCVM10-TT	10
JSCVM11-TT	11
JSCVM12-TT	12
JSCVM13-TT	13
JSCVM14-TT	14
JSCVM15-TT	15
JSCVM16-TT	16
JSCVM17-TT	17
JSCVM18-TT	18
JSCVM19-TT	19

Individual components available for purchase.



9 PIECE BLACK CHROME NON-REVERSIBLE COMBINATION RATCHETING WRENCH SET - SPLINE

Product #: **JSCR-9S-TT**

- › Non-reversing ratcheting wrenches can be flipped over to turn the fastener in the opposite direction.
- › Ratcheting spline box end is countersunk for easy application to the fastener.
- › Spline design was created for use with specialty spline bolts which are used when weight and size of bolt heads must be minimized.
- › Spline design enables the wrench to contact conventional fasteners away from the corners, which help apply force over a large area helping to reduce risk of fastener rounding.
- › Spline design also helps prevent rounding of corners and other fastener damage that could lead to Foreign Object Damage (FOD).
- › The high contact surface area which is away from fastener points enables turning of highly rounded fasteners.



INCH

JSCR08-TT	1/4
JSCR10-TT	5/16
JSCR12-TT	3/8
JSCR14-TT	7/16
JSCR16-TT	1/2
JSCR18-TT	9/16
JSCR20-TT	5/8
JSCR22-TT	11/16
JSCR24-TT	3/4

Individual components available for purchase.

10 PIECE BLACK CHROME METRIC NON-REVERSIBLE COMBINATION RATCHETING WRENCH SET - SPLINE

Product #: **JSCRM-10S-TT**

- › The chrome-vanadium switch lever allows for easy changes in turning direction which helps improve speed.
- › Chrome-vanadium box ends and switch levers provide high strength and durability.
- › Box end is countersunk for easy application to the fastener.
- › Spline design was created for use with specialty spline bolts which are used when weight and size of bolt heads must be minimized.
- › Spline design enables the wrench to contact conventional fasteners away from the corners, which help apply force over a large area helping to reduce risk of fastener rounding.
- › Spline design also helps prevent rounding of corners and other fastener damage that could lead to Foreign Object Damage (FOD).
- › The high contact surface area which is away from fastener points enables turning of highly rounded fasteners.



MM

JSCRM10-TT	10
JSCRM11-TT	11
JSCRM12-TT	12
JSCRM13-TT	13
JSCRM14-TT	14
JSCRM15-TT	15
JSCRM16-TT	16
JSCRM17-TT	17
JSCRM18-TT	18
JSCRM19-TT	19

Individual components available for purchase.

5 PIECE DOUBLE BOX RATCHETING WRENCH SET - 6 & 12 POINT

Product #: J1190A-TT

- › Full polish finish provides corrosion resistance and easy to clean surfaces.
- › Shorter length for access to confined workspaces.
- › The wrench self-aligns with the fastener.
- › 12 Point box end allows for fine indexing.
- › Fits 4, 6, and 12 Point fasteners.



6 12	INCH	Point
J1191T-A-TT	1/4 x 5/16	6
J1192T-A-TT	3/8 x 7/16	6
J1193T-A-TT	1/2 x 9/16	6
J1194-A-TT	5/8 x 11/16	12
J1195-A-TT	3/4 x 7/8	12

Individual components available for purchase.

5 PIECE DOUBLE BOX RATCHETING OFFSET WRENCH SET - 6 & 12 POINT

Product #: J1180A-TT

- › 25° Offset box end helps keep shank clear of obstructions.
- › Shorter length for access to confined workspaces.
- › Reversing switch lever allows for easy changes in turning direction which helps improve speed.
- › Full polish finish on handle provides corrosion resistance and easy to clean surfaces.
- › 6 Point box end allows for large wrench to fastener contact area which helps prevent rounding of the fastener.
- › 12 Point box end allows for fine indexing, helping to improve speed and access.

6 12	INCH	Point
J1181-A-TT	1/4 x 5/16	6
J1182-A-TT	3/8 x 7/16	6
J1183-A-TT	1/2 x 9/16	6
J1184-A-TT	5/8 x 11/16	12
J1185-A-TT	3/4 x 7/8	12

Individual components available for purchase.

5 PIECE DOUBLE BOX RATCHETING METRIC WRENCH SET - 6 & 12 POINT

Product #: J1190MA-TT

- › Full polish finish provides corrosion resistance and easy to clean surfaces.
- › Shorter length for access to confined workspaces.
- › The wrench self-aligns with the fastener.
- › 6 Point box end allows for a large wrench to fastener contact area which helps prevent fastener rounding.
- › 12 Point box end allows for fine indexing.
- › Fits 4, 6, and 12 Point fasteners.

6 12	MM	Point
J1191M-A-TT	7 x 8	6
J1192M-A-TT	9 x 10	6
J1193MA-A-TT	11 x 13	6
J1194MA-A-TT	12 x 14	6
J1195M-A-TT	15 x 17	12

Individual components available for purchase.

7 PIECE DOUBLE BOX RATCHETING METRIC OFFSET WRENCH SET - 6 & 12 POINT

Product #: J1180MA-TT

- › Full polish finish provides corrosion resistance and easy to clean surfaces.
- › 12 Point box end allows for fine indexing, helping to improve speed and access. Fits 4, 6, and 12 Point fasteners.
- › 6 Point box end allows larger wrench to fastener contact area which helps prevent rounding of the fastener.
- › 25° Offset box end helps keep shank clear of obstructions.
- › Reversing switch lever allows for easy changes in turning direction which helps improve speed.



6 12	MM	Point
J1181M-A-TT	7 x 8	6
J1182M-A-TT	9 x 10	6
J1183MA-A-TT	11 x 13	6
J1184MA-A-TT	12 x 14	6
J1185M-A-TT	15 x 17	12
J1186M-A-TT	16 x 18	12
J1187M-A-TT	19 x 21	12

Individual components available for purchase.



3 PIECE CLIK-STOP® ADJUSTABLE WRENCH SET

Product #: J790-TT

- › Clik-Stop® locking design holds the moving jaw of an adjustable wrench in place when the wrench is in use.
- › Satin finish provides corrosion resistance and a slip-resistant grip.
- › Extra wide jaw capacity.
- › Square jaw opening provides strength and tight fit.
- › Included lanyards (JLAN15LBSSRP).

Contents	Max. Opening (in)	Overall Length (in)
J708L-TT	1-1/8	8
J710L-TT	1-5/16	10
J712L-TT	1-1/2	12
J25TR22C	Tool Roll	

Weight (lbs): 3.08

ASME B107.10 0



SATIN CLIK-STOP® ADJUSTABLE WRENCHES

- › Satin finish provides corrosion resistance and a slip-resistant grip.
- › Extra wide jaw capacity.
- › Square jaw opening provides strength and tight fit.
- › Clik-Stop® locking design holds the moving jaw of an adjustable wrench in place when the wrench is in use.
- › Included lanyard (JLAN15LBSSRP).

Product #	Max Opening (in)	Overall Length (in)	Weight (lbs)
J708L-TT	1-1/8	8	0.57
J710L-TT	1-5/16	10	0.95
J712L-TT	1-1/2	12	1.54
J715L-TT	1-11/16	15	3.13
J718L-TT	2-1/16	18	5.73

ASME B107.100



ALUMINUM PIPE WRENCHES

- › Light weight aluminum for less job fatigue.
- › Standard handle lengths with wide gripping surface for increased comfort and one-hand operation.
- › Forged steel jaw provides outstanding strength.
- › Large knurl and power threads provide fast, positive jaw adjustment.
- › Graduation markings on hook jaw show approximate opening for pipe sizes.
- › Riveted jaw pin for safety.
- › Hanging hole for storage.
- › Field repairable by removing the rivet pin located on the bottom side of the jaw.
- › Replacement parts available.
- › Included lanyard (JLAN15LBSSRP).

Product #	Max Opening (in)	Overall Length (in)	Weight (lbs)
J810A-TT	1-1/2	10	1.10
J812A-TT	2	12	1.72
J814A-TT	2	14	2.15
J824A-TT	4	24	5.65

NOTE: For use with Elastic Bungee or Web Lanyard only.



TETHER-READY ADJUSTABLE & PIPE WRENCHES



Each wrench is fitted with the correct weight-rated Proto® Heat Shrink Loop for the size of the wrench. The wrench is secure and remains strong because no holes are bored through the handle.



BLACK OXIDE HEAVY-DUTY OFFSET STRIKING WRENCHES - 12 POINT

- ▶ Black oxide finish.
- ▶ Large striking surface for surer blow contact and more efficient transmittal of force to fastener.
- ▶ Short handle permits use in close quarters.
- ▶ Box opening designed to remain on fastener when wrench is struck.
- ▶ For use where extreme force is necessary to loosen or set large fasteners.
- ▶ Heavy box walls provide greater torque transmission.
- ▶ Offset handle clears obstructions.
- ▶ Non-reflective black oxide finish for use where non-plated products are required.
- ▶ 12 Point box end allows for fine indexing, helping improve speed and access.
- ▶ Fits most 4, 6, and 12 Point fasteners.

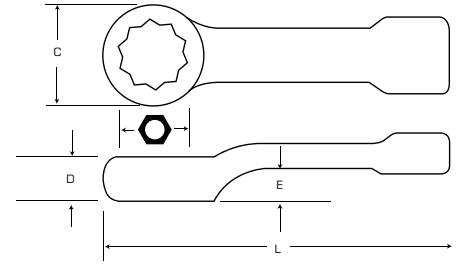

TETHER-READY WRENCHES

12	INCH	MM	Outside Head Width (in) (C)	Head Thickness (in) (D)	Offset Height (in) (E)	Overall Length (in)	Weight (lbs)
J2617SW-TT	1-1/16	27	1-11/16	5/8	15/16	8-1/2	1.84
J2618SW-TT	1-1/8	—	1-11/16	5/8	15/16	11	1.79
J2619SW-TT	1-3/16	30	2-1/16	13/16	13/16	10-3/4	2.55
J2620SW-TT	1-1/4	—	1-7/8	13/16	13/16	10-3/4	2.58
J2621SW-TT	1-5/16	—	1-7/8	13/16	13/16	11-1/2	2.59
J2622SW-TT	1-3/8	35	2-25/64	1	1-1/2	12	3.40
J2623SW-TT	1-7/16	—	2-3/16	1	1-1/2	12	3.29
J2624SW-TT	1-1/2	38	2-3/16	1	1-1/2	12	3.35
J2625SW-TT	1-9/16	—	2-21/32	1-1/8	1-7/16	12-1/4	3.89
J2626SW-TT	1-5/8	—	2-13/32	1-1/8	1-1/2	12-1/4	4.00
J2627SW-TT	1-11/16	43	2-13/32	1-1/8	1-1/2	13-7/16	3.88
J2628SW-TT	1-3/4	—	2-19/32	1-3/16	1-9/16	13-7/16	3.90
J2629SW-TT	1-13/16	—	2-21/32	1-3/16	1-9/16	13-7/16	5.30
J2630SW-TT	1-7/8	—	2-27/32	1-1/4	1-21/32	13-7/16	5.24
J2631SW-TT	1-15/16	—	2-27/32	1-1/4	1-7/8	13-7/16	5.20
J2632SW-TT	2	51	2-27/32	1-1/4	1-21/32	13-7/16	5.16
J2633SW-TT	2-1/16	—	3-1/8	1-1/4	2	13-1/2	6.82
J2634SW-TT	2-1/8	54	3-1/8	1-1/2	2	13-7/8	6.71
J2635SW-TT	2-3/16	—	3-3/8	1-1/2	2	13-1/2	6.78
J2636SW-TT	2-1/4	57	3-3/8	1-1/2	2	13-1/2	6.30
J2637SW-TT	2-5/16	—	3-3/8	1-1/2	2	13-1/2	7.94
J2638SW-TT	2-3/8	—	3-3/8	1-1/2	2	13-1/2	7.86

NOTE: For use with Elastic Bungee or Web Lanyard only.

12	MM	Outside Head Width (in) (C)	Head Thickness (in) (D)	Offset Height (in) (E)	Overall Length (in)	Weight (lbs)
J2632SWM-TT	32	1-57/64	53/64	1-3/16	10-3/4	0.88
J2636SWM-TT	36	2-13/64	63/64	1-1/2	12-1/64	2.13
J2641SWM-TT	41	2-13/32	1-7/64	1-1/2	12-1/4	2.37
J2646SWM-TT	46	2-43/64	1-3/16	1-37/64	13-27/64	2.81
J2650SWM-TT	50	2-53/64	1-17/64	1-21/32	13-27/64	6.36
J2655SWM-TT	55	3-25/64	1-1/2	2-1/64	13-1/2	6.58
J2660SWM-TT	60	3-25/64	1-1/2	2-1/64	13-1/2	9.19
J2665SWM-TT	65	4-1/64	1-1/2	2-1/4	13-1/2	12.61
J2670SWM-TT	70	4-1/64	1-1/2	2-1/4	13-1/2	12.11
J2675SWM-TT	75	4-29/64	1-57/64	2-41/64	15-63/64	13.53
J2680SWM-TT	80	4-29/64	1-57/64	2-41/64	15-63/64	13.16

NOTE: For use with Elastic Bungee or Web Lanyard only.



STRIKING & STRUCK

Striking tools require strength and durability during impact. Proto® Tether Attachment Points will secure a striking tool without holes or welds that weaken or unbalance properly-made equipment.



The molded textured rubber grip provides a slip-resistance grip and increased control.

Patented Anti-Vibe® technology delivers greater vibration dampening effect than traditional one-piece steel hammers.

Proto® specifically positions the Heat Shrink Tether Loop to maximize the range of natural motion during tool use.



ANTI-VIBE® STEEL BALL PEIN HAMMERS

- Well-balanced professional hammer with hardened drop-forged head bonded to strong, lightweight fiberglass handle.
- Exclusive Rim-Tempered™ process minimizes chipping from off-center strikes.
- Molded jacket over the fiberglass handle provides maximum overstrike protection.

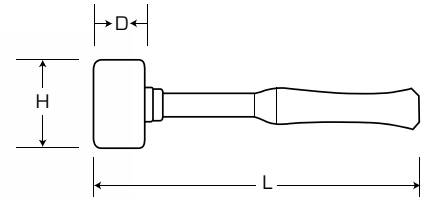

Product #	Head Weight (oz)	Overall Length (in) (L)	Weight (lbs)
J1316AVP-TT	16	12-7/8	1.54
J1324AVP-TT	24	13-25/32	2.18
J1332AVP-TT	32	14-3/4	2.62

ASME B107.400

BRASS HAMMERS

- Mar-resistant soft brass head helps absorb impact and helps reduce work damage.
- Spark-resistant for safe use near combustible materials.
- Fiberglass handle with ergonomic, non-slip grip.

PROP 65 WARNING: Handling the brass material on this product exposes you to lead, a chemical known to the State of California to cause cancer and birth defects or other reproductive harm. Wash hands after use.



Product #	Head Weight (lbs)	Face Diameter (in) (D)	Head Length (in) (H)	Overall Length (in) (L)	Weight (lbs)
J14326-TT	2.60	1-3/4	3-1/2	13-3/4	3.45
J14316-TT	3.80	2	3-5/8	14-3/4	4.38

DEAD BLOW COMPO-CAST® COMBO FACE HAMMERS

- Top welded handle-to-head assembly adds extra durability and safety.
- Hot urethane Uni-Cast construction outlasts all other soft face striking tools. Urethane composition provides shape-retaining faces even after repeated striking on hard surfaces and sharp edges.
- Handle is reinforced with solid steel shaft for greater strength safety.
- Top of head molded with a flat surface.
- Dual head design (Standard Dead Blow and Slim-line heads).
- Comfortable dual molded grip.



Top of head molded with flat surface.

Dual head design (Standard dead blow and slim-line heads).

Double flange butt handle.



Product #	Head Weight (oz)	Face Diameter (in) (D)	Head Length (in) (H)	Overall Length (in) (L)	Weight (lbs)
J57-530-TT	15	1 x 1-1/4	3-47/64	10-13/32	0.90
J57-531-TT	21	1-1/4 x 1-35/64	4-17/32	11-21/32	1.40
J57-532-TT	28	1-11/32 x 1-45/64	5-9/64	13-1/4	1.80
J57-533-TT	48	1-45/64 x 2-3/32	5-51/64	14-1/4	2.95
J57-534-TT	56	1-61/64 x 2-13/32	6-13/64	15-61/64	3.70

5 PIECE COLD CHISEL SET

Product #: J86CS2-TT

- ▶ Made from S2 steel and specially heat-treated for greater strength and durability.
- ▶ Modified parabolic striking end to help reduce mushrooming and chipping.
- ▶ Hand ground cutting edge to the exact angle for cutting through tough metals.
- ▶ Black oxide finish to help prevent rust corrosion, extending tool life and performance.
- ▶ A polished identification panel on one of the flats is marked with the tool number and size in a black inlay.
- ▶ Set offers a wide range of sizes to handle a variety of jobs.
- ▶ Includes a pouch for convenient storage solution.

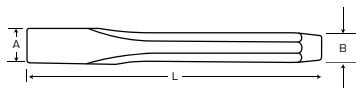

Contents	Description	Tip Width (in) (A)	Shank Width (in) (B)	Overall Length (in) (L)
J86A1/2S2-TT	5/8" Cold Chisel	5/8	1/2	6-3/4
J86A1/4S2-TT	5/16" Cold Chisel	5/16	1/4	5-1/8
J86A3/8S2-TT	7/16" Cold Chisel	7/16	3/8	5-9/16
J86A5/16S2-TT	3/8" Cold Chisel	3/8	5/16	5-9/16
J86A7/16S2-TT	1/2" Cold Chisel	1/2	7/16	6
J25TR15C	Pouch			

Weight (lbs): 1.17

Individual components available for purchase.

7 PIECE PIN PUNCH SET

Product #: J47A-TT

- ▶ Made from S2 steel and specially heat-treated for greater strength and durability.
- ▶ Two-piece design allows the tip to be hard for durability while allowing it to be produced straight to help prevent binding.
- ▶ Modified parabolic striking end to help reduce mushrooming and chipping.
- ▶ Black oxide finish to help prevent rust corrosion, extending tool life and performance.
- ▶ A polished identification panel on one of the flats is marked with the tool number and size in a black inlay.
- ▶ Set offers a wide range of sizes to handle a variety of jobs.
- ▶ Includes a pouch for convenient storage solution.

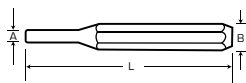

Contents	Description	Tip Width (in) (A)	Shank Width (in) (B)	Overall Length (in) (L)
J471-4X1-16-TT	1/16" Punch Pin	1/16	1/4	4-3/8
J471-4X3-32-TT	3/32" Pin Punch	3/32	1/4	4-3/4
J475-16X1-8-TT	1/8" Pin Punch	1/8	5/16	5-3/16
J475-16X5-32TT	5/32" Pin Punch	5/32	5/16	5-9/16
J473-8X3-16-TT	3/16" Pin Punch	3/16	3/8	5-7/8
J477-16X7-32TT	7/32" Pin Punch	7/32	3/8	6-3/8
J471-2X1-4-TT	1/4" Pin Punch	1/4	3/8	6-3/4
J25TR31C	Pouch			

Weight (lbs): 1.15

Individual components available for purchase.

ASME B107.410



4 PIECE LARGE HANDLE PRY BAR SET

Product #: J2156S-TT

- › Impact-resistant, extruded Acetate handles are four-sided with broad but shallow flutes.
- › Resistant to most harsh chemicals (including hydraulic fluids used in the aerospace industry).
- › Four-sided handle design helps prevent "roll away" from the work surface and is comfortable and easy to hold.
- › High alloy steel shanks are heat-treated their entire length and black oxide treated for added strength and durability.



Contents	Size (in)
J2140-TT	14
J2142-TT	18
J2146-TT	28
J2148-TT	32

Individual components available for purchase.

PUNCH & CHISEL HOLDER

- › Holds punches and chisels up to one inch in diameter reducing the risk of injury.
- › Nylon insert absorbs shock.
- › Large four-sided handle.

Product #	Overall Length (in) (L)	Weight (lbs)
J2108-TT	8	0.60

4 PIECE PRY & ROLLING HEAD BARS SET

Product #: J2100-TT

- › Set includes rolling head and aligning bars.
- › Black oxide finish to help prevent rust corrosion; extending tool life and performance.



Contents	Size (in)	Type
J2120-TT	18	Aligning
J2124-TT	24	Aligning
J2126-TT	12	Rolling Head
J2130-TT	16	Rolling Head

Individual components available for purchase.



TETHER-READY PLIERS

All Proto® Tethered Pliers integrate a Tether Attachment Point in the handle that sits in the heel of your hand. When the pliers open, the lanyard remains stationary in the hand and promotes a more natural use of the pliers.



XL SERIES PLIERS

- › Exclusive Flush Fastener provides better access with increased user adjustability making it 30% narrower.
- › Flush Fastener allows pliers to lay flat in the work place and prevents snagging on tool belts/pouches.
- › Flush Fastener is a nut and bolt assembly and can easily be adjusted by the end user in the field.





XL SERIES TONGUE & GROOVE

- › Jaws are milled with deep self-gripping pipe wrench style teeth for maximum bite.
- › Accurately machined undercut tongue and groove points for precision movement and joint strength.



Product #	Description	Overall Length (in)	Jaw Thickness (in)	Jaw Width (in)	Jaw Length (in)	Weight (lbs)
J261SGXL-TT	Groove Joint Pliers w/Grip - 5"	5	15/64	3/4	31/32	0.15
J262SGXL-TT	Groove Joint Pliers w/Grip - 7"	7	3/8	1-19/64	1-43/64	0.5
J260SGXL-TT	Groove Joint Pliers w/Grip - 10"	10	27/64	1-19/32	2-3/32	0.94
J264SGXL-TT	Groove Joint Pliers w/Grip - 12"	12	33/64	2-1/2	2-45/64	1.95
J265SGXL-TT	Groove Joint Pliers w/Grip - 16"	16	33/64	3-3/32	3	2.6

XL SERIES COMBINATION SLIP-JOINT

- › Jaws are milled with deep, sharp, lobster claw design that give two gripping areas with each position.
- › Combination pliers have shear type cutters.
- › Non-gripped versions are complemented with deep, strong, drop-forged knurled impressions making it non-slip. The impressions can also be used to file off a burr when on the go!



Product #	Description	Overall Length (in)	Jaw Thickness (in)	Jaw Width (in)	Jaw Length (in)	Weight (lbs)
J2766XL-TT	Slip-Joint Pliers w/Grip - 6"	6-1/2	13/32	1-1/4	1-27/32	0.5
J2766XL-TT	Slip-Joint Pliers w/Natural Finish - 6"	6-1/2	13/32	1-1/4	1-27/32	0.45
J2786XL-TT	Slip-Joint Pliers w/Grip - 8"	8	13/32	1-5/16	2-3/32	0.64
J278XL-TT	Slip-Joint Pliers w/Natural Finish - 8"	8	13/32	1-5/16	2-3/32	0.6
J2806XL-TT	Slip-Joint Pliers w/Grip - 10"	10	31/64	1-13/32	2-11/64	0.9
J2800XL-TT	Slip-Joint Pliers w/Natural Finish - 10"	10	31/64	1-13/32	2-11/64	0.9



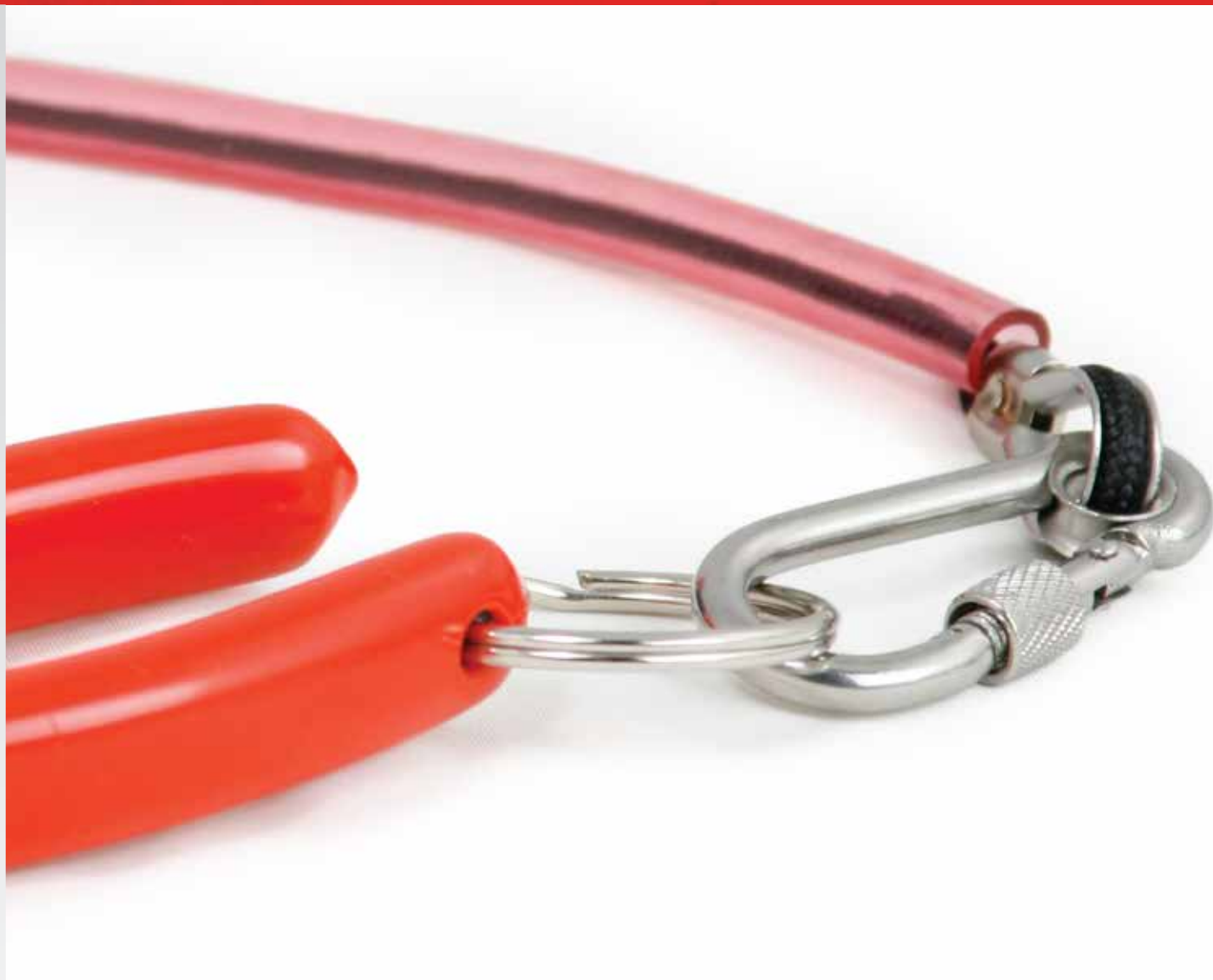

SOFT JAW - CANNON PLUG PLIERS

- › Capacity of 3/4" to 2-1/2".
- › Four-position pivot design provides greater concentricity.
- › Replaceable urethane padded jaws protect work piece from marking or scratching.
- › Plastisol grips for added comfort.

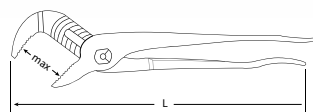
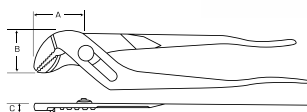

Product #	Overall Length (in) (L)	Max. Opening (in)	Replacement Item	Weight (lbs)
J253G-TT	9-1/2	3/4 - 2-1/2	J253GRK	0.54



STRAIGHT JAW LOCKING PLIERS

- › Heavy-duty nose.
- › Reinforced precisely machined teeth.
- › Strong, tough tool.
- › Helps provide secure grip for extra tough jobs.
- › General purpose for various maintenance situations.
- › Locking nut to hold adjustment during repetitive jobs.



Product #	Overall Length (in) (L)	Jaw Length (in) (A)	Jaw Width (in) (B)	Weight (lbs)
J293XL-TT	9-1/4	1-19/32	5/8	1.39

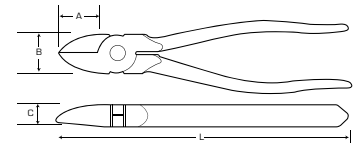

SAFETY WIRE TWISTER PLIERS - REVERSIBLE

- › Reversible safety wire pliers provide right and left twist capability often eliminating the need for a second plier.
- › Meets SAE Aerospace Standard AS 567 Twister Requirements.
- › Provides all of the features of standard Proto® Safety Wire Pliers.
- › J196 designed for wire sizes .020" - .041".
- › J197 designed for wire sizes .020" - .060".
- › J198 designed for wire sizes .020" - 0.60".



Product #	Overall Length (in) (L)	Weight (lbs)
J196-TT	8-3/4	0.64

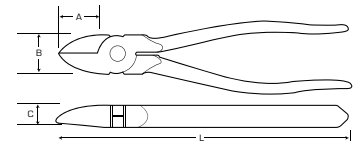

WIRE STRIPPER - CRIMPER

- › Strips 10-22 AWG (American Wire Gauge).
- › Box style crimp.
- › Crimps insulated and non-insulated terminals for 10-22 AWG.
- › Crimps non-insulated 7 mm and 8 mm auto ignition wire.
- › Cuts screw/bolt sizes 4-40, 5-40, 6-32, 8-32, 10-32, 10-24.
- › Anvil type wire cutter for cutting copper wire.
- › Air-pocket cushion grips for comfort.



Product #	Overall Length (in) (L)	Weight (lbs)
J299-TT	8-1/2	0.45

SCREWDRIVERS & HEX KEYS

Proto® Tethered Hex Keys and Screwdrivers feature tool collars that tightly attach to the bar of the tool. Each collar is specifically sized for a tight compression fit on the diameter of the bar.

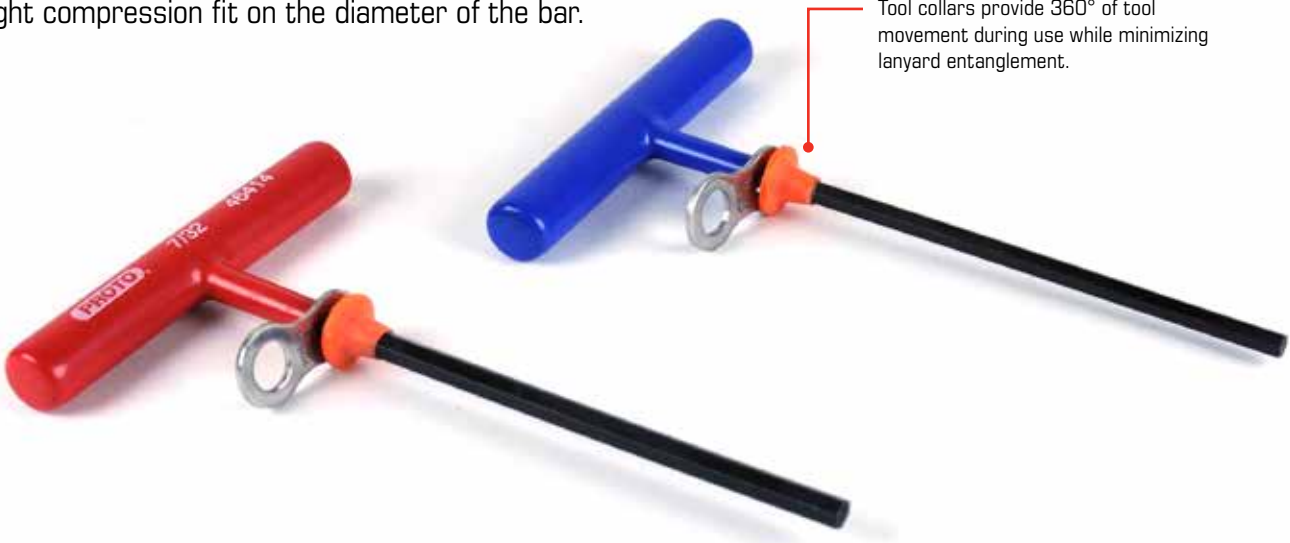

11 PIECE T-HANDLE HEX KEY SET

Product #: J4968-TT



HEX	INCH	Handle Length (in)	Length (in)	Weight (lbs)
J46405-TT	5/64	3	6	0.11
J46406-TT	3/32	3	6	0.11
J46407-TT	7/64	3	6	0.11
J46408-TT	1/8	3	6	0.14
J46409-TT	9/64	3	6	0.14
J46410-TT	5/32	3	6	0.32
J46412-TT	3/16	4	6	0.32
J46414-TT	7/32	4	6	0.63
J46416-TT	1/4	4	6	0.82
J46420-TT	5/16	6	6	0.89
J46424-TT	3/8	6	6	0.90

Weight (lbs): 3.98

6 PIECE METRIC T-HANDLE HEX KEY SET

Product #: J4969-TT



HEX	MM	Handle Length (in)	Length (in)	Weight (lbs)
J46508-TT	2	3	6	0.11
J46510-TT	2.5	3	6	0.13
J46512-TT	3	3	6	0.13
J46514-TT	4	3	6	0.14
J46516-TT	5	4	6	0.32
J46518-TT	6	4	6	0.62

Weight (lbs): 1.00



T-HANDLE HEX KEYS



HEX	INCH	Handle Length (in)	Length (in)	Weight (lbs)
J46405-TT	5/64	3	6	0.11
J46406-TT	3/32	3	6	0.11
J46407-TT	7/64	3	6	0.11
J46408-TT	1/8	3	6	0.14
J46409-TT	9/64	3	6	0.14
J46410-TT	5/32	3	6	0.32
J46412-TT	3/16	4	6	0.32
J46414-TT	7/32	4	6	0.63
J46416-TT	1/4	4	6	0.82
J46420-TT	5/16	6	6	0.89
J46424-TT	3/8	6	6	0.90

T-HANDLE HEX KEYS METRIC



HEX	MM	Handle Length (in)	Length (in)	Weight (lbs)
J46508-TT	2	3	6	0.11
J46510-TT	2.5	3	6	0.13
J46512-TT	3	3	6	0.13
J46514-TT	4	3	6	0.14
J46516-TT	5	4	6	0.32
J46518-TT	6	4	6	0.62

TETHER-READY T-HANDLE & FOLDING HEX KEYS

6 PIECE METRIC LONG FOLDING HEX KEY SET

Product #: J4973-TT

- › Chrome plated steel case is 6-1/2" long.
- › Black oxide bits are 5" long.



MM	Length (in)
3	5
4	5
5	5
6	5
8	5
10	5

Weight (lbs): 0.84

9 PIECE FOLDING HEX KEY SET

Product #: J4993-TT

- › Chrome plated steel case is 4-1/2" long.
- › Black oxide bits are 1-7/16" to 2-3/4" long.



INCH	Set Screws	Fits Cap Screws 1960 Series	Cap Screws 1936 Series
5/64	#8	#2, #3	#3, #4
3/32	#10, #12	#4, #5	#5, #6
7/64	—	#6	—
1/8	1/4	—	#8
9/64	—	#8	—
5/32	5/16	#10	#10
3/16	3/8	1/4	1/4
7/32	7/16	—	5/16
1/4	1/2, 9/16	5/16	—

Weight (lbs): 0.47



PROTO® DURATEK™ SCREWDRIVERS



FEATURES AND BENEFITS — DURATEK™ SCREWDRIVERS

- › Ergonomically designed quad-lobe handle features 360° texture for additional grip.
- › Designed to meet demanding heavy-duty needs of industrial maintenance and assembly applications.

HANDLE

- › Impact and chemical resistant handles are four-sided with broad but shallow flutes.
- › Resistant to most harsh chemicals (including hydraulic fluids used in the aerospace industry).
- › Four-sided handle design helps prevent "roll away" from the work surface.

SHANK

- › High-alloy steel shanks are heat-treated their entire length to help provide strength against twisting action and to help prevent bending and twisting when placed under torque.
- › Fully grounded and chemically polished, then chrome plated for corrosion resistance.

TIP

- › Made of high-alloy steel (same as shank).
- › Precision machined for precise fastener fit.
- › Finished in black oxide to help prevent cam out and slipping.
- › Tips are un-plated with a black oxide finish to help prevent chrome peeling, an important Foreign Object Debris (FOD) concern.

Product #	Tip Size	Tips	Shank Length (in) (L1)	Shank Type	Bolster	Overall Length (in) (L)
JC31604R-TT	3/16	Cabinet	4	Round	—	7
JK14112R-TT	1/4	Keystone	1-1/2	Round	—	3-1/2
JK1404R-TT	1/4	Keystone	4	Round	—	8
JK51606R-TT	5/16	Keystone	6	Round	—	10-3/8
JK3808R-TT	3/8	Keystone	8	Round	—	13
JK3810R-TT	3/8	Keystone	10	Round	—	11
JPP0003R-TT	0	Phillips	3	Round	—	5-3/4
JP0103R-TT	1	Phillips	3	Round	—	6-3/4
JP02112R-TT	2	Phillips	1-1/2	Round	—	3-1/2
JP0204R-TT	2	Phillips	4	Round	—	8
JP0306R-TT	3	Phillips	6	Round	—	10-3/8
JP0408R-TT	4	Phillips	8	Round	—	13

ASME B107.600



6 PIECE PHILLIPS PROTO® DURATEK™ SCREWDRIVER SET

Product #: J1206SP-TT

› Duratek™ features apply.



Contents	Description	Tip Size	Tips	Shank Length (in) (L1)	Shank Type	Overall Length (in)
JPP0003R-TT	Screwdriver, Phillips Round #0 x 3"	0	Phillips	3	Round	5-3/4
JPO103R-TT	Screwdriver, Phillips Round #1 x 3"	1	Phillips	3	Round	6-3/4
JPO2112R-TT	Screwdriver, Phillips Round, Stubby #2 x 1-1/2"	2	Phillips	1-1/2	Round	3-1/2
JPO204R-TT	Screwdriver, Phillips Round #2 x 4"	2	Phillips	4	Round	8
JPO306R-TT	Screwdriver, Phillips Round #3 x 6"	3	Phillips	6	Round	10-3/8
JPO408R-TT	Screwdriver, Phillips Round #4 x 8"	4	Phillips	8	Round	13

ASME B107.600

6 PIECE SLOTTED PROTO® DURATEK™ SCREWDRIVER SET

Product #: J1206SSF-TT

› Duratek™ features apply.



Contents	Description	Tip Size	Tips	Shank Length (in) (L1)	Shank Type	Overall Length (in)
JC31604R-TT	Screwdriver, Slotted Keystone, Round 3/16" x 4"	3/16	Keystone	4	Round	7
JK14112R-TT	Screwdriver, Slotted Keystone, Round, Stubby 1/4" x 1-1/2"	1/4	Keystone	1-1/2	Round	3-1/2
JK1404R-TT	Screwdriver, Slotted Keystone, Round 1/4" x 4"	1/4	Keystone	4	Round	8
JK51606R-TT	Screwdriver, Slotted Keystone, Round 5/16" x 6"	5/16	Keystone	6	Round	10
JK3808R-TT	Screwdriver, Slotted Keystone, Round 3/8" x 8"	3/8	Keystone	8	Round	13
JK3810R-TT	Screwdriver, Slotted Keystone, Round 3/8" x 12"	3/8	Keystone	12	Round	17

ASME B107.600



SPECIALTY TOOLS

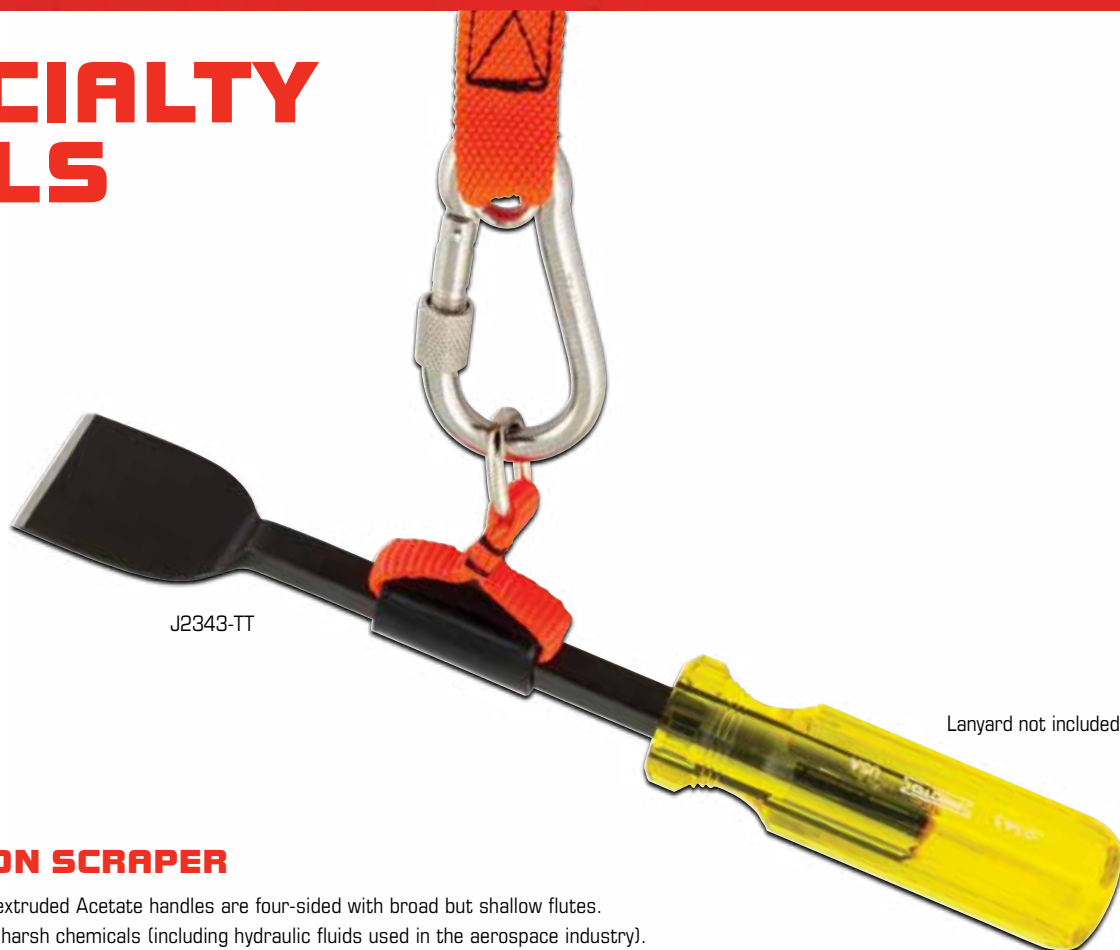

J2343-TT

Lanyard not included

1-1/2" CARBON SCRAPER

- › Impact-resistant, extruded Acetate handles are four-sided with broad but shallow flutes.
- › Resistant to most harsh chemicals (including hydraulic fluids used in the aerospace industry).
- › Four-sided handle design helps prevent "roll away" from the work surface and are comfortable and easy to hold.
- › High alloy steel 3/8" shanks are heat-treated their entire length and black oxide treated for added strength and durability.

Product #	Shank Diameter (in)	Blade Width (in)	Shank Length (in)	Overall Length (in)	Weight (lbs)
J2343-TT	3/8	1-1/2	6-1/4	10-3/8	0.50

STANLEY® WRECKING BARS

- › Forged one-piece steel construction for increased strength and durability.
- › Yellow powder coated claw end for high visibility.
- › Beveled chisel end for prying.
- › Nail slot on claw end with beveled edge for pulling nails and prying.
- › Both chisel and claw end are polished.

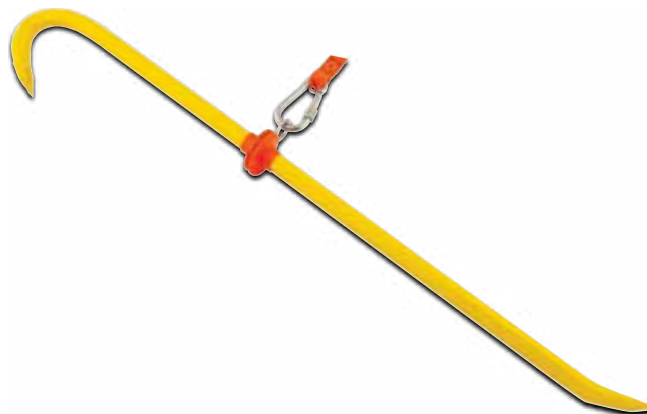

Product #	Overall Length	Claw Blade Width	Claw Blade Width	Weight	Color
55-130-TT	30 in (760 mm)	1-1/4 in (32 mm)	1 in (25 mm)	4.5 lbs (2.04 kg)	Yellow



HEAVY-DUTY PISTOL GRIP GREASE GUN

- › 3-Way filling: bulk, cartridge, or filler pump.
- › 16 oz. Bulk fill.
- › 14 oz. Standard cartridge.
- › Heavy-duty 1.7 mm thick seamless barrel to avoid dents.
- › Aluminum head reduces weight.
- › Heavy-duty flexible 18" nylon hose and 6" metal spout for easy use.
- › Output pressure: 3,600 PSI.



Product #	Overall Length (in)	Weight (lbs)
JFC33HD-TT	16	3.86

STANLEY® FATMAX® TETHER-READY AUTO-LOCK TAPE RULES

- › Auto-Lock Mode: For control and long blade life.
- › Manual Mode: Disengage lock for speed marking.
- › Detachable Hook: Allows user to work efficiently in different conditions.
- › 11' Blade Standout*: For reach and efficiency.
- › BladeArmor®: 10X** blade life.
- › Hook Storage: Securely stores hook when not in use.
- › Through-hole for attaching a tool lanyard when working at heights.



Lanyard not included

Product #	Blade Width (in)	Blade Length (ft)
FMHT33316	1-1/4	16
FMHT33338L	1-1/4	25
FMHT33348	1-1/4	30

*Standout claims based on maximum performance
**Compared to STANLEY 30-419

STANLEY® HIGH TENSION LOW PROFILE HACKSAW

- › Arc-shaped frame enables cutting in hard-to-reach areas.
- › 4" Throat depth cuts large PVC pipes.
- › Heavy-duty, lightweight, die-cast aluminum I-beam frame provides strength and durability.
- › Ergonomically designed handle for comfortable use.
- › Tension knob makes blade tension adjustment easy.
- › 45° and 90° Cutting angles add flexibility.
- › Hacksaw blade included (15-631): 1.
- › Included lanyard (JLAN15LBSSRP).



Product #	Blade Length	Throat Depth
20-001K-TT	12 in (305 mm)	4 in (102 mm)

STANLEY® SELF-RETRACTING SAFETY BLADE UTILITY KNIFE

- › Durable, all-metal knife body construction.
- › Machine screw firmly holds knife body together - Screwdriver required for blade change.
- › Contoured handle and textured, die-cast body for slip-resistance.
- › Interlocking nose design helps secure blade and helps prevent body separation.
- › Comes with hang-hole for adding a wrist strap or lanyard.
- › Auto-retracting blade: spring-loaded. Retracts when slide button is released.
- › Blades included (11-987): 1.
- › Works with most standard utility blades.



Auto Retracting
Blade Feature.



Interlocking
Nose Feature.

Product #	Length	Body Color
10-189C-TT	5-7/8 in (149 mm)	Orange

DEWALT® HEAT GUN

- › Variable temperature control allows for adjustment of the heat settings.
- › Built-in overload protection shuts the heating element down and prevents burn up.
- › Built-in hang ring adds a convenient storage feature.
- › Built-in innovative kickstand support provides greater stability and prevents tip over.
- › Cord Protector keeps the cord from tearing away from the housing.
- › Ergonomic comfort grip provides greater comfort for long hours of use.
- › Separate Internal Components allows maintenance on both the motor and the heating element.
- › Temperature: 120 to 1100 °F.



Product #	Voltage	Amps	Watts	Cord Length (ft)	Weight (lbs)
D26950	120	13	1550	10	2.10

DISTRIBUTED BY:

志發
CHEE FATT

W: www.cheefatt.com
E: marketing@cheefatt.com
T: +65 6294 2066